

Approved 4/17/18

Whitney Thompson

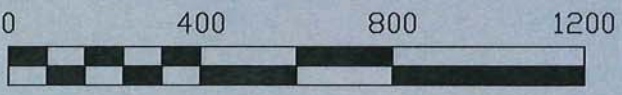

GRAPHIC SCALE IN FEET

NOTE: IMAGERY TAKEN FROM USING GOOGLE EARTH PRO, DATED 1/24/2015.



NOTE: STATION -0+07 = BEGIN GEOTEXTILE/ANCHOR TUBE REMOVAL AND DIKE DEGRADATION.
STATION 46+13 = END GEOTEXTILE/ANCHOR TUBE REMOVAL AND DIKE DEGRADATION.

**RACCOON ISLAND MAINTENANCE/
CONSTRUCTION FEATURE REMOVAL PROJECT
TERREBONNE PARISH, LOUISIANA**
COVER SHEET
SCALE: 1"=400'

SURVEYED BY:
FRANCIS FORTIER, P.L.S. 4769
3091 HIGHWAY 104
OPELOUSAS, LOUISIANA 70570
PHONE: (337) 278-7204

7	ADDED LOCATION OF REMOVED WEIR ON SHT 1, AND WEIR STATION ON SHEET 8.	GPS	FAF	04/09/18
6	ADDED NOTE ON NOTE TO PROFILE AT STA -0+07 ON SHT 5 AND ADDED NOTE TO PROFILE AT STA 46+13 ON SHT 8.	GPS	FAF	04/02/18
5	ADDED NOTE ON SHT 1 AND ADDED AS BUILT INFO ON SHT 8 TO PROFILE ON STATIONS 43+50 THRU 46+40	GPS	FAF	03/22/18
4	ADDED AS BUILT INFO, SHTS 5 OF 8 THRU 8 OF 8	GPS	FAF	03/14/18
3	ADDED AS BUILT INFO, SHTS 1 OF 8 THRU 4 OF 8	GPS	FAF	02/19/18
2	ADDED TOP OF FABRIC POINTS & STATIONING ADDED (4) SHTS TO DWG SET & RENUMBERED ALL PREVIOUS DWGS ISSUED	GPS	FAF	02/05/18
1	ADDED GEOTUBE POINTS	GPS	FAF	01/30/18
0	INITIAL	GPS	FAF	01/19/18
REV	ISSUE	DWN	APP	DATE

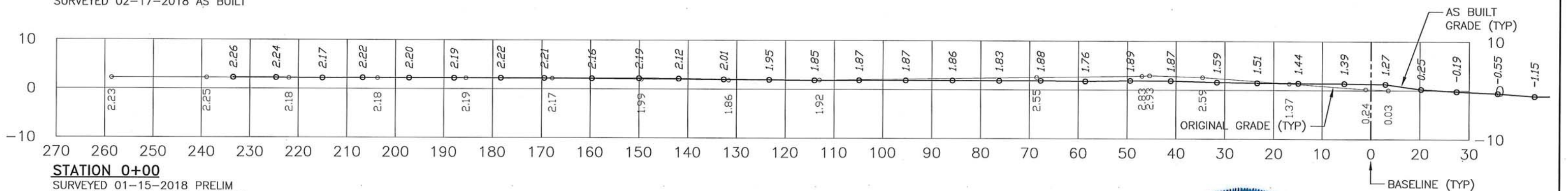
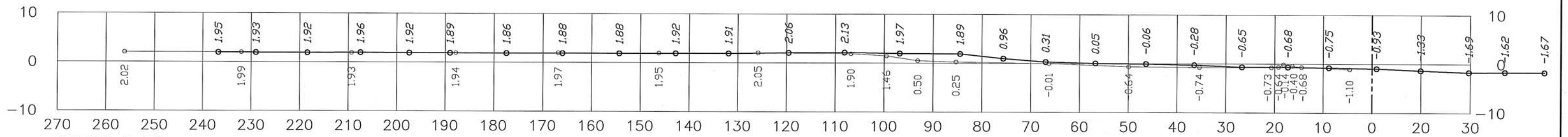
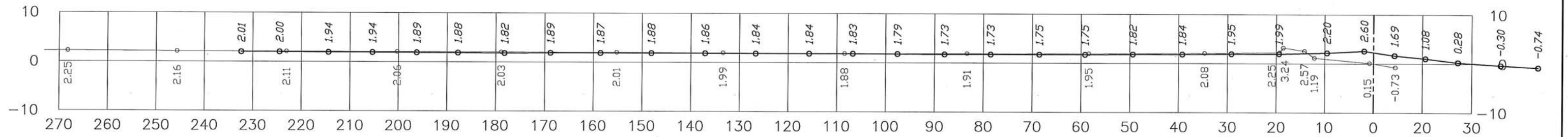
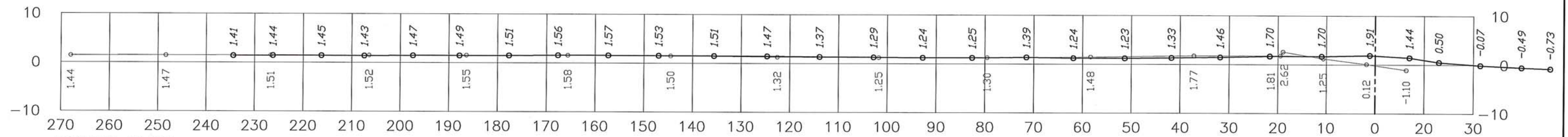

**RACCOON ISLAND MAINTENANCE/
 CONSTRUCTION FEATURE REMOVAL PROJECT
 TERREBONNE PARISH, LOUISIANA**
 CROSS SECTIONS
 SCALE: VERT 1"=20', HORIZ 1"=20'

SURVEYED BY:
 FRANCIS FORTIER, P.L.S. 4769
 3091 HIGHWAY 104
 OPELOUSAS, LOUISIANA 70570
 PHONE: (337) 278-7204



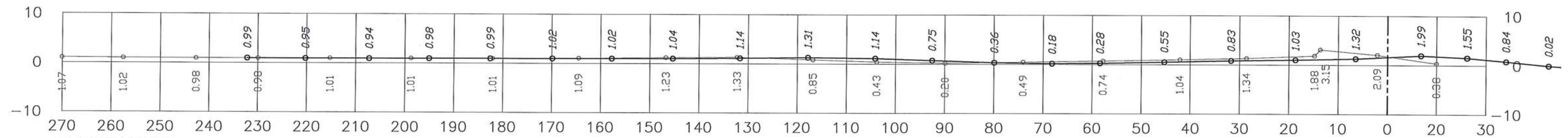

STATION 35+00
 SURVEYED 01-15-2018 PRELIM
 SURVEYED 02-17-2018 AS BUILT

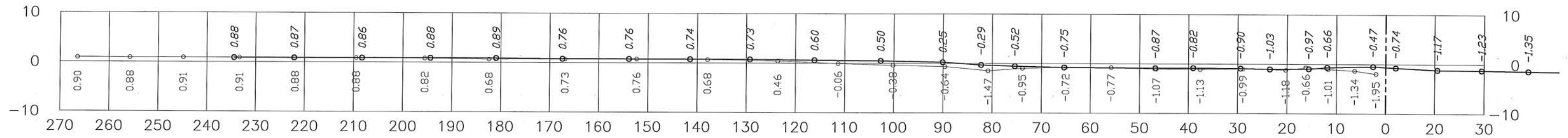

STATION 30+00
 SURVEYED 01-15-2018 PRELIM
 SURVEYED 02-17-2018 AS BUILT

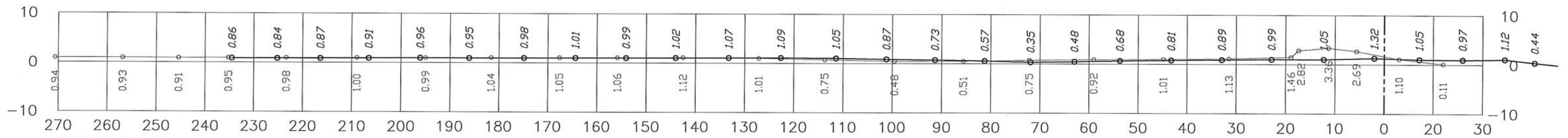

STATION 25+00
 SURVEYED 01-15-2018 PRELIM
 SURVEYED 02-17-2018 AS BUILT

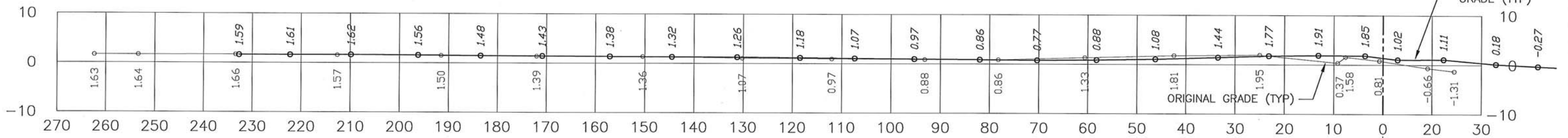

STATION 20+00
 SURVEYED 01-15-2018 PRELIM
 SURVEYED 02-17-2018 AS BUILT

**RACCOON ISLAND MAINTENANCE/
 CONSTRUCTION FEATURE REMOVAL PROJECT
 TERREBONNE PARISH, LOUISIANA**
 CROSS SECTIONS
 SCALE: VERT 1"=20', HORIZ 1"=20'

SURVEYED BY:
 FRANCIS FORTIER, P.L.S. 4769
 3091 HIGHWAY 104
 OPELOUSAS, LOUISIANA 70570
 PHONE: (337) 278-7204



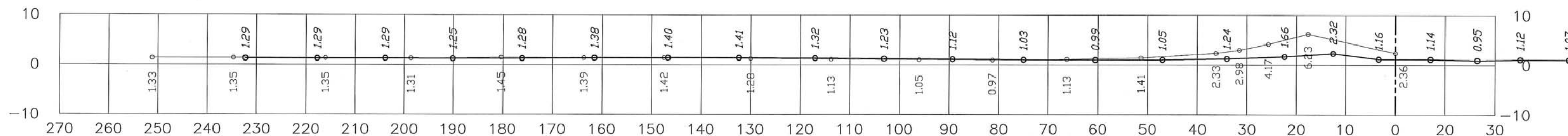

STATION 41+71
 SURVEYED 01-15-2018 PRELIM
 SURVEYED 02-17-2018 AS BUILT

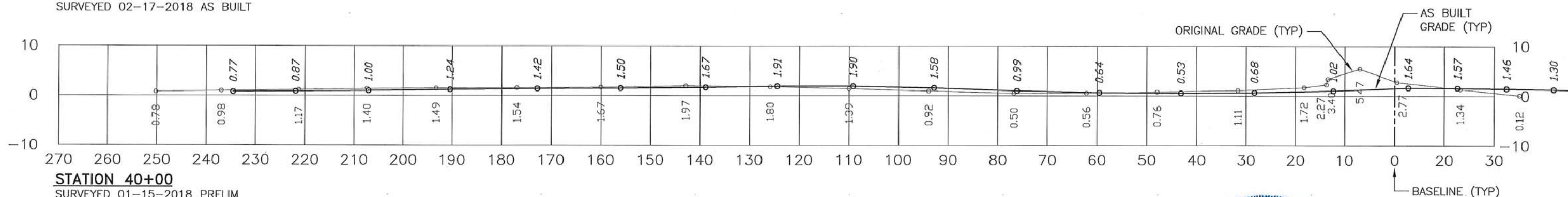

STATION 40+00
 SURVEYED 01-15-2018 PRELIM
 SURVEYED 02-17-2018 AS BUILT

**RACCOON ISLAND MAINTENANCE/
 CONSTRUCTION FEATURE REMOVAL PROJECT
 TERREBONNE PARISH, LOUISIANA
 CROSS SECTIONS
 SCALE: VERT 1"=20', HORIZ 1"=20'**

SURVEYED BY:
 FRANCIS FORTIER, P.L.S. 4769
 3091 HIGHWAY 104
 OPELOUSAS, LOUISIANA 70570
 PHONE: (337) 278-7204



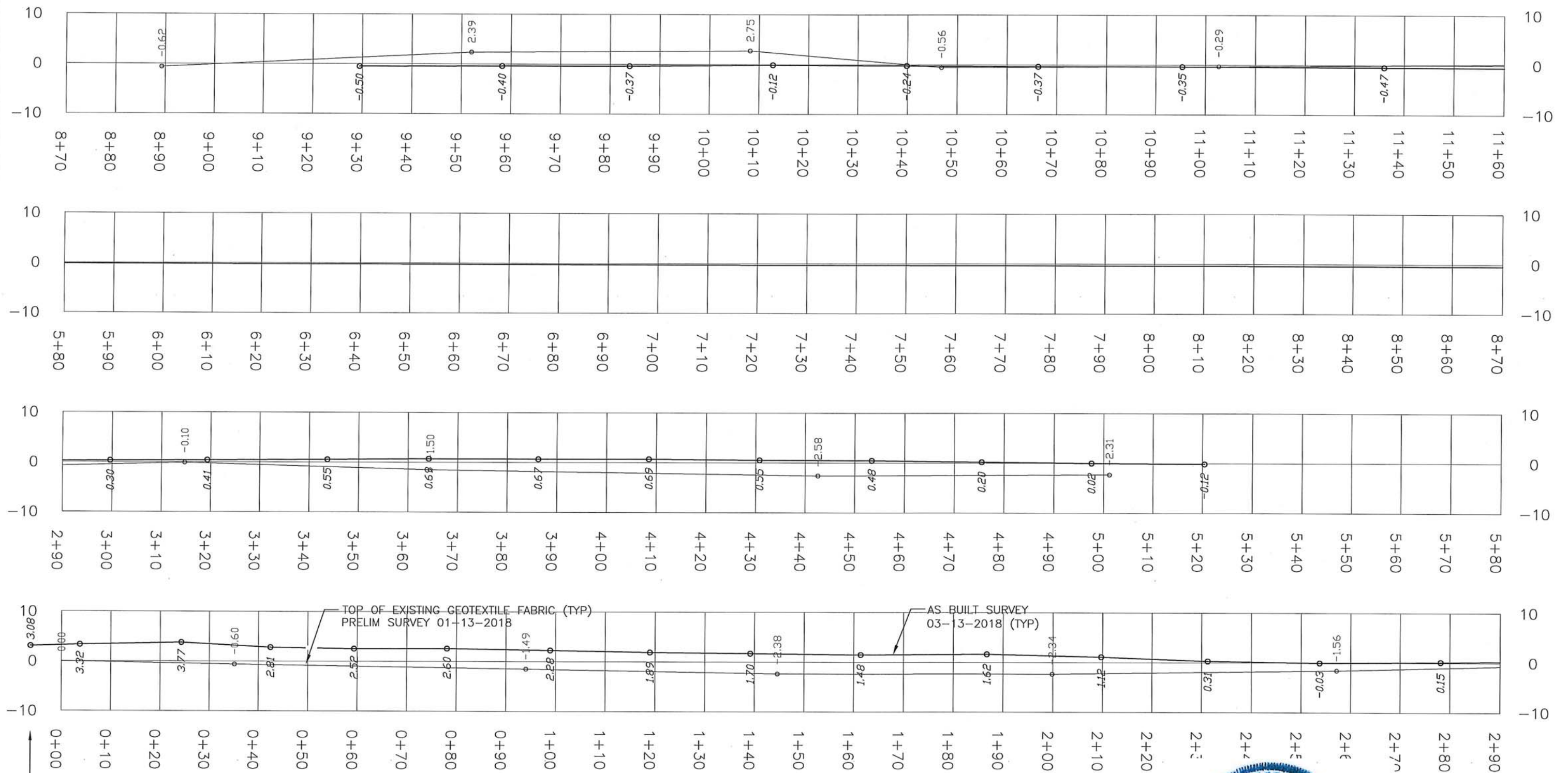

NOTE: STATION -0+07 = BEGIN
GEOTEXTILE/ANCHOR TUBE
REMOVAL AND DIKE DEGRADATION

**RACCOON ISLAND MAINTENANCE/
CONSTRUCTION FEATURE REMOVAL PROJECT
TERREBONNE PARISH, LOUISIANA**
FABRIC PROFILES - STA 0+00 THRU 11+60
SCALE: VERT 1"=20', HORIZ 1"=20'
SURVEYED 01-20-2018 PRELIM
SURVEYED 03-13-2018 AS BUILT

SURVEYED BY:
FRANCIS FORTIER, P.L.S. 4769
3091 HIGHWAY 104
OPELOUSAS, LOUISIANA 70570
PHONE: (337) 278-7204



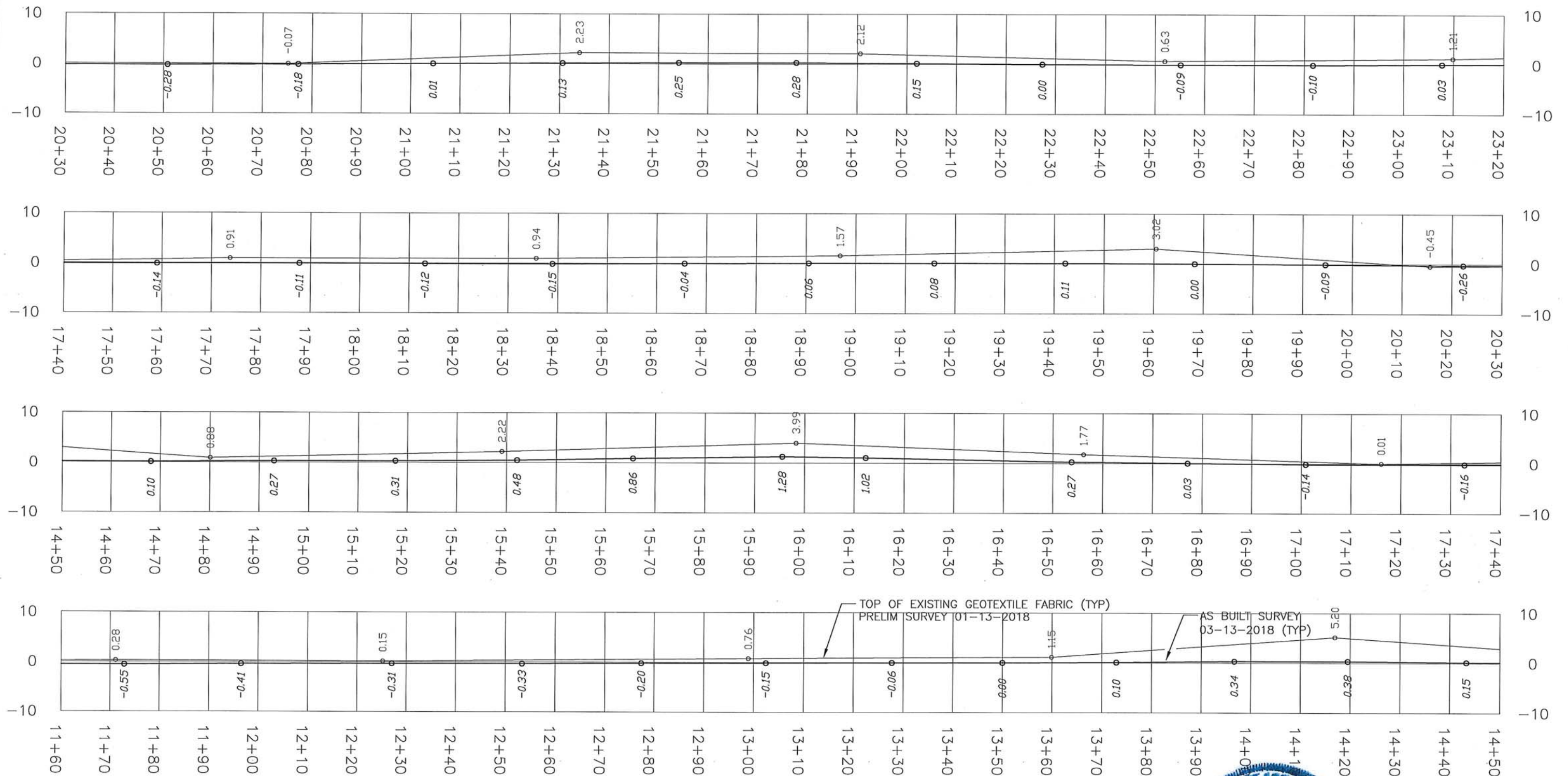

**RACCOON ISLAND MAINTENANCE/
CONSTRUCTION FEATURE REMOVAL PROJECT
TERREBONNE PARISH, LOUISIANA
FABRIC PROFILES - STA 11+60 THRU 23+20**

SCALE: VERT 1"=20', HORIZ 1"=20'

SURVEYED 01-20-2018 PRELIM
SURVEYED 03-13-2018 AS BUILT

SURVEYED BY:
FRANCIS FORTIER, P.L.S. 4769
3091 HIGHWAY 104
OPELOUSAS, LOUISIANA 70570
PHONE: (337) 278-7204



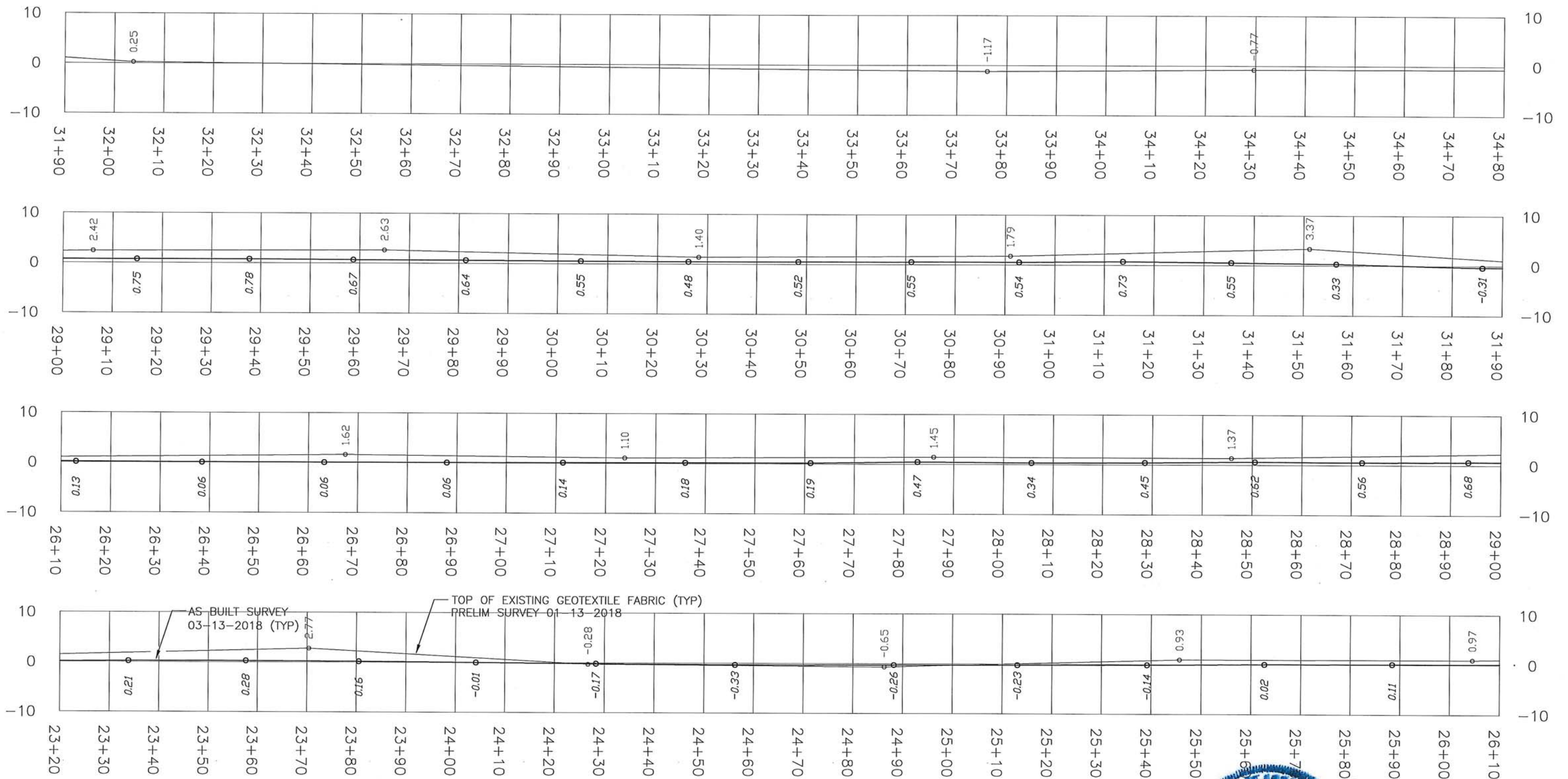

**RACCOON ISLAND MAINTENANCE/
CONSTRUCTION FEATURE REMOVAL PROJECT
TERREBONNE PARISH, LOUISIANA**
FABRIC PROFILES – STA 23+20 THRU 34+80

SCALE: VERT 1"=20', HORIZ 1"=20'

SURVEYED 01-20-2018 PRELIM
SURVEYED 03-13-2018 AS BUILT

SURVEYED BY:
FRANCIS FORTIER, P.L.S. 4769
3091 HIGHWAY 104
OPELOUSAS, LOUISIANA 70570
PHONE: (337) 278-7204



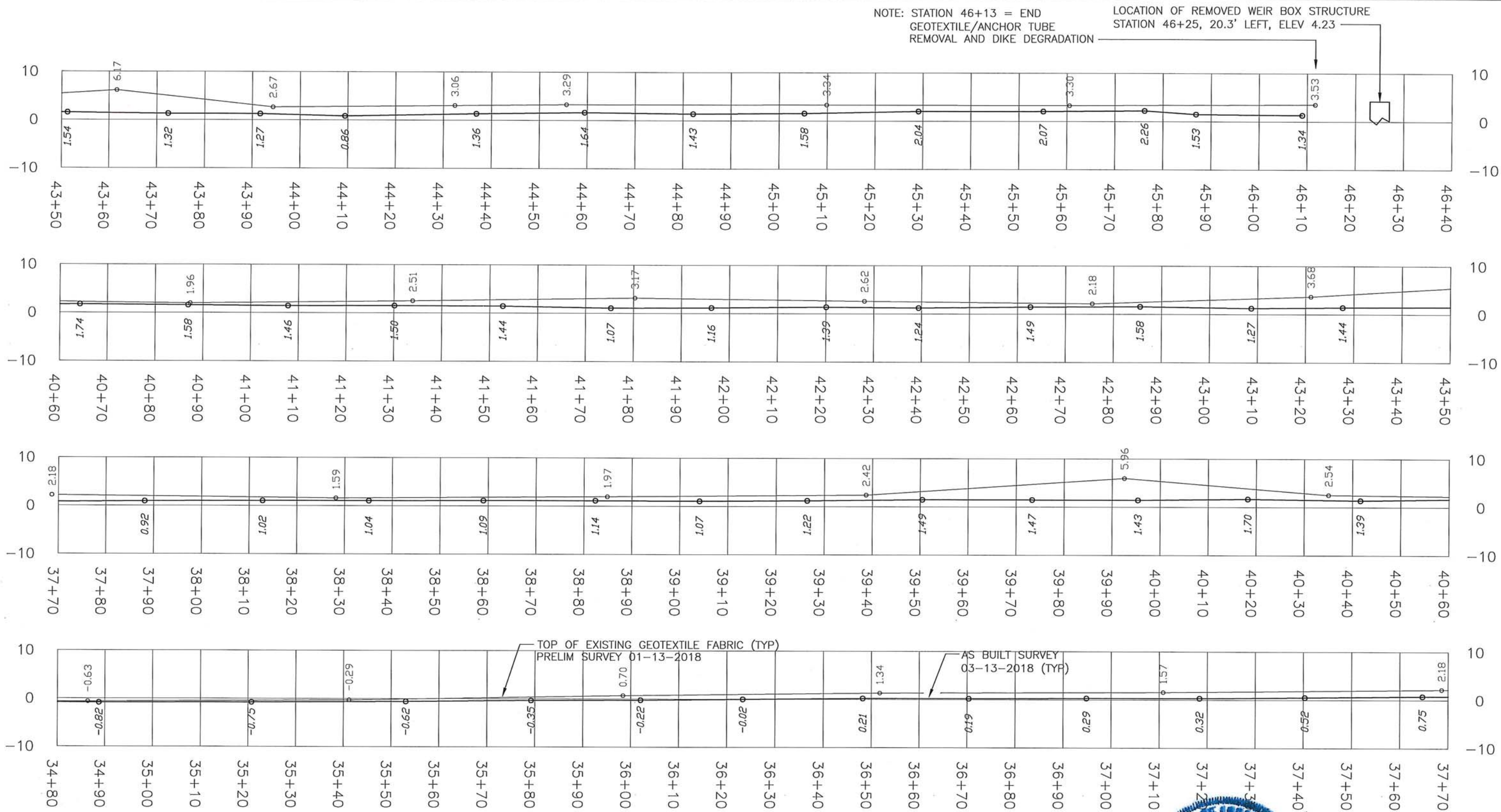

**RACCOON ISLAND MAINTENANCE/
CONSTRUCTION FEATURE REMOVAL PROJECT
TERREBONNE PARISH, LOUISIANA**
FABRIC PROFILES – STA 34+80 THRU 46+40
SCALE: VERT 1"=20', HORIZ 1"=20'
SURVEYED 01-20-2018 PRELIM
SURVEYED 03-13-2018 AS BUILT

SURVEYED BY:
FRANCIS FORTIER, P.L.S. 4769
3091 HIGHWAY 104
OPELOUSAS, LOUISIANA 70570
PHONE: (337) 278-7204

