

CHALAND HEADLAND RESTORATION (BA-38-2) CWPPRA PROJECT

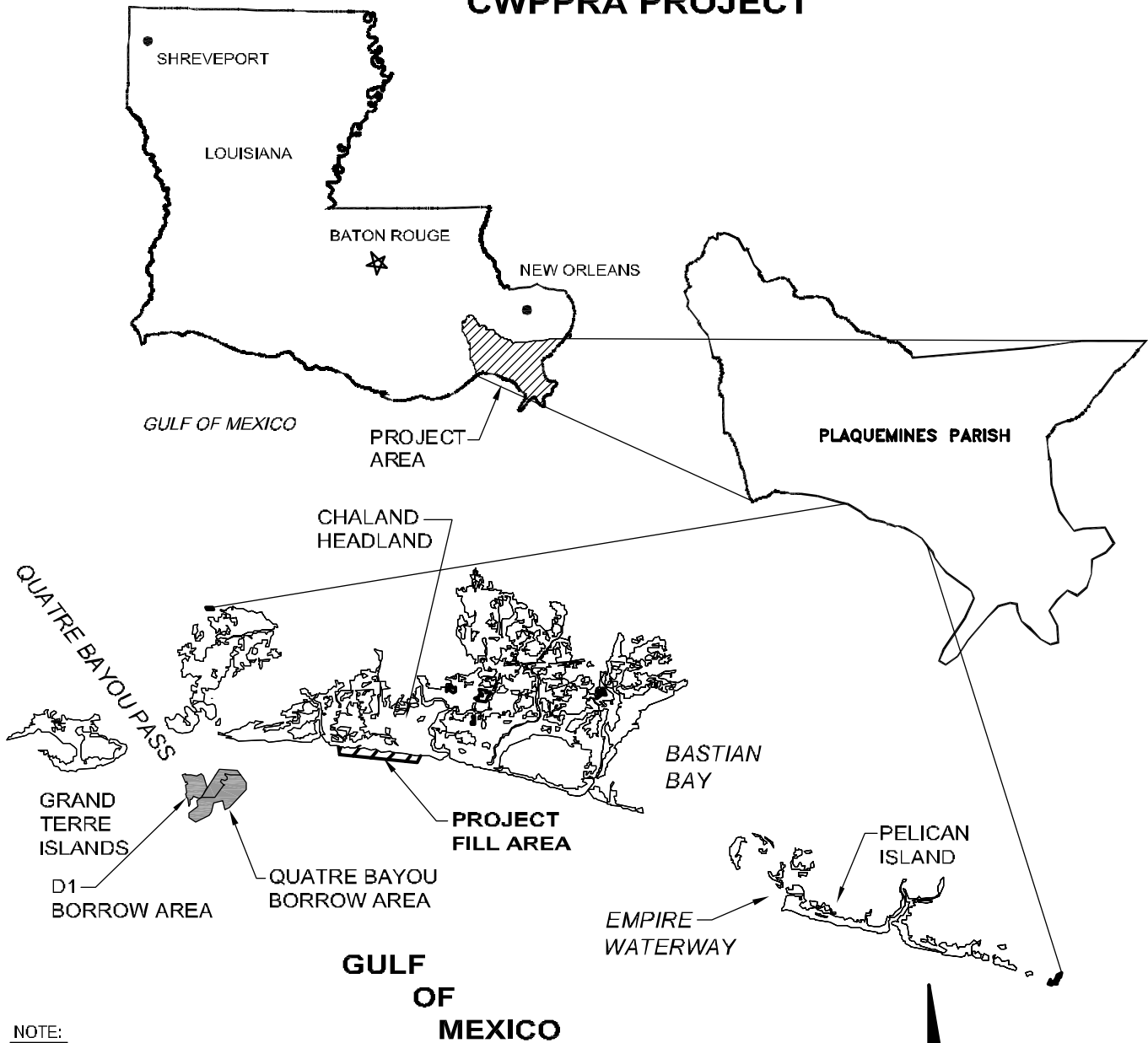

NOTE:
SOURCE OF MAP: LOUISIANA GIS CD;
A DIGITAL MAP OF THE STATE, 2 CD SET.

SHEET INDEX

NO.	TITLE
1	LOCATION MAP
2-3	PROJECT PLAN VIEW
4	QUATRE BAYOU BORROW AREA BATHYMETRY
5-6	QUATRE BAYOU BORROW AREA CROSS SECTIONS
7-9	FILL CROSS SECTIONS
10	BARGE ACCESS CANAL CROSS SECTION A-A' (TYP.)
11	TYPICAL CANAL CLOSURE PROFILE B-B' (TYP.)
12	TYPICAL CANAL CLOSURE CROSS SECTION C-C' (TYP.)
13	BREACH CLOSURE CROSS SECTION D-D'
14	BREACH CLOSURE PROFILE E-E'
15-22	D1 BORROW AREA BATHYMETRY
23-28	D1 BORROW AREA CROSS SECTIONS

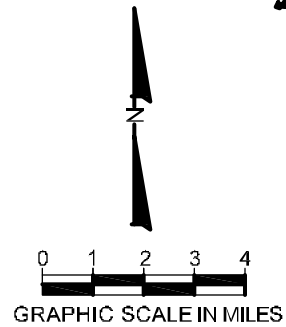

REVISIONS		
DATE	BY	DESCRIPTION
09/05/06	STR	BORROW AREA D1 ADDED

**CHALAND HEADLAND RESTORATION
(BA-38-2) CWPPRA PROJECT
LOCATION MAP**

TITLE:

2481 N.W. BOCA RATON BLVD.
BOCA RATON, FL 33431
PH. (561) 391-8102 FAX (561) 391-9116

COASTAL PLANNING & ENGINEERING, INC
www.CoastalPlanning.net

DATE:
11/17/03

BY:
JRC

COMM NO.:
7261.07

SHEET:
1

H:\Louisiana\726107\PERMITS\CHALAND\Chaland Borrow Area PV D1.dwg - Sep.05. 2006 @ 3:05pm - dmlbin

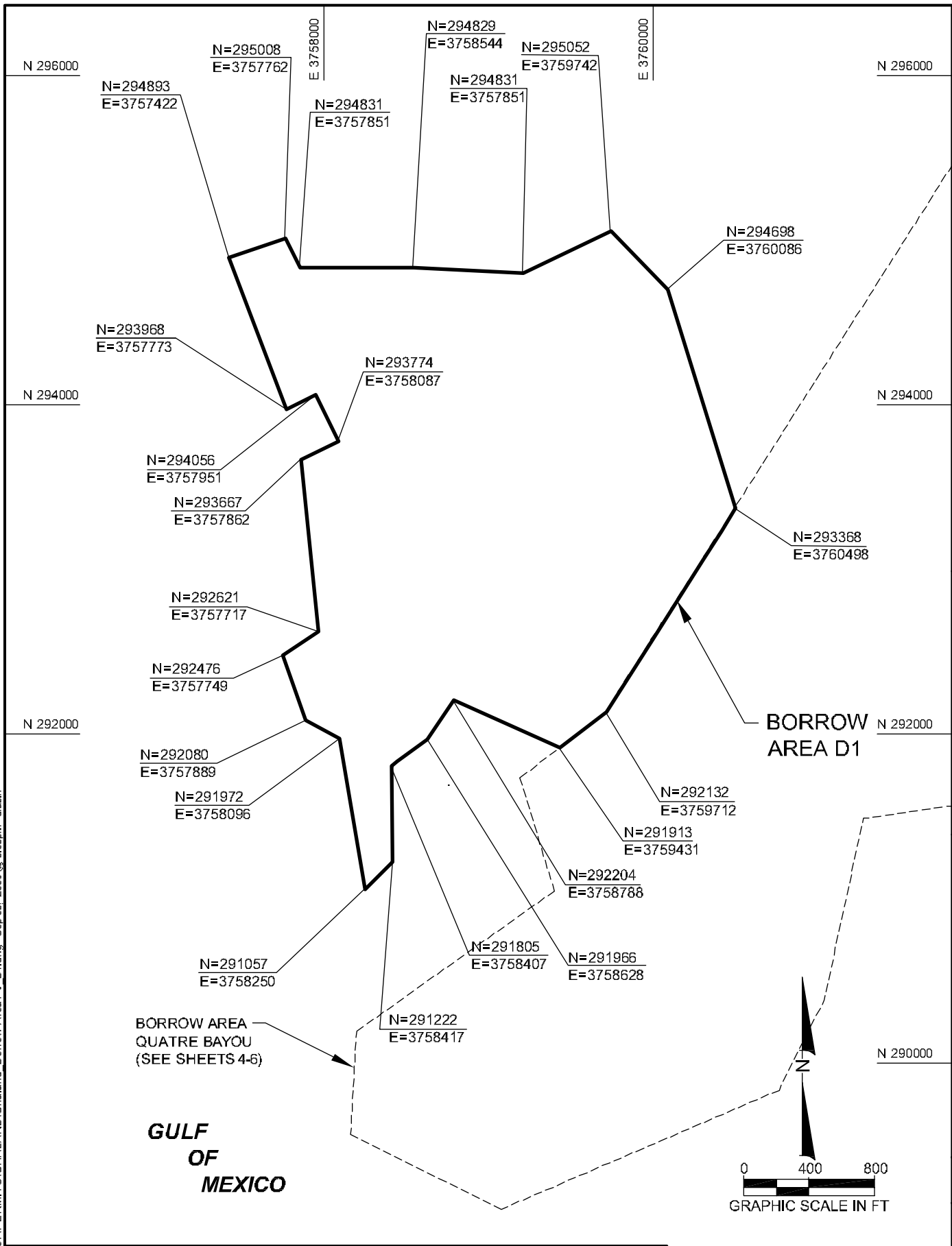

**CHALAND HEADLAND RESTORATION
(BA-38-2) CWPRA PROJECT
BORROW AREA D1 COORDINATES**

TITLE:

2481 N.W. BOCA RATON BLVD.
BOCA RATON, FL 33431
PH. (561) 391-8102 FAX (561) 391-9116

COASTAL PLANNING & ENGINEERING, INC.
www.CoastalPlanning.net

DATE: 7/22/05
BY: JRC

COMM NO.: 7900.05
SHEET: 15

NOTES:



- COORDINATES SHOWN HEREON ARE IN FEET BASED ON LOUISIANA STATE PLANE COORDINATE SYSTEM, SOUTH ZONE, NAD 1983.

REVISIONS		
DATE	BY	DESCRIPTION

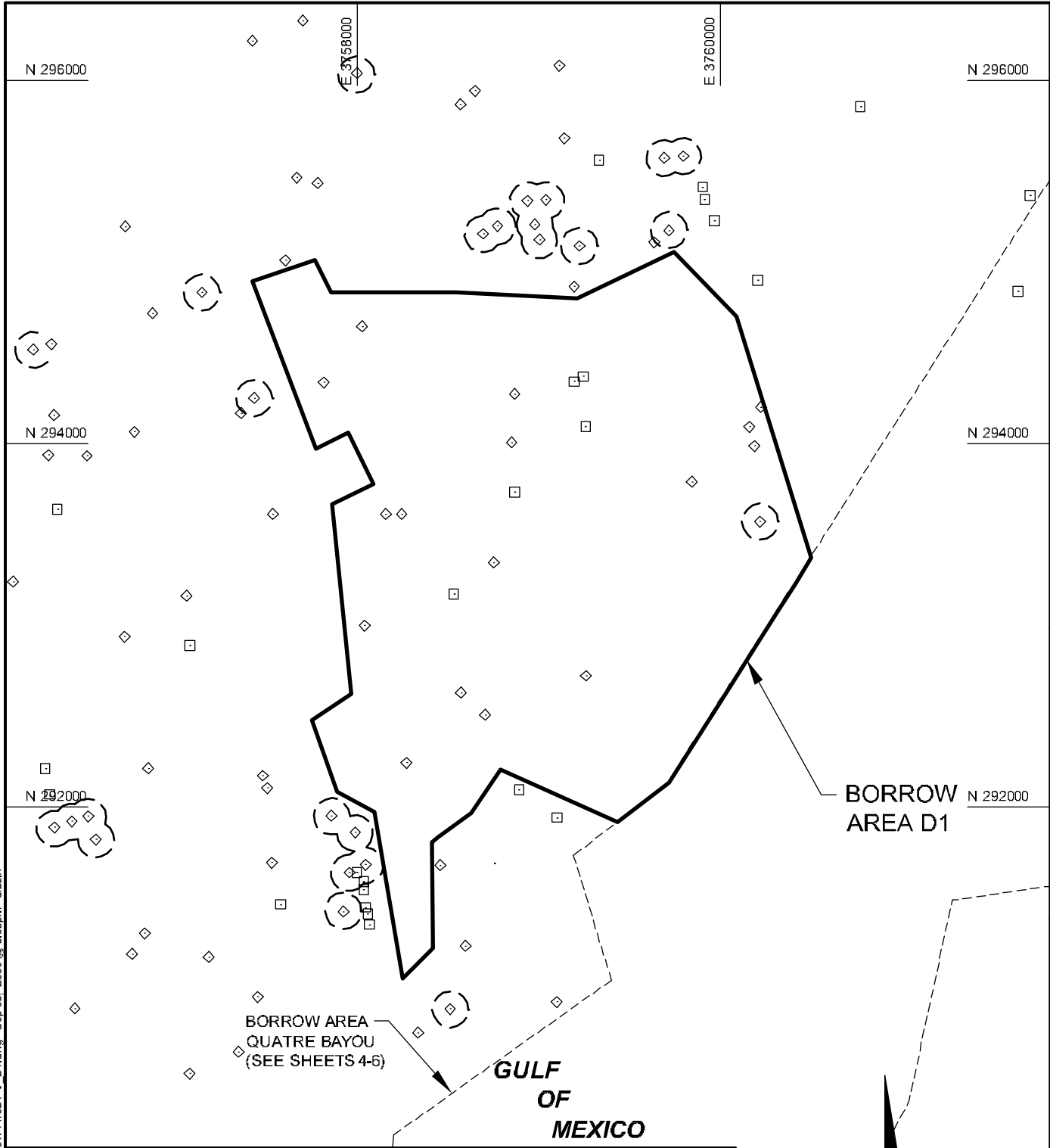
H:\Louisiana\7261\07\PERMITS\CHALAND\Chaland Borrow Area PV Dr.dwg - Sep.05.2006 @ 3:05pm - drubin



LEGEND:

-  MAGNETIC ANOMALY AREA OF AVOIDANCE (100' BUFFER)
-  2004 CULTURAL RESOURCE MAGNETIC ANOMALY
-  2003 MAGNETIC ANOMALY

NOTES:

1. COORDINATES SHOWN HEREON ARE IN FEET BASED ON LOUISIANA STATE PLANE COORDINATE SYSTEM, SOUTH ZONE, NAD 1983.
2. DATE OF MAGNETOMETER SURVEY: SEPTEMBER 2003, CONDUCTED BY CPE.

REVISIONS		
DATE	BY	DESCRIPTION

**CHALAND HEADLAND RESTORATION
(BA-38-2) CWPRA PROJECT
BORROW AREA D1 MAGNETIC ANOMALIES**

TITLE:

2481 N.W. BOCA RATON BLVD.
BOCA RATON, FL 33431
PH. (561) 391-8102 FAX (561) 391-9116

COASTAL PLANNING & ENGINEERING, INC.
www.CoastalPlanning.net

DATE: 7/22/05

BY: JRC

COMM NO.: 7900.05

SHEET: 16

H:\Louisiana\7261\07\PERMITS\CHALAND\Chaland Borrow Area PV D1.dwg - Sep.05. 2006 @ 3:02pm - dmlbin

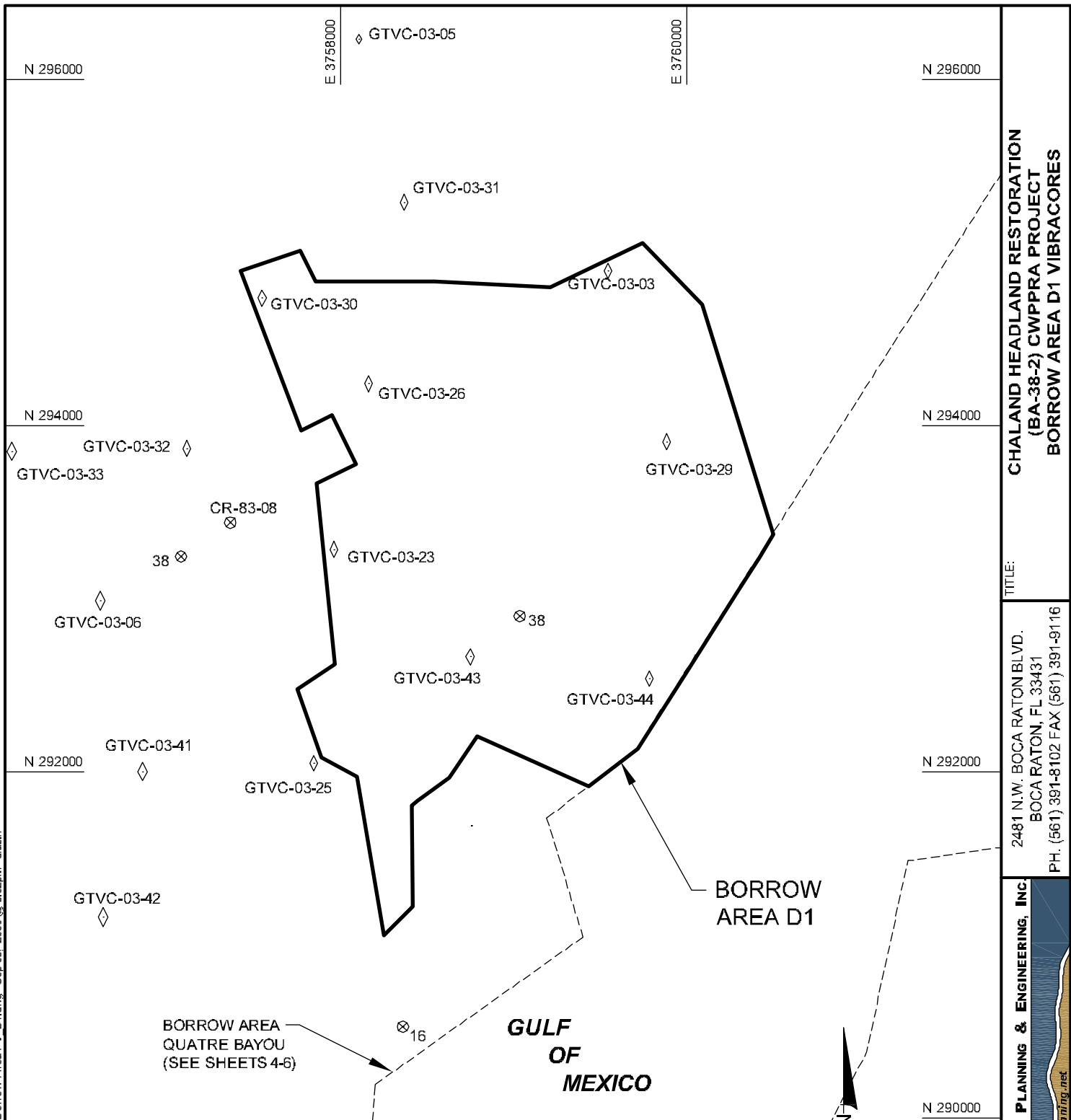

**CHALAND HEADLAND RESTORATION
(BA-38-2) CWPRA PROJECT
BORROW AREA D1 VIBRACORES**

TITLE:

2481 N.W. BOCA RATON BLVD.
BOCA RATON, FL 33431
PH. (561) 391-8102 FAX (561) 391-9116

COASTAL PLANNING & ENGINEERING, INC.
www.CoastalPlanning.net

DATE:
7/22/05

BY:
JRC

COMM NO.:
7900.05

SHEET:
17

LEGEND:

- ◇ 2003 CPE VIBRACORE
- ⊗ USGS VIBRACORE
- D1-E' CROSS SECTION LABELS

NOTES:

1. COORDINATES SHOWN HEREON ARE IN FEET BASED ON LOUISIANA STATE PLANE COORDINATE SYSTEM, SOUTH ZONE, NAD 1983.
2. ELEVATIONS SHOWN HEREON ARE IN FEET BASED ON NAVD 1988.
3. DATE OF BATHYMETRIC SURVEY, SEISMIC SCAN, SIDE SCAN SONAR, AND MAGNETOMETER SURVEY: SEPTEMBER 2003, CONDUCTED BY CPE.

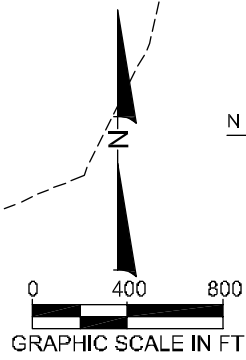

REVISIONS		
DATE	BY	DESCRIPTION

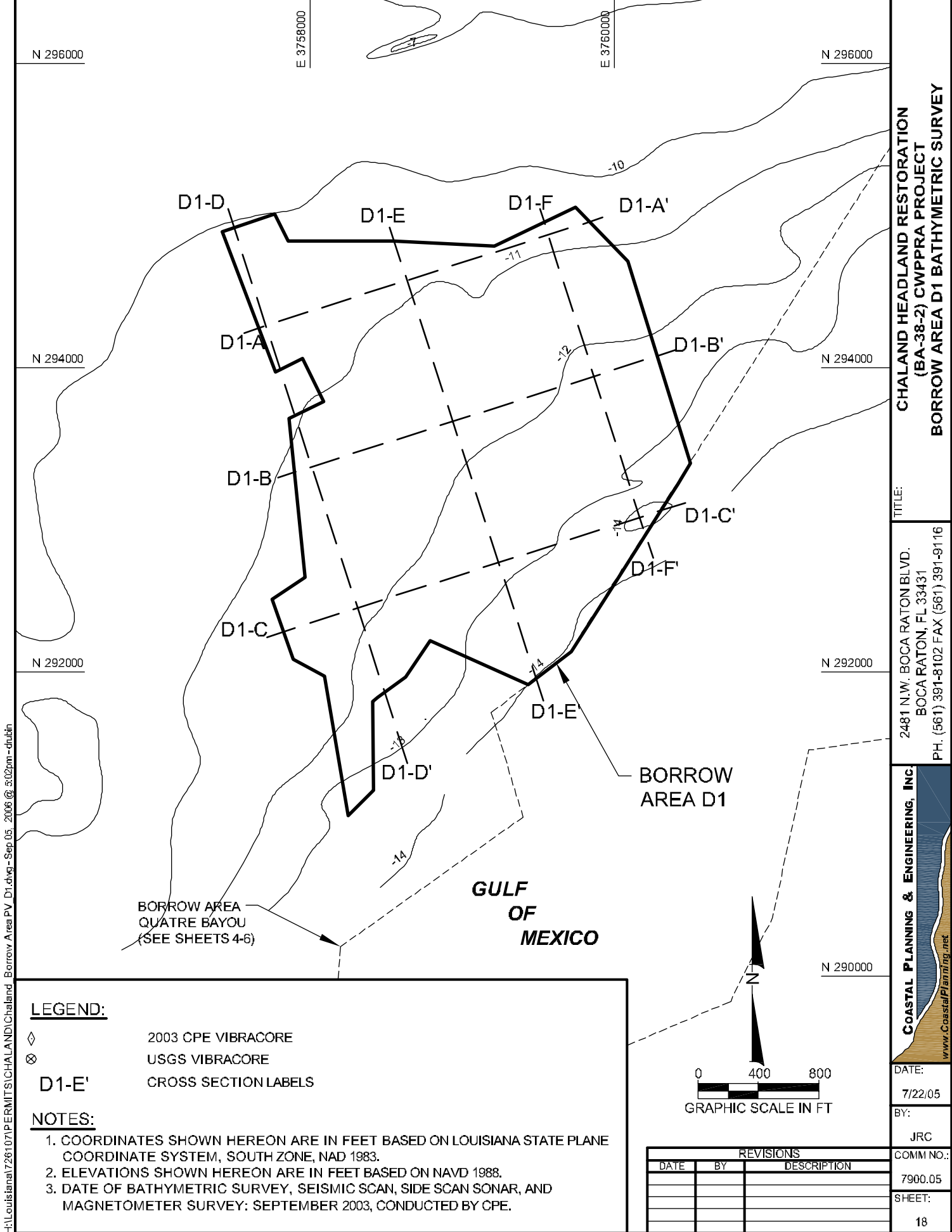

**CHALAND HEADLAND RESTORATION
(BA-38-2) CWPRA PROJECT
BORROW AREA D1 BATHYMETRIC SURVEY**

TITLE:

2481 N.W. BOCA RATON BLVD.
BOCA RATON, FL 33431
PH. (561) 391-8102 FAX (561) 391-9116

COASTAL PLANNING & ENGINEERING, INC.
www.CoastalPlanning.net

DATE:
7/22/05

BY:
JRC

COMM NO.:
7900.05

SHEET:
18

LEGEND:

- ◇ 2003 CPE VIBRACORE
- ⊗ USGS VIBRACORE
- D1-E' CROSS SECTION LABELS

NOTES:

1. COORDINATES SHOWN HEREON ARE IN FEET BASED ON LOUISIANA STATE PLANE COORDINATE SYSTEM, SOUTH ZONE, NAD 1983.
2. ELEVATIONS SHOWN HEREON ARE IN FEET BASED ON NAVD 1988.
3. DATE OF BATHYMETRIC SURVEY, SEISMIC SCAN, SIDE SCAN SONAR, AND MAGNETOMETER SURVEY: SEPTEMBER 2003, CONDUCTED BY CPE.

REVISIONS		
DATE	BY	DESCRIPTION

H:\Louisiana\7261\07\PERMITS\CHALAND\Chaland Borrow Area PV Dr.dwg - Sep.05. 2006 @ 3:02pm - drubin

N 296000

E 3758000

E 3760000

N 296000

DREDGE CUTS NOTED ON THIS SHEET REFER TO REMOVAL ELEVATION OF MARSH CONSTRUCTION MATERIAL

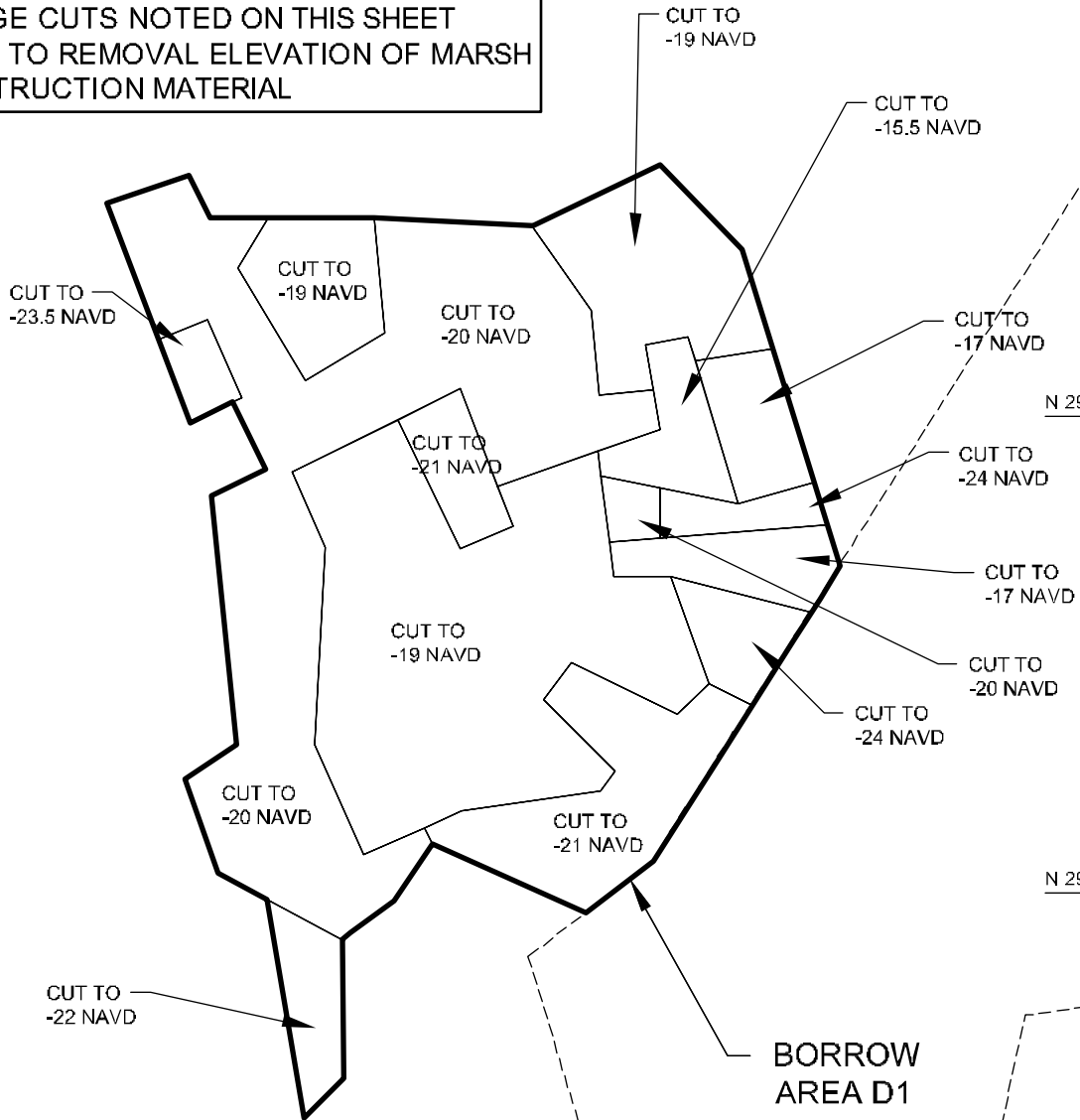

N 294000

N 294000

N 292000

N 292000

BORROW AREA D1

BORROW AREA QUATRE BAYOU (SEE SHEETS 4-6)

GULF OF MEXICO

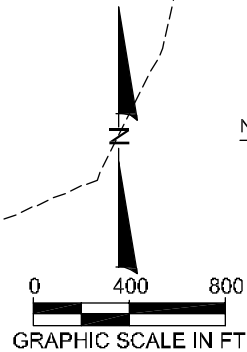

CHALAND HEADLAND RESTORATION (BA-38-2) CWPRA PROJECT BORROW AREA D1 CUT DEPTHS MARSH MATERIAL

TITLE:

2481 N.W. BOCA RATON BLVD. BOCA RATON, FL 33431 PH. (561) 391-8102 FAX (561) 391-9116



DATE: 7/22/05

BY: JRC

COMM NO.: 7900.05

SHEET: 19

NOTES:

1. COORDINATES SHOWN HEREON ARE IN FEET BASED ON LOUISIANA STATE PLANE COORDINATE SYSTEM, SOUTH ZONE, NAD 1983.
2. ALLOWABLE OVER DREDGE IS 3' (FEET) BELOW DESIGN CUT.

REVISIONS		
DATE	BY	DESCRIPTION

H:\Louisiana\7261\07\PERMITS\CHALAND\Chaland Borrow Area PV D1.dwg - Sep.05. 2006 @ 3:03pm - drubin

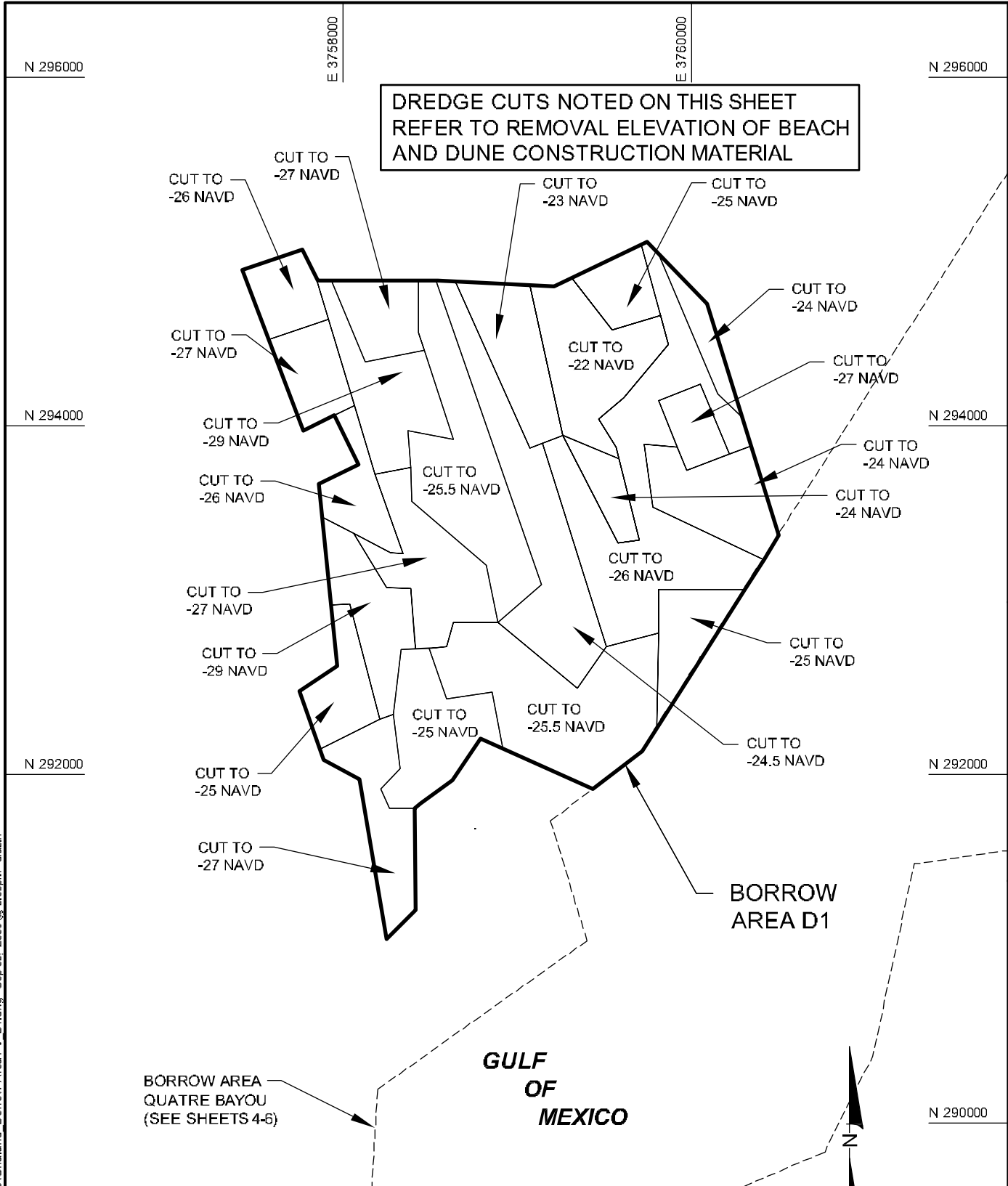

DREDGE CUTS NOTED ON THIS SHEET REFER TO REMOVAL ELEVATION OF BEACH AND DUNE CONSTRUCTION MATERIAL

CHALAND HEADLAND RESTORATION (BA-38-2) CWPRA PROJECT
BORROW AREA D1 BEACH & DUNE MATERIAL CUT DEPTHS

TITLE:
 2481 N.W. BOCA RATON BLVD.
 BOCA RATON, FL 33431
 PH. (561) 391-8102 FAX (561) 391-9116

COASTAL PLANNING & ENGINEERING, INC.

 www.CoastalPlanning.net

DATE: 7/22/05
 BY: JRC
 COMM NO.: 7900.05
 SHEET: 20

LEGEND:

D1-E' CROSS SECTION LABELS

NOTES:

1. COORDINATES SHOWN HEREON ARE IN FEET BASED ON LOUISIANA STATE PLANE COORDINATE SYSTEM, SOUTH ZONE, NAD 1983.
2. ELEVATIONS SHOWN HEREON ARE IN FEET BASED ON NAVD 1988.
3. DATE OF BATHYMETRIC SURVEY, SEISMIC SCAN, SIDE SCAN SONAR, AND MAGNETOMETER SURVEY: SEPTEMBER 2003, CONDUCTED BY CPE.
4. CONTOURS REPRESENT BOTTOM OF SAND LAYER.

REVISIONS		
DATE	BY	DESCRIPTION

H:\Louisiana\726107\PERMITS\CHALAND\Borrow Area PV Dr.dwg - Sep.05.2006 @ 3:04pm - drubin

N 296000

E 3758000

E 3760000

N 296000

N 294000

N 294000

N 292000

N 292000

N 290000

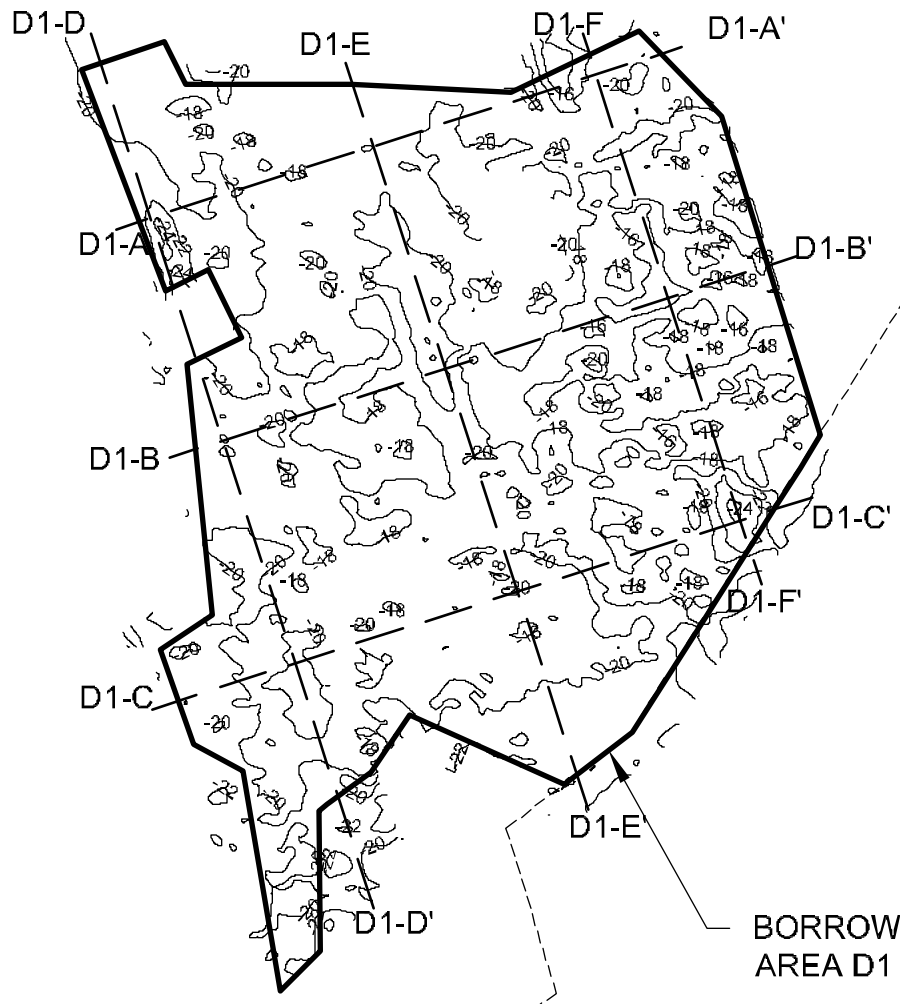

BORROW AREA
QUATRE BAYOU
(SEE SHEETS 4-6)

**GULF
OF
MEXICO**

**BORROW
AREA D1**

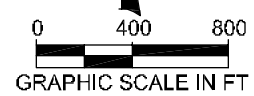

LEGEND:

D1-E' CROSS SECTION LABELS

NOTES:

1. COORDINATES SHOWN HEREON ARE IN FEET BASED ON LOUISIANA STATE PLANE COORDINATE SYSTEM, SOUTH ZONE, NAD 1983.
2. ELEVATIONS SHOWN HEREON ARE IN FEET BASED ON NAVD 1988.
3. DATE OF BATHYMETRIC SURVEY, SEISMIC SCAN, SIDE SCAN SONAR, AND
4. CONTOURS REPRESENT BOTTOM OF SILT/CLAY LAYER AND TOP OF SAND LAYER.

REVISIONS		
DATE	BY	DESCRIPTION

**CHALAND HEADLAND RESTORATION
(BA-38-2) CWPRA PROJECT
BORROW AREA D1 SILT/CLAY ELEVATIONS**

TITLE:

2481 N.W. BOCA RATON BLVD.
BOCA RATON, FL 33431
PH. (561) 391-8102 FAX (561) 391-9116

COASTAL PLANNING & ENGINEERING, INC
www.CoastalPlanning.net

DATE:
7/22/05

BY:
JRC

COMM NO.:
7900.05

SHEET:
21

H:\Louisiana\7261\07\PERMITS\CHALAND\Borrow Area PV Dr.dwg - Sep.05. 2006 @ 3:04pm - drubin

N 296000

E 3758000

E 3760000

N 296000

N 294000

N 294000

N 292000

N 292000

N 290000

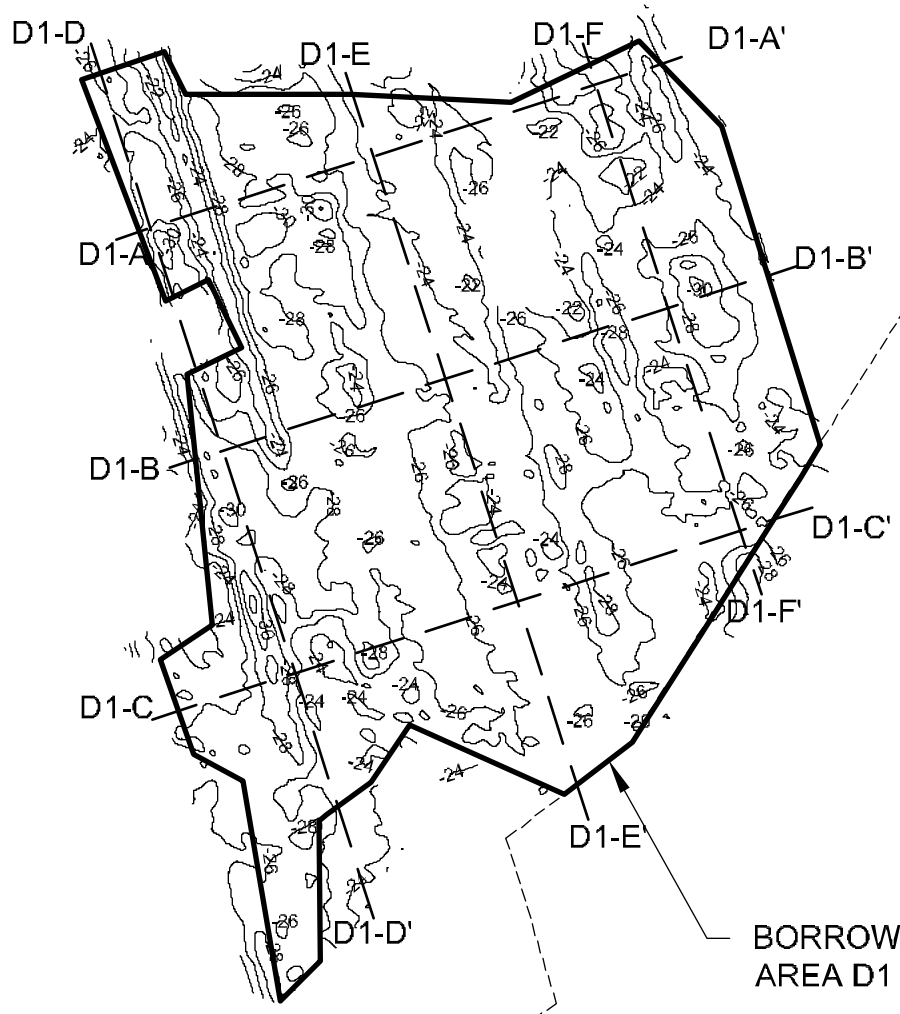

BORROW AREA
QUATRE BAYOU
(SEE SHEETS 4-6)

GULF
OF
MEXICO

BORROW
AREA D1

LEGEND:

D1-E' CROSS SECTION LABELS

NOTES:

1. COORDINATES SHOWN HEREON ARE IN FEET BASED ON LOUISIANA STATE PLANE COORDINATE SYSTEM, SOUTH ZONE, NAD 1983.
2. ELEVATIONS SHOWN HEREON ARE IN FEET BASED ON NAVD 1988.
3. DATE OF BATHYMETRIC SURVEY, SEISMIC SCAN, SIDE SCAN SONAR, AND MAGNETOMETER SURVEY: SEPTEMBER 2003, CONDUCTED BY CPE.
4. CONTOURS REPRESENT BOTTOM OF SAND LAYER.

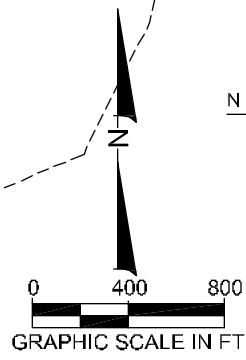

REVISIONS		
DATE	BY	DESCRIPTION

**CHALAND HEADLAND RESTORATION
(BA-38-2) CWPRA PROJECT
BORROW AREA D1 BEACH & DUNE MATERIAL CONTOURS**

TITLE:
2481 N.W. BOCA RATON BLVD.
BOCA RATON, FL 33431
PH. (561) 391-8102 FAX (561) 391-9116

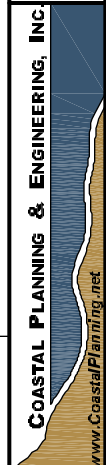

DATE: 7/22/05
BY: JRC
COMM NO.: 7900.05
SHEET: 22

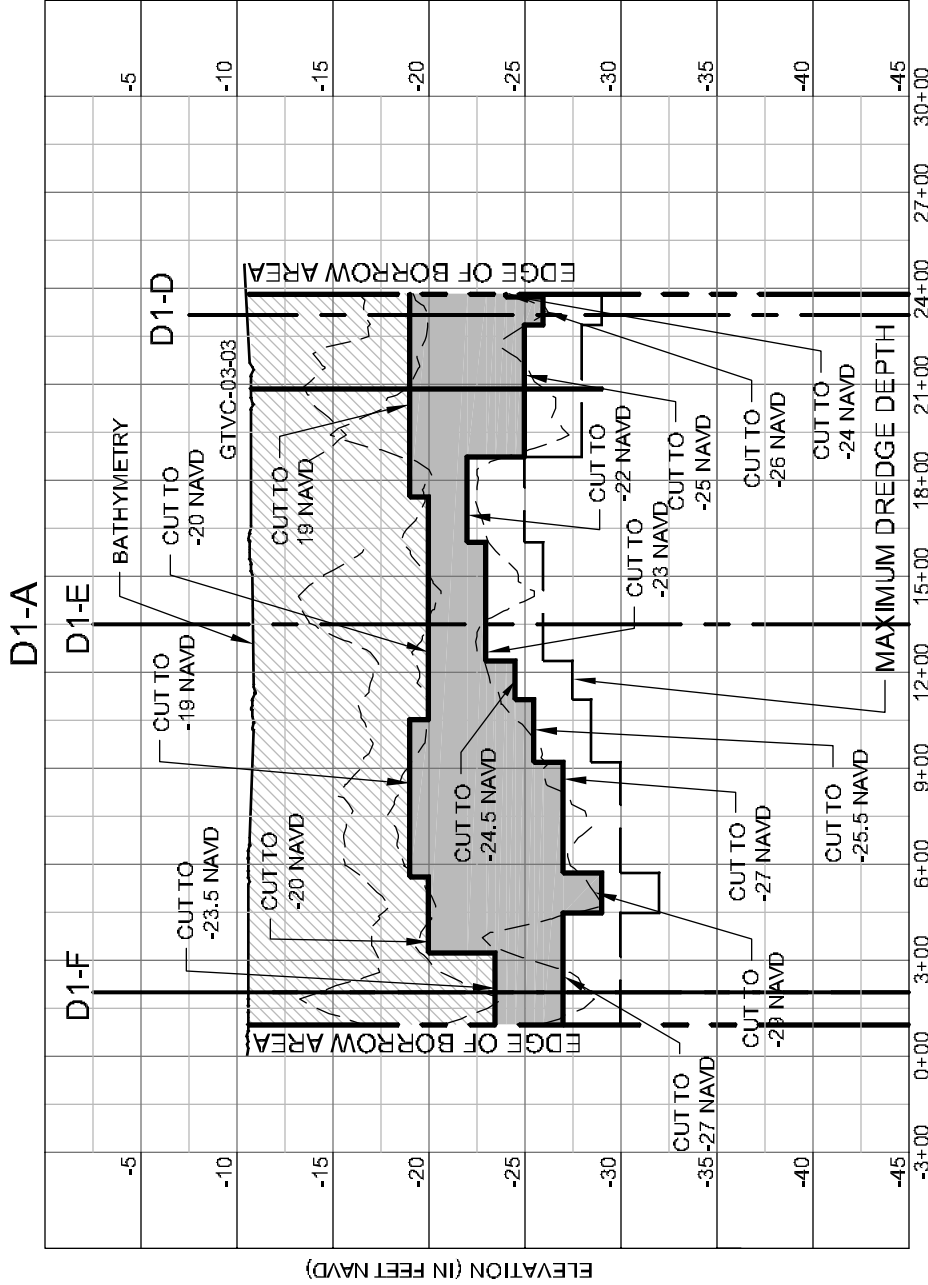

NOTES:

1. CORES MAY NOT FALL DIRECTLY ON CROSS SECTION LINE, BUT ARE LOCATED SUFFICIENTLY CLOSE TO REPRESENT SIMILAR MATERIAL.
2. WIDTH OF LAYERS IS REPRESENTATIVE ONLY. ACTUAL MATERIAL MAY VARY.
3. SEE PAGES 18, 21 & 22 FOR LOCATION OF CROSS SECTION LINE.
4. MAXIMUM DREDGE DEPTH 3 FEET BELOW DESIGN CUT DEPTH SHOWN.

LEGEND:

-  MARSH FILL MATERIAL
-  BEACH FILL MATERIAL
-  SEISMIC REFLECTOR

REVISIONS		
DATE	BY	DESCRIPTION
09/03/06	STR	BORROW AREA D1 ADDED

SCALE: HORZ. 1" = 600'
VERT. 1" = 10'

**CHALAND HEADLAND RESTORATION
(BA-38-2) CWPPRA PROJECT
BORROW AREA D1 CROSS SECTION D1-A**

TITLE:
2481 N.W. BOCA RATON BLVD.
BOCA RATON, FL 33431
PH. (561) 391-8102 FAX (561) 391-9116



DATE:	7/22/05
BY:	JRC
COMM NO.:	7900.05
SHEET:	23

D1-B

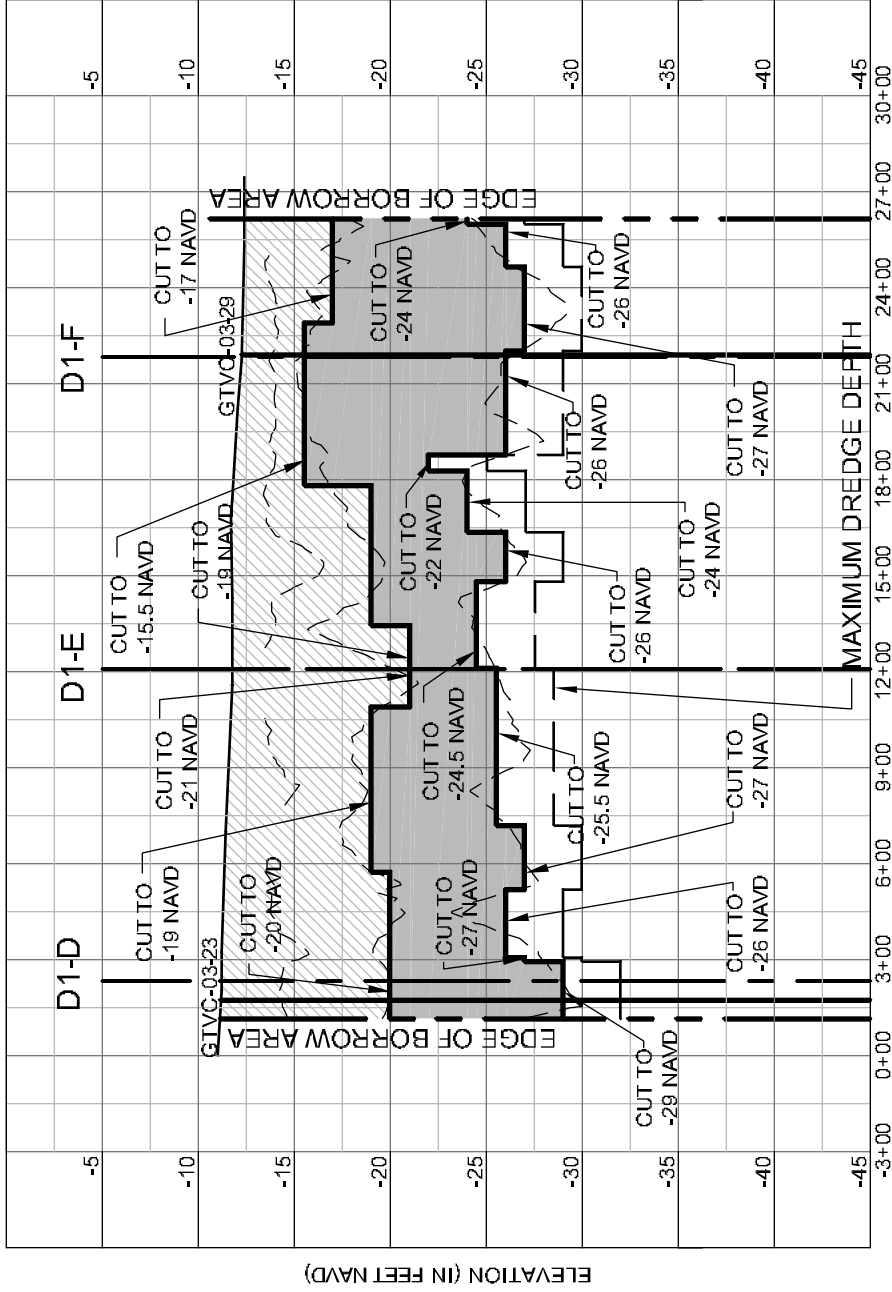



SCALE: HORZ. 1" = 600'
VERT. 1" = 10'

NOTES:

1. CORES MAY NOT FALL DIRECTLY ON CROSS SECTION LINE, BUT ARE LOCATED SUFFICIENTLY CLOSE TO REPRESENT SIMILAR MATERIAL.
2. WIDTH OF LAYERS IS REPRESENTATIVE ONLY. ACTUAL MATERIAL MAY VARY.
3. SEE PAGES 18, 21 & 22 FOR LOCATION OF CROSS SECTION LINE.
4. MAXIMUM DREDGE DEPTH 3 FEET BELOW DESIGN CUT DEPTH SHOWN.

LEGEND:

-  MARSH FILL MATERIAL
-  BEACH FILL MATERIAL
-  SEISMIC REFLECTOR

REVISIONS		
DATE	BY	DESCRIPTION
09/03/06	STR	BORROW AREA D1 ADDED

DATE:	7/22/05
BY:	JRC
COMM NO.:	7900.05
SHEET:	24

COASTAL PLANNING & ENGINEERING, INC
www.CoastalPlanning.net

2481 N.W. BOCA RATON BLVD.
BOCA RATON, FL 33431
PH. (561) 391-8102 FAX (561) 391-9116

TITLE:

**CHALAND HEADLAND RESTORATION
(BA-38-2) CWPPRA PROJECT
BORROW AREA D1 CROSS SECTION D1-B**

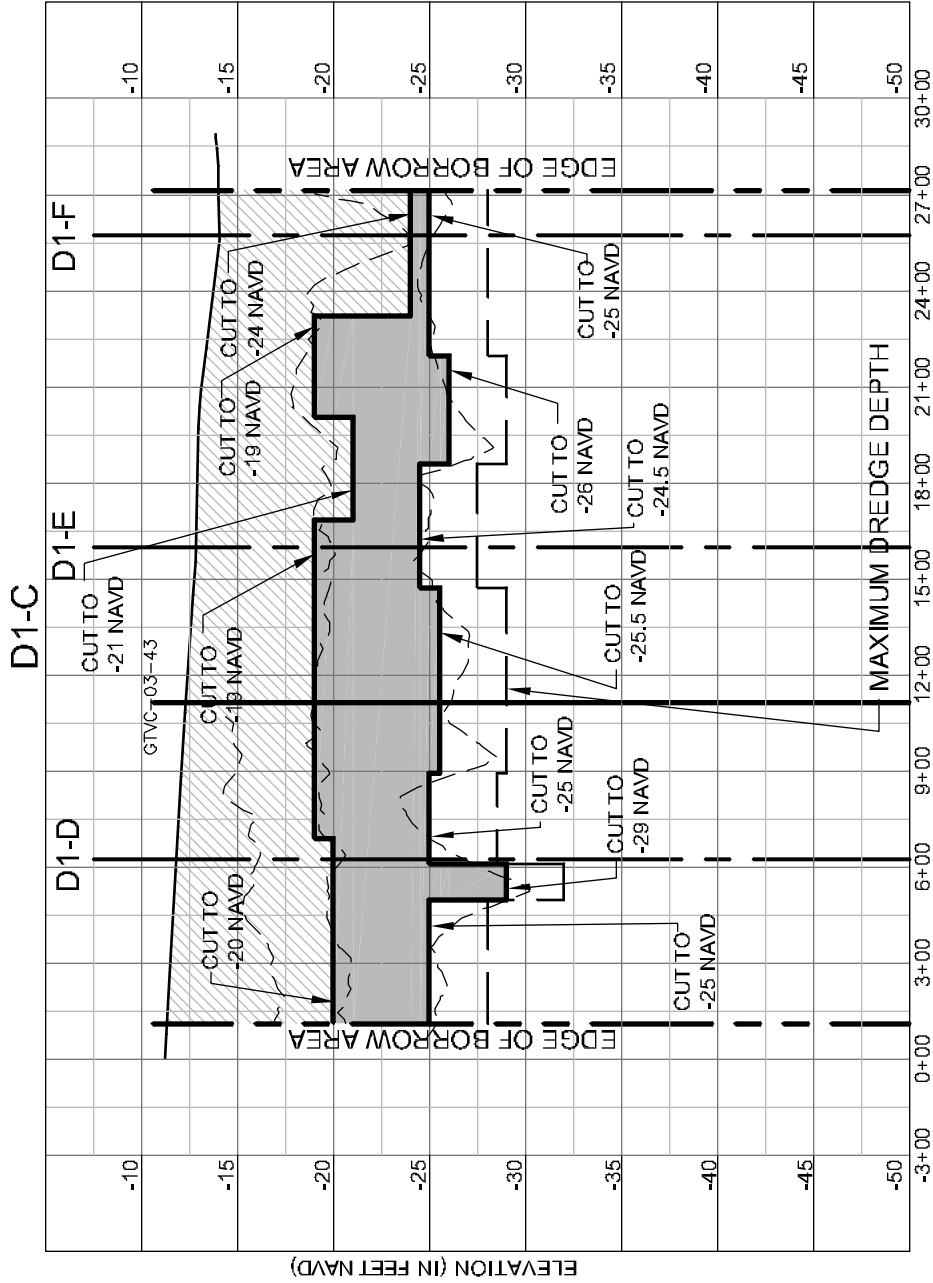

SCALE: HORZ. 1" = 600'
VERT. 1" = 10'

NOTES:

1. CORES MAY NOT FALL DIRECTLY ON CROSS SECTION LINE, BUT ARE LOCATED SUFFICIENTLY CLOSE TO REPRESENT SIMILAR MATERIAL.
2. WIDTH OF LAYERS IS REPRESENTATIVE ONLY. ACTUAL MATERIAL MAY VARY.
3. SEE PAGES 18, 21 & 22 FOR LOCATION OF CROSS SECTION LINE.
4. MAXIMUM DREDGE DEPTH 3 FEET BELOW DESIGN CUT DEPTH SHOWN.

LEGEND:

-  MARSH FILL MATERIAL
-  BEACH FILL MATERIAL
-  SEISMIC REFLECTOR

REVISIONS		
DATE	BY	DESCRIPTION
09/03/06	STR	BORROW AREA D1 ADDED

**CHALAND HEADLAND RESTORATION
(BA-38-2) CWPBRA PROJECT
BORROW AREA D1 CROSS SECTION D1-C**

2481 N.W. BOCA RATON BLVD.
BOCA RATON, FL 33431
PH. (561) 391-8102 FAX (561) 391-9116



DATE:	7/22/05
BY:	JRC
COMM NO.:	7900.05
SHEET:	25

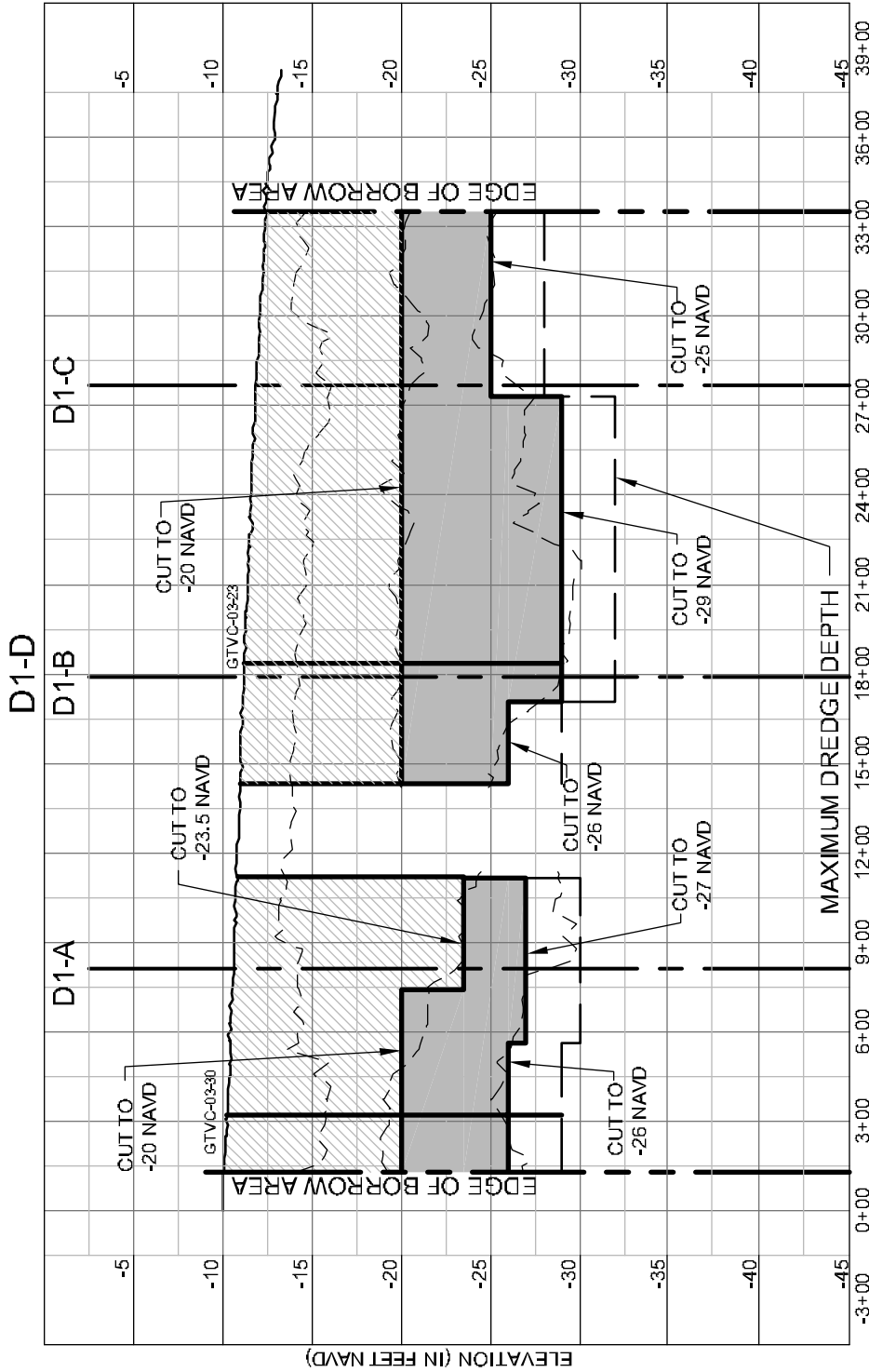

SCALE: HORZ. 1" = 600'
VERT. 1" = 10'

NOTES:

1. CORES MAY NOT FALL DIRECTLY ON CROSS SECTION LINE, BUT ARE LOCATED SUFFICIENTLY CLOSE TO REPRESENT SIMILAR MATERIAL.
2. WIDTH OF LAYERS IS REPRESENTATIVE ONLY. ACTUAL MATERIAL MAY VARY.
3. SEE PAGES 18, 21 & 22 FOR LOCATION OF CROSS SECTION LINE.
4. MAXIMUM DREDGE DEPTH 3 FEET BELOW DESIGN CUT DEPTH SHOWN.

LEGEND:

-  MARSH FILL MATERIAL
-  BEACH FILL MATERIAL
-  SEISMIC REFLECTOR

REVISIONS		
DATE	BY	DESCRIPTION
09/03/06	str	BORROW AREA D1 ADDED

DATE:	7/22/05
BY:	JRC
COMM NO.:	7900.05
SHEET:	26

COASTAL PLANNING & ENGINEERING, INC
www.CoastalPlanning.net

2481 N.W. BOCA RATON BLVD.
BOCA RATON, FL 33431
PH. (561) 391-8102 FAX (561) 391-9116

**CHALAND HEADLAND RESTORATION
(BA-38-2) CWPPRA PROJECT
BORROW AREA D1 CROSS SECTION D1-D**

D1-E

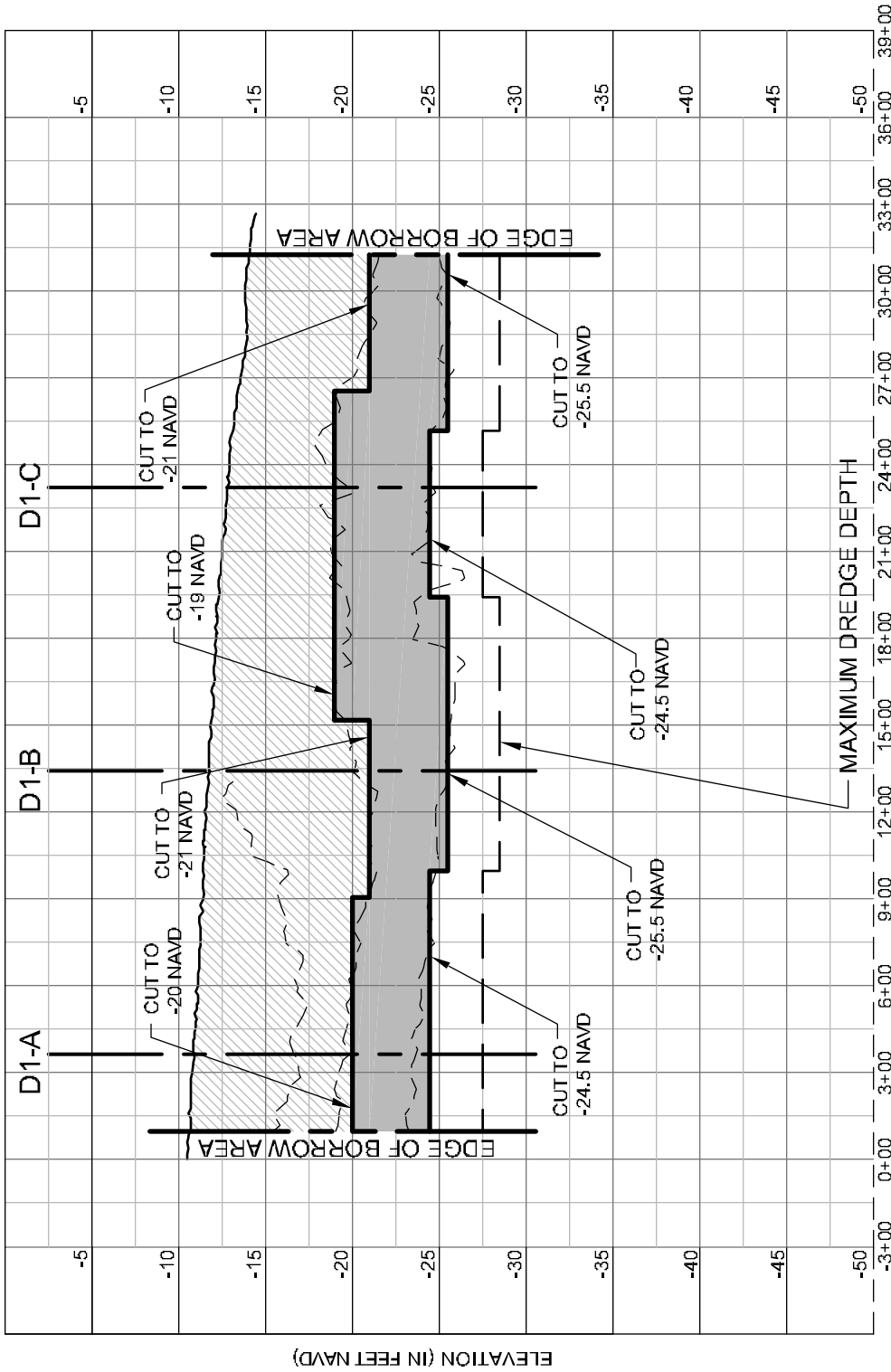

NOTES:

1. CORES MAY NOT FALL DIRECTLY ON CROSS SECTION LINE, BUT ARE LOCATED SUFFICIENTLY CLOSE TO REPRESENT SIMILAR MATERIAL.
2. WIDTH OF LAYERS IS REPRESENTATIVE ONLY. ACTUAL MATERIAL MAY VARY.
3. SEE PAGES 18, 21 & 22 FOR LOCATION OF CROSS SECTION LINE.
4. MAXIMUM DREDGE DEPTH 3 FEET BELOW DESIGN CUT DEPTH SHOWN.

LEGEND:

-  MARSH FILL MATERIAL
-  BEACH FILL MATERIAL
-  SEISMIC REFLECTOR

REVISIONS		
DATE	BY	DESCRIPTION
09/03/06	STR	BORROW AREA D1 ADDED

DATE:	7/22/05
BY:	JRC
COMM NO.:	7900.05
SHEET:	27

SCALE: HORZ. 1" = 600'
VERT. 1" = 10'

CHALAND HEADLAND RESTORATION
(BA-38-2) CWPPRA PROJECT
BORROW AREA D1 CROSS SECTION D1-E

TITLE:
2481 N.W. BOCA RATON BLVD.
BOCA RATON, FL 33431
PH. (561) 391-8102 FAX (561) 391-9116

COASTAL PLANNING & ENGINEERING, INC
www.CoastalPlanning.net



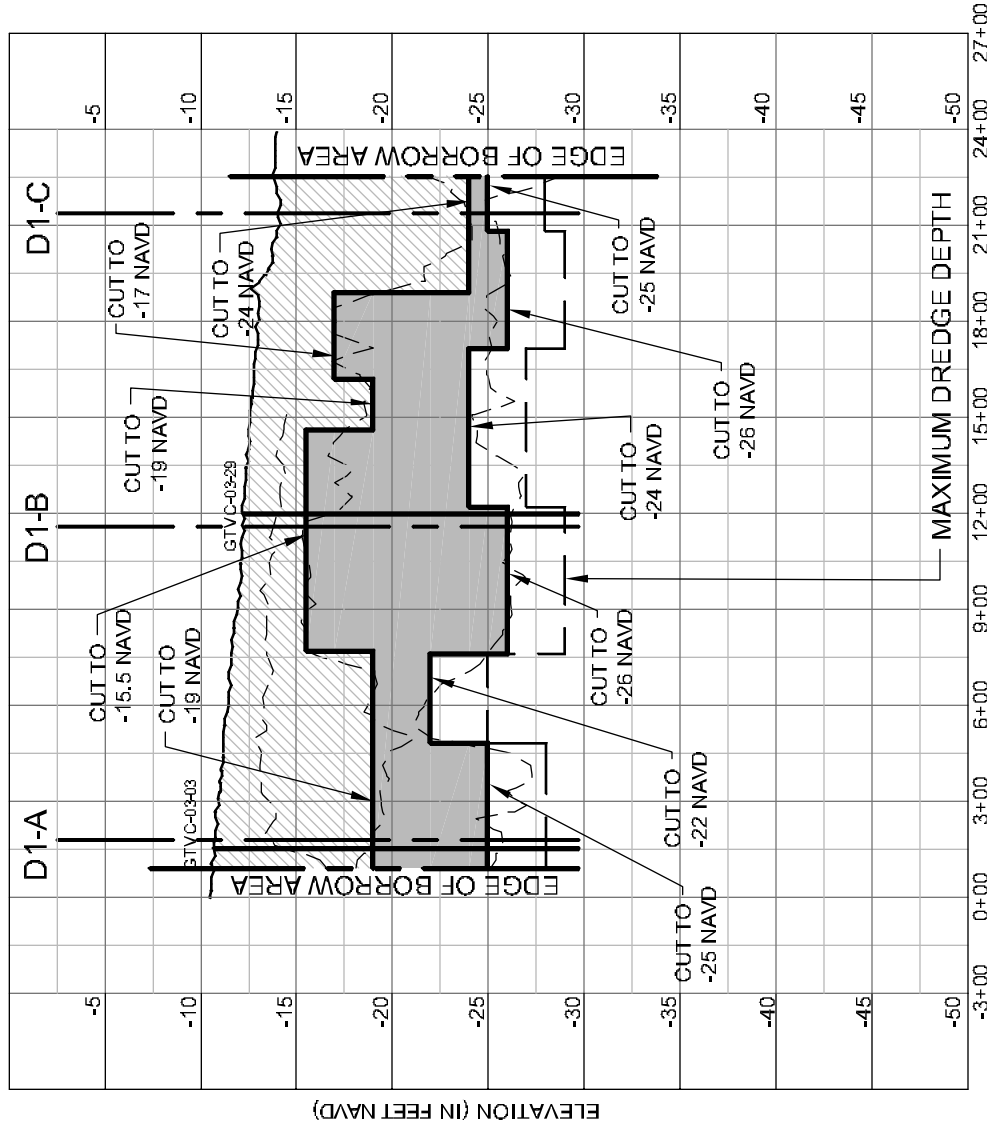

D1-F



NOTES:

1. CORES MAY NOT FALL DIRECTLY ON CROSS SECTION LINE, BUT ARE LOCATED SUFFICIENTLY CLOSE TO REPRESENT SIMILAR MATERIAL.
2. WIDTH OF LAYERS IS REPRESENTATIVE ONLY. ACTUAL MATERIAL MAY VARY.
3. SEE PAGES 18, 21 & 22 FOR LOCATION OF CROSS SECTION LINE.
4. MAXIMUM DREDGE DEPTH 3 FEET BELOW DESIGN CUT DEPTH SHOWN.

LEGEND:

-  MARSH FILL MATERIAL
-  BEACH FILL MATERIAL
-  SEISMIC REFLECTOR

REVISIONS		
DATE	BY	DESCRIPTION
09/03/06	STR	BORROW AREA D1 ADDED

DATE:	7/22/05
BY:	JRC
COMM NO.:	7900.05
SHEET:	28

SCALE: HORZ. 1" = 600'
VERT. 1" = 10'

TITLE: CHALAND HEADLAND RESTORATION
(BA-38-2) CWPPRA PROJECT
BORROW AREA D1 CROSS SECTION D1-F

2481 N.W. BOCA RATON BLVD.
BOCA RATON, FL 33431
P.H. (561) 391-8102 FAX (561) 391-9116

