

INDEX TO SHEETS

SHEET NO. DESCRIPTION

- 1 TITLE SHEET
- 2 PROJECT LOCATION
- 3 MARINE ACCESS ROUTE PLAN
- 4 MARINE ACCESS ROUTE PROFILE
- 5 MARINE ACCESS ROUTE PROFILE
- 6 MARINE ACCESS ROUTE PROFILE
- 7 MARINE ACCESS ROUTE PROFILE
- 8 MARINE ACCESS ROUTE PROFILE
- 9 MARINE ACCESS ROUTE PROFILE
- 10 MARINE ACCESS ROUTE PROFILE
- 11 MARINE ACCESS ROUTE PROFILE
- 12 DETAIL "A" PECONI BAYOU
- 13 DETAIL "A" PECONI BAYOU
- 14 DETAIL "B" MANGROVE BAYOU
- 15 DETAIL "B" MANGROVE BAYOU
- 16 DETAIL "C" GRAND BAYOU
- 17 DETAIL "C" GRAND BAYOU
- 18 4' WATER DEPTH CONTOUR AND POTENTIAL PIPELINE LOCATIONS
- 19 HAZARD LINE PLAN & DETAILS

STATE OF LOUISIANA
COASTAL PROTECTION AND RESTORATION AUTHORITY

CAMERON-CREOLE LEVEE
LAKESHORE PROTECTION PROJECT
STATE PROJECT NO. CS-04-A
CAMERON PARISH

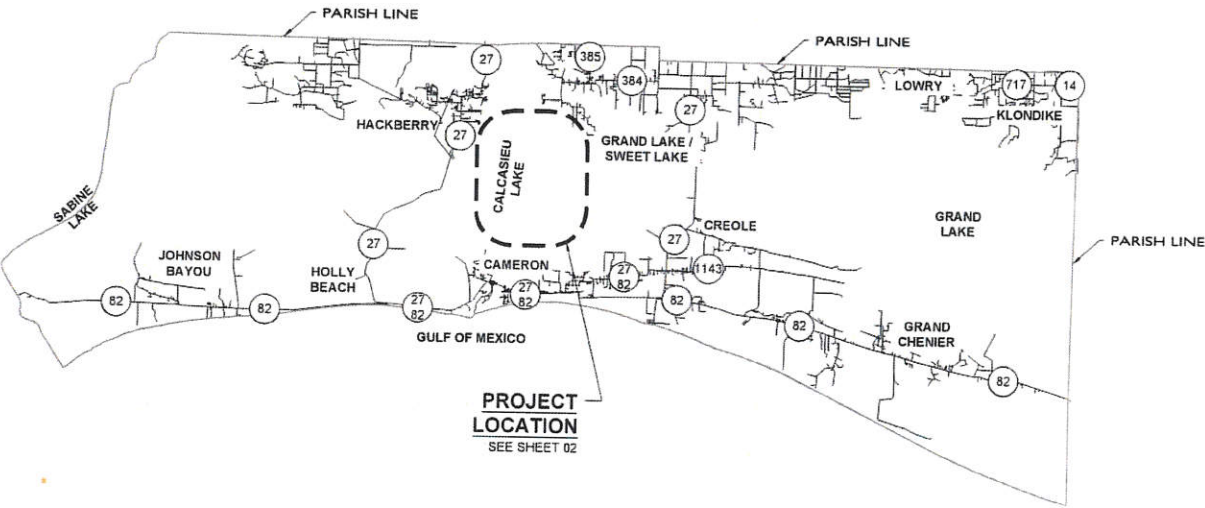

[Signature]
OPERATIONS ASSISTANT ADMINISTRATOR
[Signature]
REGIONAL MANAGER, OPERATIONS DIVISION
[Signature]
PROJECT ENGINEER, OPERATIONS DIVISION

TYPE OF CONSTRUCTION																																																																																																																																																																																																																																																																																																																																																																																																																																																																																																																																																																																																																																																																																																																																																																																																																																																																																																																																																																																																																																																																																																																																																																																																																																																																																																																																																																																																																																																																																																																																																																																																																																																	</
----------------------	--	--	--	--	--	--	--	--	--	--	--	--	--	--	--	--	--	--	--	--	--	--	--	--	--	--	--	--	--	--	--	--	--	--	--	--	--	--	--	--	--	--	--	--	--	--	--	--	--	--	--	--	--	--	--	--	--	--	--	--	--	--	--	--	--	--	--	--	--	--	--	--	--	--	--	--	--	--	--	--	--	--	--	--	--	--	--	--	--	--	--	--	--	--	--	--	--	--	--	--	--	--	--	--	--	--	--	--	--	--	--	--	--	--	--	--	--	--	--	--	--	--	--	--	--	--	--	--	--	--	--	--	--	--	--	--	--	--	--	--	--	--	--	--	--	--	--	--	--	--	--	--	--	--	--	--	--	--	--	--	--	--	--	--	--	--	--	--	--	--	--	--	--	--	--	--	--	--	--	--	--	--	--	--	--	--	--	--	--	--	--	--	--	--	--	--	--	--	--	--	--	--	--	--	--	--	--	--	--	--	--	--	--	--	--	--	--	--	--	--	--	--	--	--	--	--	--	--	--	--	--	--	--	--	--	--	--	--	--	--	--	--	--	--	--	--	--	--	--	--	--	--	--	--	--	--	--	--	--	--	--	--	--	--	--	--	--	--	--	--	--	--	--	--	--	--	--	--	--	--	--	--	--	--	--	--	--	--	--	--	--	--	--	--	--	--	--	--	--	--	--	--	--	--	--	--	--	--	--	--	--	--	--	--	--	--	--	--	--	--	--	--	--	--	--	--	--	--	--	--	--	--	--	--	--	--	--	--	--	--	--	--	--	--	--	--	--	--	--	--	--	--	--	--	--	--	--	--	--	--	--	--	--	--	--	--	--	--	--	--	--	--	--	--	--	--	--	--	--	--	--	--	--	--	--	--	--	--	--	--	--	--	--	--	--	--	--	--	--	--	--	--	--	--	--	--	--	--	--	--	--	--	--	--	--	--	--	--	--	--	--	--	--	--	--	--	--	--	--	--	--	--	--	--	--	--	--	--	--	--	--	--	--	--	--	--	--	--	--	--	--	--	--	--	--	--	--	--	--	--	--	--	--	--	--	--	--	--	--	--	--	--	--	--	--	--	--	--	--	--	--	--	--	--	--	--	--	--	--	--	--	--	--	--	--	--	--	--	--	--	--	--	--	--	--	--	--	--	--	--	--	--	--	--	--	--	--	--	--	--	--	--	--	--	--	--	--	--	--	--	--	--	--	--	--	--	--	--	--	--	--	--	--	--	--	--	--	--	--	--	--	--	--	--	--	--	--	--	--	--	--	--	--	--	--	--	--	--	--	--	--	--	--	--	--	--	--	--	--	--	--	--	--	--	--	--	--	--	--	--	--	--	--	--	--	--	--	--	--	--	--	--	--	--	--	--	--	--	--	--	--	--	--	--	--	--	--	--	--	--	--	--	--	--	--	--	--	--	--	--	--	--	--	--	--	--	--	--	--	--	--	--	--	--	--	--	--	--	--	--	--	--	--	--	--	--	--	--	--	--	--	--	--	--	--	--	--	--	--	--	--	--	--	--	--	--	--	--	--	--	--	--	--	--	--	--	--	--	--	--	--	--	--	--	--	--	--	--	--	--	--	--	--	--	--	--	--	--	--	--	--	--	--	--	--	--	--	--	--	--	--	--	--	--	--	--	--	--	--	--	--	--	--	--	--	--	--	--	--	--	--	--	--	--	--	--	--	--	--	--	--	--	--	--	--	--	--	--	--	--	--	--	--	--	--	--	--	--	--	--	--	--	--	--	--	--	--	--	--	--	--	--	--	--	--	--	--	--	--	--	--	--	--	--	--	--	--	--	--	--	--	--	--	--	--	--	--	--	--	--	--	--	--	--	--	--	--	--	--	--	--	--	--	--	--	--	--	--	--	--	--	--	--	--	--	--	--	--	--	--	--	--	--	--	--	--	--	--	--	--	--	--	--	--	--	--	--	--	--	--	--	--	--	--	--	--	--	--	--	--	--	--	--	--	--	--	--	--	--	--	--	--	--	--	--	--	--	--	--	--	--	--	--	--	--	--	--	--	--	--	--	--	--	--	--	--	--	--	--	--	--	--	--	--	--	--	--	--	--	--	--	--	--	--	--	--	--	--	--	--	--	--	--	--	--	--	--	--	--	--	--	--	--	--	--	--	--	--	--	--	--	--	--	--	--	--	--	--	--	--	--	--	--	--	--	--	--	--	--	--	--	--	--	--	--	--	--	--	--	--	--	--	--	--	--	--	--	--	--	--	--	--	--	--	--	--	--	--	--	--	--	--	--	--	--	--	--	--	--	--	--	--	--	--	--	--	--	--	--	--	--	--	--	--	--	--	--	--	--	--	--	--	--	--	--	--	--	--	--	--	--	--	--	--	--	--	--	--	--	--	--	--	--	--	--	--	--	--	--	--	--	--	--	--	--	--	--	--	--	--	--	--	--	--	--	--	--	--	--	--	--	--	--	--	--	--	--	--	--	--	--	--	--	--	--	--	--	--	--	--	--	--	--	--	--	--	--	--	--	--	--	--	--	--	--	--	--	--	--	--	--	--	--	--	--	--	--	--	--	--	--	--	--	--	--	--	--	--	--	--	--	--	--	--	--	--	--	--	--	--	--	--	--	--	--	--	--	--	--	--	--	--	--	--	--	--	--	--	--	--	--	--	--	--	--	--	--	--	--	--	--	--	--	--	--	--	--	--	--	--	--	--	--	--	--	--	--	--	--	--	--	--	--	--	--	--	--	--	--	--	--	--	--	--	--	--	--	--	--	--	--	--	--	--	--	--	--	--	--	--	--	--	--	--	--	--	--	--	--	--	--	--	--	--	--	--	--	--	--	--	--	--	--	--	--	--	--	--	--	--	--	--	--	--	--	--	--	--	--	--	--	--	--	--	--	--	--	--	--	--	--	--	--	--	--	--	--	--	--	--	--	--	--	--	--	--	--	--	--	--	--	--	--	--	--	--	--	--	--	--	--	--	--	--	--	--	--	--	--	--	--	--	--	--	--	--	--	--	--	--	--	--	--	--	--	--	--	--	--	--	--	--	--	--	--	--	--	--	--	--	--	--	--	--	--	--	--	--	--	--	--	--	--	--	--	--	--	--	--	--	--	--	--	--	--	--	--	--	--	--	--	--	--	--	--	--	--	--	--	--	--	--	--	--	--	--	--	--	--	--	--	--	--	--	--	--	--	--	--	--	--	--	--	--	--	--	--	--	--	--	--	--	--	--	--	--	--	--	--	--	--	--	--	--	--	--	--	--	--	--	--	--	--	--	--	--	--	--	--	--	--	--	--	--	--	--	--	--	--	--	--	--	--	--	--	--	--	--	--	--	--	--	--	--	--	--	--	--	--	--	--	--	--	--	--	--	--	--	--	--	--	--	--	--	--	--	--	--	--	--	--	--	--	--	--	--	--	--	--	--	--	--	--	--	--	--	--	--	--	--	--	--	--	--	--	--	--	--	--	--	--	--	--	--	--	--	--	--	--	--	--	--	--	--	--	--	--	--	--	--	--	--	--	--	--	--	--	--	--	--	--	--	--	--	--	--	--	--	--	--	--	--	--	--	--	--	--	--	--	--	--	--	--	--	----



NOTES:

- ALL ELEVATIONS, COORDINATES, AND STATION NUMBERS ARE EXPRESSED IN TERMS OF FEET, UNLESS OTHERWISE DENOTED.
- ALL VERTICAL POSITIONS ARE REFERENCED TO THE NORTH AMERICAN VERTICAL DATUM OF 1988 (NAVD88). CORS2011 EPOCH 2010, GEOID 12A, AND HORIZONTAL POSITIONS ARE REFERENCED TO THE NORTH AMERICAN DATUM OF 1983 (NAD 83)
- SURVEY CONTROL FOR ALL WORK PERFORMED UNDER THIS CONTRACT SHALL BE SURVEY MONUMENTS "CRMSCS-SM-10A" AND/OR "CRMSCS-SM-10"
- ALL SURVEY DATA USED TO PREPARE THESE DRAWINGS WAS COLLECTED BETWEEN SEPTEMBER AND DECEMBER OF 2013. THE PROJECT SITES ARE LOCATED IN A DYNAMIC COASTAL ENVIRONMENT WHICH CAN UNDERGO SIGNIFICANT ENVIRONMENTAL CHANGES OVER SHORT TIME PERIODS. CONTRACTOR SHALL NOT TAKE ADVANTAGE OF THE STATE FOR ACTUAL SITE CONDITIONS VARYING FROM THE EXISTING CONDITIONS SHOWN IN THESE DRAWINGS.
- CONTRACTOR SHALL CONTACT LA ONE CALL PRIOR TO MOBILIZING TO THE PROJECT SITES.

REV.	DATE	DESCRIPTION	BY



LONNIE G. HARPER
 and Associates, Inc.
 CIVIL ENGINEERING
 AND LAND SURVEYING
 2746 Hwy 384, Bell City, Louisiana 70630
 PHONE: (337) 905-1079 FAX: (337) 905-1076

COASTAL PROTECTION AND
 RESTORATION AUTHORITY

450 LAUREL STREET
 BATON ROUGE, LOUISIANA 70801

DRAWN BY: AARON HARPER

DESIGNED BY: CHRIS WHEAT, PE

CAMERON-CREOLE LEVEE
 LAKESHORE PROTECTION PROJECT

STATE PROJECT NUMBER: CS-04-A

FEDERAL PROJECT NUMBER:

APPROVED BY: LONNIE HARPER, PE

PROJECT
 LOCATION

DATE: 12/01/2015

SHEET 02 OF 19

NOTE:

REFER TO SHEET 03 FOR ALL ACCESS ROUTE LOCATIONS.





MARINE ACCESS ROUTE POINT DATA

POINT NUMBER	NORTHING	EASTING	LATITUDE	LONGITUDE	DESCRIPTION
PT. NO. 1	506122.38	2644112.44	29°52'35.00"	93°20'33.00"	BEGIN ACCESS ROUTE NO. 1
PT. NO. 2	505686.70	2669462.63	29°52'35.00"	93°15'45.00"	END ACCESS ROUTE NO. 1
PT. NO. 3	523486.44	2670456.80	29°55'31.34"	93°15'37.10"	END ACCESS ROUTE NO. 2
PT. NO. 4	512526.83	2676986.69	29°53'43.95"	93°14'20.83"	END ACCESS ROUTE NO. 3
PT. NO. 5	499932.82	2674357.92	29°51'38.86"	93°14'48.30"	END ACCESS ROUTE NO. 4
PT. NO. 6	523486.44	2677457.50	29°55'32.50"	93°14'17.55"	END ACCESS ROUTE NO. 5
PT. NO. 7	511979.67	2679056.28	29°53'38.87"	93°13'57.22"	END ACCESS ROUTE NO. 6
PT. NO. 8	500731.48	2677456.65	29°51'47.27"	93°14'13.27"	END ACCESS ROUTE NO. 7
PT. NO. 9	495679.85	2673991.19	29°50'56.70"	93°14'51.66"	END ACCESS ROUTE NO. 8

BID ITEM SUMMARY

ITEM NO.	DESCRIPTION	UNIT OF MEASURE	QUANTITY
1	MOBILIZATION AND DEMOBILIZATION	LUMP SUM	N/A
2	TEMPORARY SIGNS AND BARRICADES	LUMP SUM	N/A
3	GRAND BAYOU WCS 55# CLASS RIPRAP	TONS	3,010
4	GRAND BAYOU WCS GEOTEXTILE REINFORCEMENT	SQUARE YARDS	3,670
5	MANGROVE BAYOU WCS 55# CLASS RIPRAP	TONS	2,705
6	MANGROVE BAYOU WCS GEOTEXTILE REINFORCEMENT	SQUARE YARDS	4,776
7	PECONI BAYOU WCS 55# CLASS RIPRAP	TONS	2,957
8	PECONI BAYOU WCS GEOTEXTILE REINFORCEMENT	SQUARE YARDS	4,217
9	HAZARD LINES (GRAND BAYOU WCS)	EACH	2
10	SELECT FILL (GRAND BAYOU WCS)	CUBIC YARDS	5
11	CONSTRUCTION SURVEYS	LUMP SUM	N/A
	ADDITIVE ALTERNATE NO. 1		
12	GRAND BAYOU WCS 55# CLASS RIPRAP	TONS	1,680
13	GRAND BAYOU WCS GEOTEXTILE REINFORCEMENT	SQUARE YARDS	1,667
	ADDITIVE ALTERNATE NO. 2		
14	PECONI BAYOU WCS 55# CLASS RIPRAP	TONS	1,180
15	PECONI BAYOU WCS GEOTEXTILE REINFORCEMENT	SQUARE YARDS	1,158
	ADDITIVE ALTERNATE NO. 3		
16	MANGROVE BAYOU WCS 55# CLASS RIPRAP	TONS	896
17	MANGROVE BAYOU WCS GEOTEXTILE REINFORCEMENT	SQUARE YARDS	922

NOTES:

1. ALL ELEVATIONS, COORDINATES, AND STATION NUMBERS ARE EXPRESSED IN TERMS OF FEET, UNLESS OTHERWISE DENOTED.
2. ALL VERTICAL POSITIONS ARE REFERENCED TO THE NORTH AMERICAN VERTICAL DATUM OF 1988 (NAVDS88). CORS2011 EPOCH 2010, GEOID 12A, AND HORIZONTAL POSITIONS ARE REFERENCED TO THE NORTH AMERICAN DATUM OF 1983 (NAD 83)
3. SURVEY CONTROL FOR ALL WORK PERFORMED UNDER THIS CONTRACT SHALL BE SURVEY MONUMENTS "CRMSCS-SM-10A" AND/OR "CRMSCS-SM-10"
4. ALL SURVEY DATA USED TO PREPARE THESE DRAWINGS WAS COLLECTED BETWEEN SEPTEMBER AND DECEMBER OF 2013. THE PROJECT SITES ARE LOCATED IN A DYNAMIC COASTAL ENVIRONMENT WHICH CAN UNDERGO SIGNIFICANT ENVIRONMENTAL CHANGES OVER SHORT TIME PERIODS. CONTRACTOR SHALL NOT TAKE ADVANTAGE OF THE STATE FOR ACTUAL SITE CONDITIONS VARYING FROM THE EXISTING CONDITIONS SHOWN IN THESE DRAWINGS.
5. CONTRACTOR SHALL CONTACT LA ONE CALL PRIOR TO MOBILIZING TO THE PROJECT SITES.

REV.	DATE	DESCRIPTION	BY



LONNIE G. HARPER
 and Associates, Inc.
 CIVIL ENGINEERING
 AND LAND SURVEYING
 2746 Hwy 384, Bell City, Louisiana 70630
 PHONE: (337) 905-1079 FAX: (337) 905-1076



MARINE ACCESS ROUTES

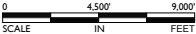

COASTAL PROTECTION AND RESTORATION AUTHORITY 450 LAUREL STREET BATON ROUGE, LOUISIANA 70801		CAMERON-CREOLE LEVEE LAKESHORE PROTECTION PROJECT		MARINE ACCESS ROUTE PLAN
		STATE PROJECT NUMBER: CS-04-A		
				FEDERAL PROJECT NUMBER:
DRAWN BY: AARON HARPER	DESIGNED BY: CHRIS WHEAT, PE	APPROVED BY: LONNIE HARPER, PE		SHEET 03 OF 19

ELEVATION NAVD 88

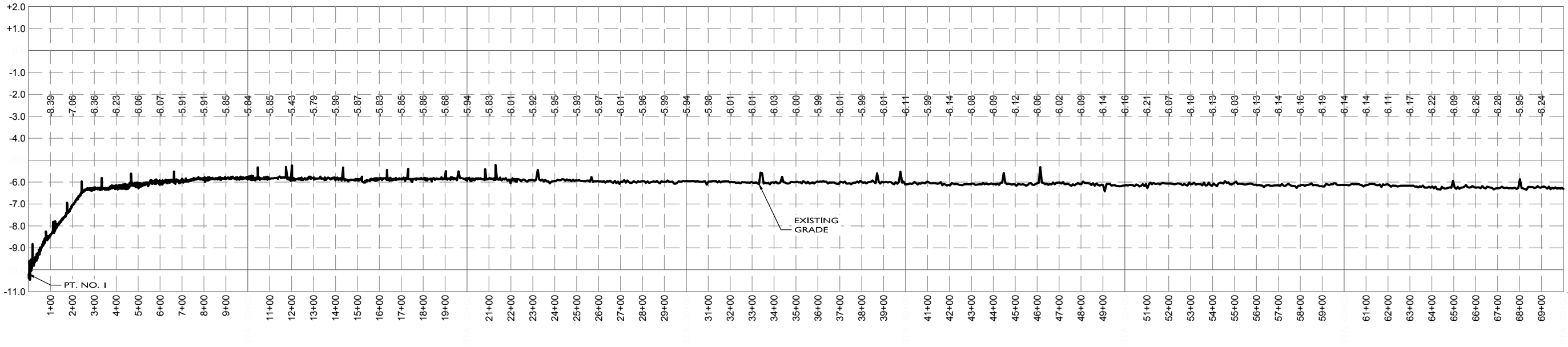

ELEVATION NAVD 88

ACCESS ROUTE NO. 1
PROFILE VIEW



ELEVATION NAVD 88

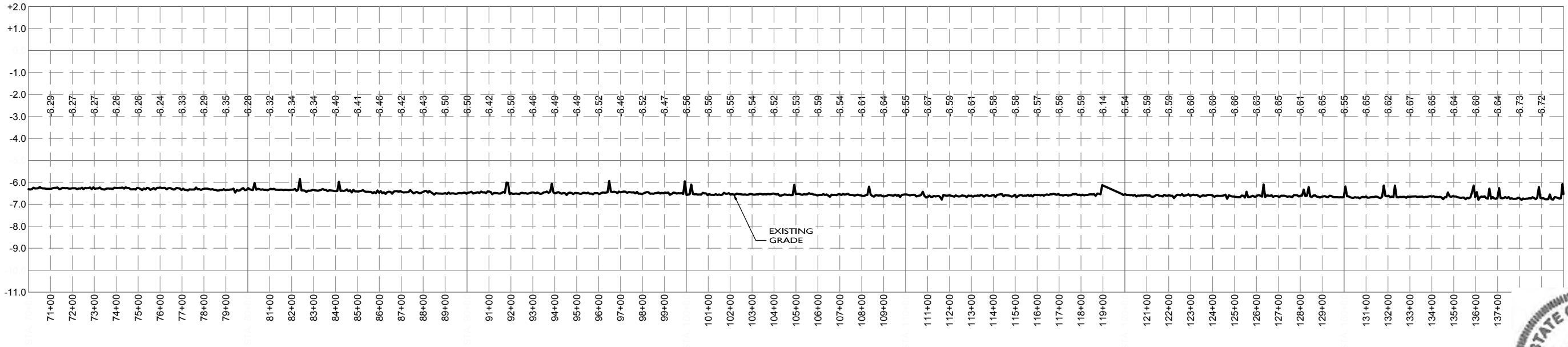

ELEVATION NAVD 88

ACCESS ROUTE NO. 1
PROFILE VIEW



NOTES:

- ALL ELEVATIONS, COORDINATES, AND STATION NUMBERS ARE EXPRESSED IN TERMS OF FEET, UNLESS OTHERWISE DENOTED.
- ALL VERTICAL POSITIONS ARE REFERENCED TO THE NORTH AMERICAN VERTICAL DATUM OF 1988 (NAVD88). CORS2011 EPOCH 2010, GEOID 12A, AND HORIZONTAL POSITIONS ARE REFERENCED TO THE NORTH AMERICAN DATUM OF 1983 (NAD 83).
- SURVEY CONTROL FOR ALL WORK PERFORMED UNDER THIS CONTRACT SHALL BE SURVEY MONUMENTS "CRMSCS-SM-10A" AND/OR "CRMSCS-SM-10".
- ALL SURVEY DATA USED TO PREPARE THESE DRAWINGS WAS COLLECTED BETWEEN SEPTEMBER AND DECEMBER OF 2013. THE PROJECT SITES ARE LOCATED IN A DYNAMIC COASTAL ENVIRONMENT WHICH CAN UNDERGO SIGNIFICANT ENVIRONMENTAL CHANGES OVER SHORT TIME PERIODS. CONTRACTOR SHALL NOT TAKE ADVANTAGE OF THE STATE FOR ACTUAL SITE CONDITIONS VARYING FROM THE EXISTING CONDITIONS SHOWN IN THESE DRAWINGS.
- CONTRACTOR SHALL CONTACT LA ONE CALL PRIOR TO MOBILIZING TO THE PROJECT SITES.

REV.	DATE	DESCRIPTION	BY



LONNIE G. HARPER
and Associates, Inc.
CIVIL ENGINEERING
AND LAND SURVEYING
2746 Hwy 384, Bell City, Louisiana 70630
PHONE: (337) 905-1079 FAX: (337) 905-1076

COASTAL PROTECTION AND
RESTORATION AUTHORITY

450 LAUREL STREET
BATON ROUGE, LOUISIANA 70801

DRAWN BY: AARON HARPER

DESIGNED BY: CHRIS WHEAT, PE

CAMERON-CREOLE LEVEE
LAKESHORE PROTECTION PROJECT

STATE PROJECT NUMBER: CS-04-A

FEDERAL PROJECT NUMBER:

APPROVED BY: LONNIE HARPER, PE

MARINE ACCESS
ROUTE PROFILE

DATE: 12/01/2015

SHEET 04 OF 19



ELEVATION NAVD 88

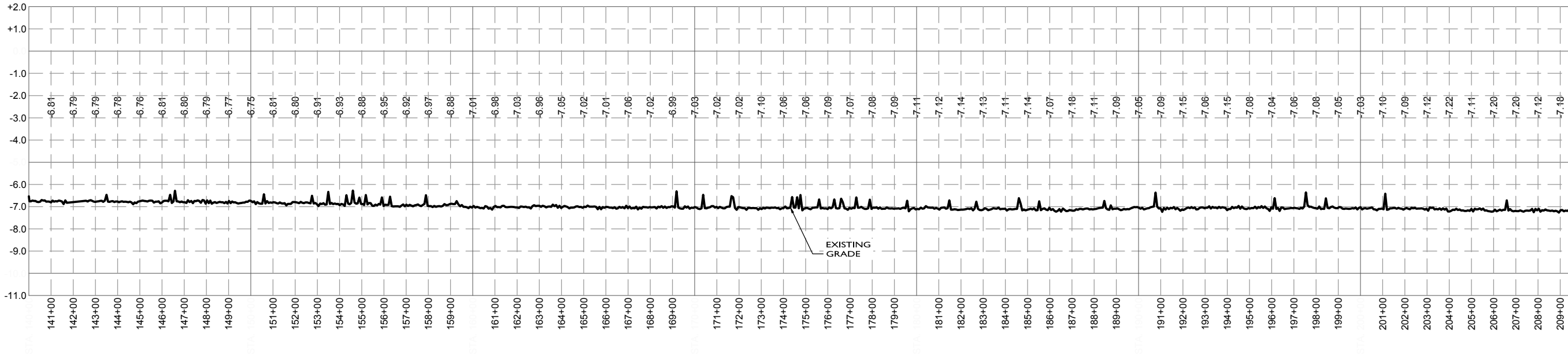

ACCESS ROUTE NO. 1
PROFILE VIEW



ELEVATION NAVD 88

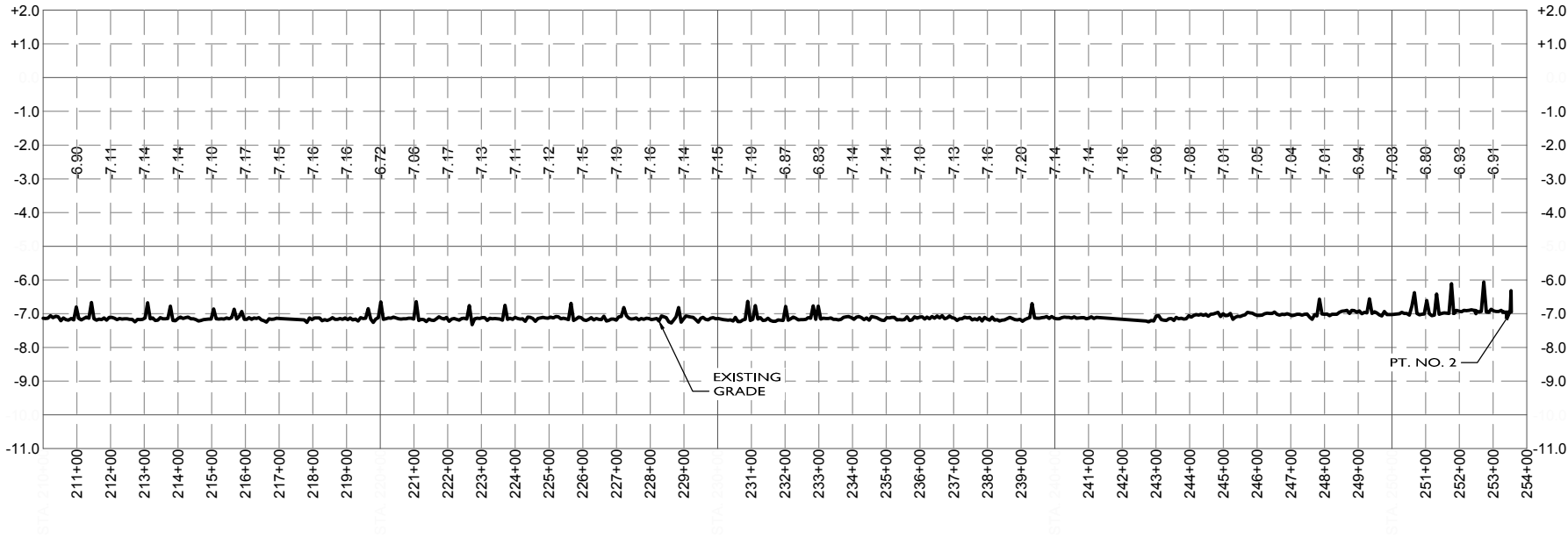

ACCESS ROUTE NO. 1
PROFILE VIEW



NOTES:

- ALL ELEVATIONS, COORDINATES, AND STATION NUMBERS ARE EXPRESSED IN TERMS OF FEET, UNLESS OTHERWISE DENOTED.
- ALL VERTICAL POSITIONS ARE REFERENCED TO THE NORTH AMERICAN VERTICAL DATUM OF 1988 (NAVD88). CHRS2011 EPOCH 2010, GEOID 12A, AND HORIZONTAL POSITIONS ARE REFERENCED TO THE NORTH AMERICAN DATUM OF 1983 (NAD 83)
- SURVEY CONTROL FOR ALL WORK PERFORMED UNDER THIS CONTRACT SHALL BE SURVEY MONUMENTS "CRMSCS-SM-10A" AND/OR "CRMSCS-SM-10"
- ALL SURVEY DATA USED TO PREPARE THESE DRAWINGS WAS COLLECTED BETWEEN SEPTEMBER AND DECEMBER OF 2013. THE PROJECT SITES ARE LOCATED IN A DYNAMIC COASTAL ENVIRONMENT WHICH CAN UNDERGO SIGNIFICANT ENVIRONMENTAL CHANGES OVER SHORT TIME PERIODS. CONTRACTOR SHALL NOT TAKE ADVANTAGE OF THE STATE FOR ACTUAL SITE CONDITIONS VARYING FROM THE EXISTING CONDITIONS SHOWN IN THESE DRAWINGS.
- CONTRACTOR SHALL CONTACT LA ONE CALL PRIOR TO MOBILIZING TO THE PROJECT SITES.

REV.	DATE	DESCRIPTION	BY



LONNIE G. HARPER
and Associates, Inc.
CIVIL ENGINEERING
AND LAND SURVEYING
2746 Hwy 384, Bell City, Louisiana 70630
PHONE: (337) 905-1079 FAX: (337) 905-1076

COASTAL PROTECTION AND
RESTORATION AUTHORITY

450 LAUREL STREET
BATON ROUGE, LOUISIANA 70801

DRAWN BY: AARON HARPER

DESIGNED BY: CHRIS WHEAT, PE

CAMERON-CREOLE LEVEE
LAKESHORE PROTECTION PROJECT

STATE PROJECT NUMBER: CS-04-A

FEDERAL PROJECT NUMBER:

APPROVED BY: LONNIE HARPER, PE



MARINE ACCESS
ROUTE PROFILE

DATE: 12/01/2015

SHEET 05 OF 19

ELEVATION NAVD 88

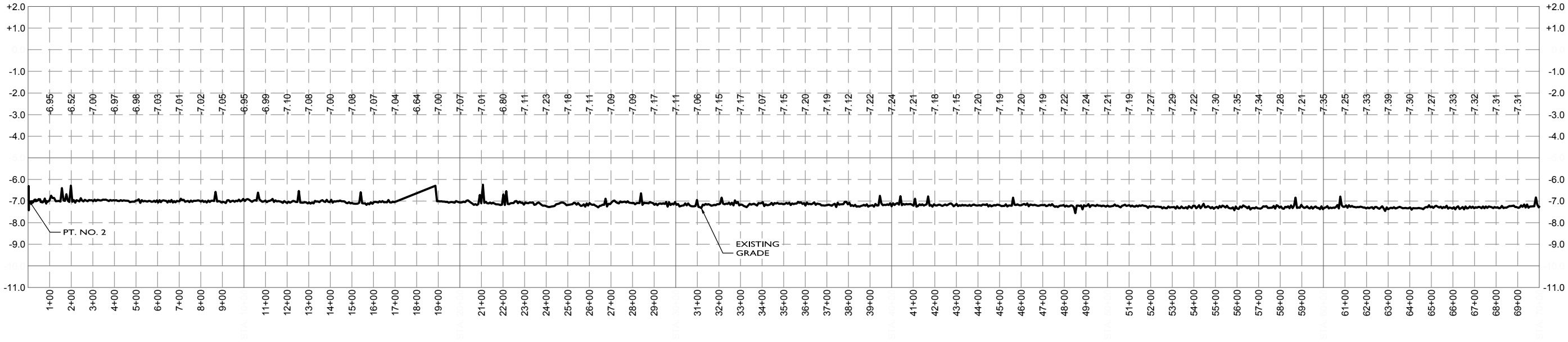

ELEVATION NAVD 88

ACCESS ROUTE NO. 2
PROFILE VIEW



ELEVATION NAVD 88

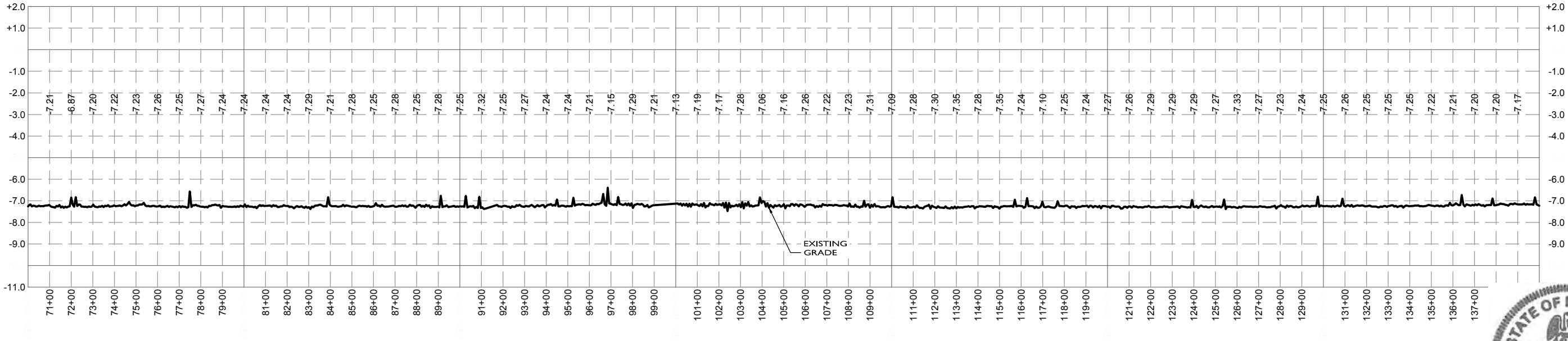

ELEVATION NAVD 88

ACCESS ROUTE NO. 2
PROFILE VIEW



NOTES:

- ALL ELEVATIONS, COORDINATES, AND STATION NUMBERS ARE EXPRESSED IN TERMS OF FEET, UNLESS OTHERWISE DENOTED.
- ALL VERTICAL POSITIONS ARE REFERENCED TO THE NORTH AMERICAN VERTICAL DATUM OF 1988 (NAVD88). CORS2011 EPOCH 2010, GEOID 12A, AND HORIZONTAL POSITIONS ARE REFERENCED TO THE NORTH AMERICAN DATUM OF 1983 (NAD 83).
- SURVEY CONTROL FOR ALL WORK PERFORMED UNDER THIS CONTRACT SHALL BE SURVEY MONUMENTS "CRMSCS-SM-10A" AND/OR "CRMSCS-SM-10".
- ALL SURVEY DATA USED TO PREPARE THESE DRAWINGS WAS COLLECTED BETWEEN SEPTEMBER AND DECEMBER OF 2013. THE PROJECT SITES ARE LOCATED IN A DYNAMIC COASTAL ENVIRONMENT WHICH CAN UNDERGO SIGNIFICANT ENVIRONMENTAL CHANGES OVER SHORT TIME PERIODS. CONTRACTOR SHALL NOT TAKE ADVANTAGE OF THE STATE FOR ACTUAL SITE CONDITIONS VARYING FROM THE EXISTING CONDITIONS SHOWN IN THESE DRAWINGS.
- CONTRACTOR SHALL CONTACT LA ONE CALL PRIOR TO MOBILIZING TO THE PROJECT SITES.

REV.	DATE	DESCRIPTION	BY



LONNIE G. HARPER
and Associates, Inc.
CIVIL ENGINEERING
AND LAND SURVEYING
2746 Hwy 384, Bell City, Louisiana 70630
PHONE: (337) 905-1079 FAX: (337) 905-1076

COASTAL PROTECTION AND
RESTORATION AUTHORITY

450 LAUREL STREET
BATON ROUGE, LOUISIANA 70801

DRAWN BY: AARON HARPER

DESIGNED BY: CHRIS WHEAT, PE

CAMERON-CREOLE LEVEE
LAKESHORE PROTECTION PROJECT

STATE PROJECT NUMBER: CS-04-A

FEDERAL PROJECT NUMBER:

APPROVED BY: LONNIE HARPER, PE

MARINE ACCESS
ROUTE PROFILE

DATE: 12/01/2015

SHEET 06 OF 19



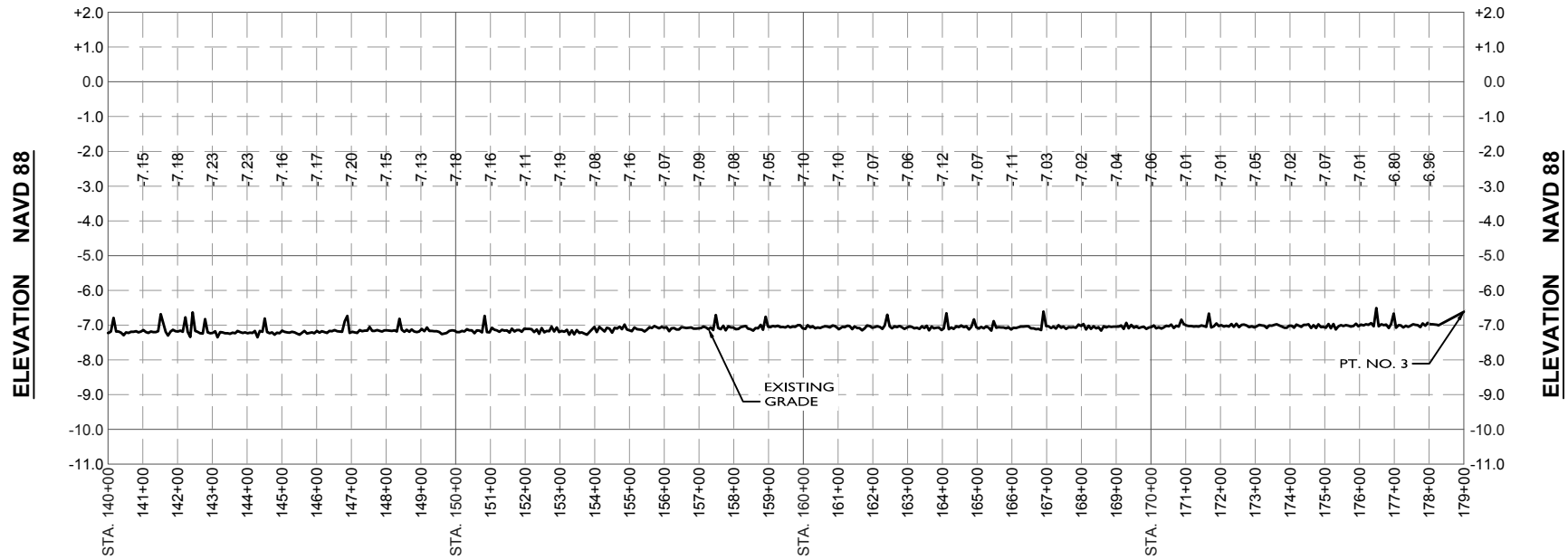

ACCESS ROUTE NO. 2
PROFILE VIEW

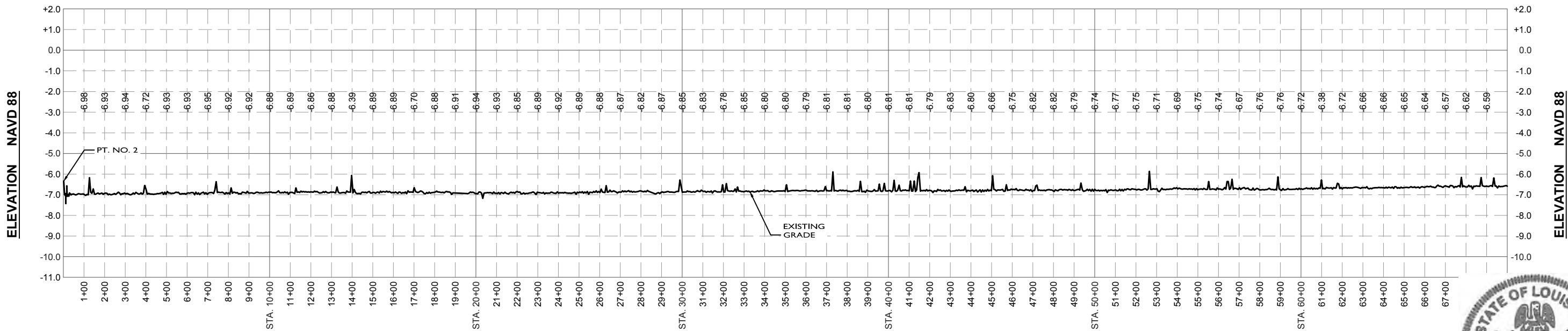
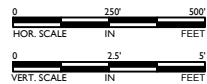

ACCESS ROUTE NO. 3
PROFILE VIEW

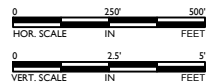

NOTES:

- ALL ELEVATIONS, COORDINATES, AND STATION NUMBERS ARE EXPRESSED IN TERMS OF FEET, UNLESS OTHERWISE DENOTED.
- ALL VERTICAL POSITIONS ARE REFERENCED TO THE NORTH AMERICAN VERTICAL DATUM OF 1988 (NAVD88). CORS2011 EPOCH 2010, GEOID 12A, AND HORIZONTAL POSITIONS ARE REFERENCED TO THE NORTH AMERICAN DATUM OF 1983 (NAD 83)
- SURVEY CONTROL FOR ALL WORK PERFORMED UNDER THIS CONTRACT SHALL BE SURVEY MONUMENTS "CRMSCS-SM-10A" AND/OR "CRMSCS-SM-10"
- ALL SURVEY DATA USED TO PREPARE THESE DRAWINGS WAS COLLECTED BETWEEN SEPTEMBER AND DECEMBER OF 2013. THE PROJECT SITES ARE LOCATED IN A DYNAMIC COASTAL ENVIRONMENT WHICH CAN UNDERGO SIGNIFICANT ENVIRONMENTAL CHANGES OVER SHORT TIME PERIODS. CONTRACTOR SHALL NOT TAKE ADVANTAGE OF THE STATE FOR ACTUAL SITE CONDITIONS VARYING FROM THE EXISTING CONDITIONS SHOWN IN THESE DRAWINGS.
- CONTRACTOR SHALL CONTACT LA ONE CALL PRIOR TO MOBILIZING TO THE PROJECT SITES.

REV.	DATE	DESCRIPTION	BY



LONNIE G. HARPER
and Associates, Inc.
CIVIL ENGINEERING
AND LAND SURVEYING
2746 Hwy 384, Bell City, Louisiana 70630
PHONE: (337) 905-1079 FAX: (337) 905-1076

COASTAL PROTECTION AND
RESTORATION AUTHORITY

450 LAUREL STREET
BATON ROUGE, LOUISIANA 70801

DRAWN BY: AARON HARPER

DESIGNED BY: CHRIS WHEAT, PE

CAMERON-CREOLE LEVEE
LAKESHORE PROTECTION PROJECT

STATE PROJECT NUMBER: CS-04-A

FEDERAL PROJECT NUMBER:

APPROVED BY: LONNIE HARPER, PE

MARINE ACCESS
ROUTE PROFILE

DATE: 12/01/2015

SHEET 07 OF 19



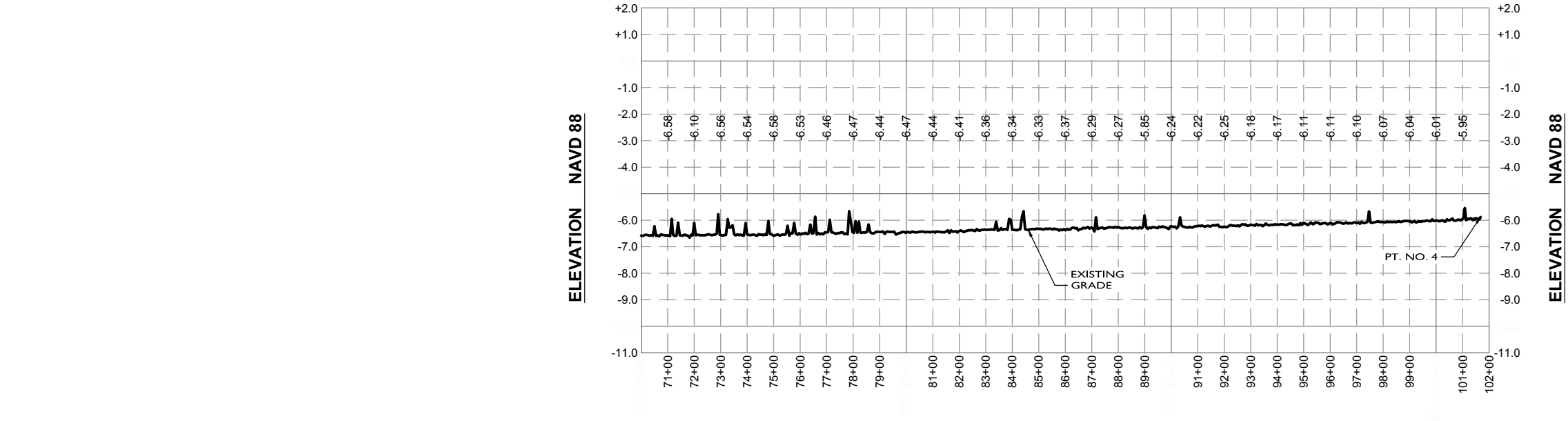

ACCESS ROUTE NO. 3
PROFILE VIEW

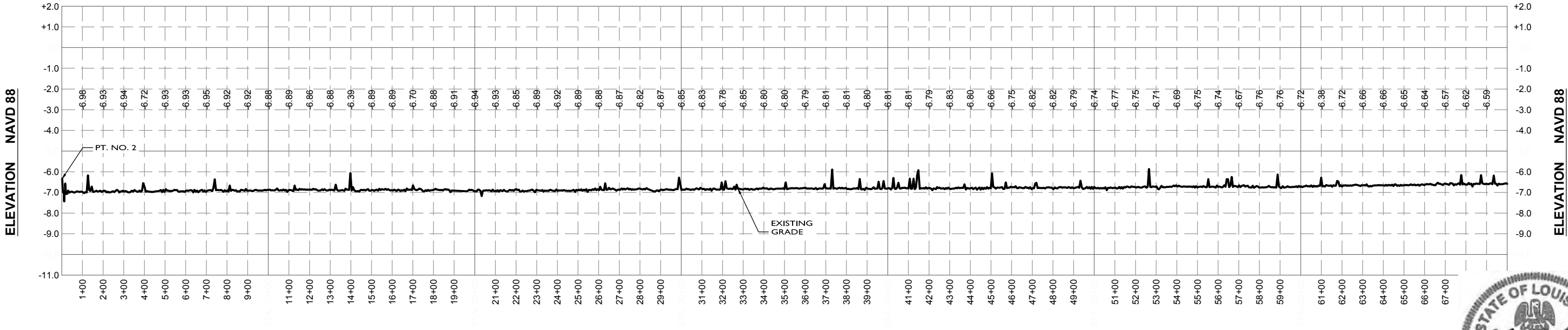

ACCESS ROUTE NO. 4
PROFILE VIEW



NOTES:

- ALL ELEVATIONS, COORDINATES, AND STATION NUMBERS ARE EXPRESSED IN TERMS OF FEET, UNLESS OTHERWISE DENOTED.
- ALL VERTICAL POSITIONS ARE REFERENCED TO THE NORTH AMERICAN VERTICAL DATUM OF 1988 (NAVD88). CORS2011 EPOCH 2010, GEOID 12A, AND HORIZONTAL POSITIONS ARE REFERENCED TO THE NORTH AMERICAN DATUM OF 1983 (NAD 83)
- SURVEY CONTROL FOR ALL WORK PERFORMED UNDER THIS CONTRACT SHALL BE SURVEY MONUMENTS "CRMSCS-SM-10A" AND/OR "CRMSCS-SM-10"
- ALL SURVEY DATA USED TO PREPARE THESE DRAWINGS WAS COLLECTED BETWEEN SEPTEMBER AND DECEMBER OF 2013. THE PROJECT SITES ARE LOCATED IN A DYNAMIC COASTAL ENVIRONMENT WHICH CAN UNDERGO SIGNIFICANT ENVIRONMENTAL CHANGES OVER SHORT TIME PERIODS. CONTRACTOR SHALL NOT TAKE ADVANTAGE OF THE STATE FOR ACTUAL SITE CONDITIONS VARYING FROM THE EXISTING CONDITIONS SHOWN IN THESE DRAWINGS.
- CONTRACTOR SHALL CONTACT LA ONE CALL PRIOR TO MOBILIZING TO THE PROJECT SITES.

REV.	DATE	DESCRIPTION	BY



LONNIE G. HARPER
 and Associates, Inc.
 CIVIL ENGINEERING
 AND LAND SURVEYING
 2746 Hwy 384, Bell City, Louisiana 70630
 PHONE: (337) 905-1079 FAX: (337) 905-1076

COASTAL PROTECTION AND RESTORATION AUTHORITY

450 LAUREL STREET
BATON ROUGE, LOUISIANA 70801

DRAWN BY: AARON HARPER

DESIGNED BY: CHRIS WHEAT, PE

CAMERON-CREOLE LEVEE
LAKESHORE PROTECTION PROJECT

STATE PROJECT NUMBER: CS-04-A

FEDERAL PROJECT NUMBER:

APPROVED BY: LONNIE HARPER, PE



MARINE ACCESS
ROUTE PROFILE

DATE: 12/01/2015

SHEET 08 OF 19

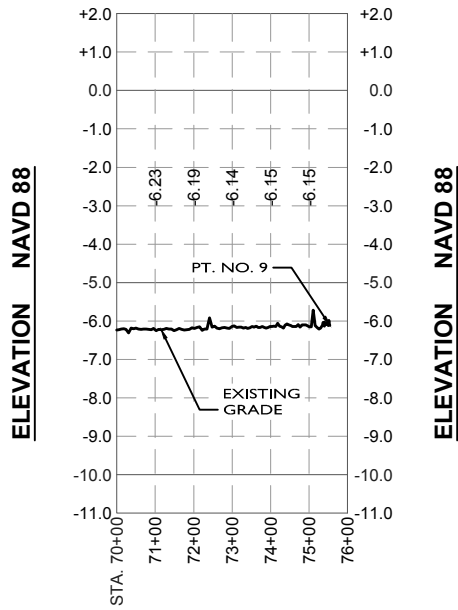

ACCESS ROUTE NO. 4
PROFILE VIEW

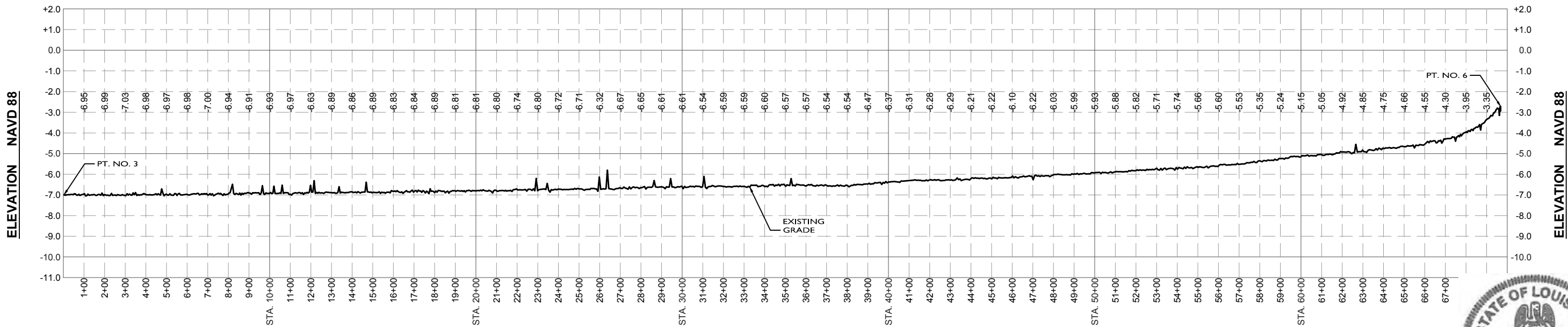

ACCESS ROUTE NO. 5
PROFILE VIEW

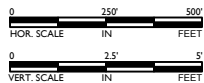

NOTES:

- ALL ELEVATIONS, COORDINATES, AND STATION NUMBERS ARE EXPRESSED IN TERMS OF FEET, UNLESS OTHERWISE DENOTED.
- ALL VERTICAL POSITIONS ARE REFERENCED TO THE NORTH AMERICAN VERTICAL DATUM OF 1988 (NAVD88). CORS2011 EPOCH 2010, GEOID 12A, AND HORIZONTAL POSITIONS ARE REFERENCED TO THE NORTH AMERICAN DATUM OF 1983 (NAD 83)
- SURVEY CONTROL FOR ALL WORK PERFORMED UNDER THIS CONTRACT SHALL BE SURVEY MONUMENTS "CRMSCS-SM-10A" AND/OR "CRMSCS-SM-10"
- ALL SURVEY DATA USED TO PREPARE THESE DRAWINGS WAS COLLECTED BETWEEN SEPTEMBER AND DECEMBER OF 2013. THE PROJECT SITES ARE LOCATED IN A DYNAMIC COASTAL ENVIRONMENT WHICH CAN UNDERGO SIGNIFICANT ENVIRONMENTAL CHANGES OVER SHORT TIME PERIODS. CONTRACTOR SHALL NOT TAKE ADVANTAGE OF THE STATE FOR ACTUAL SITE CONDITIONS VARYING FROM THE EXISTING CONDITIONS SHOWN IN THESE DRAWINGS.
- CONTRACTOR SHALL CONTACT LA ONE CALL PRIOR TO MOBILIZING TO THE PROJECT SITES.

REV.	DATE	DESCRIPTION	BY



LONNIE G. HARPER
and Associates, Inc.
CIVIL ENGINEERING
AND LAND SURVEYING
2746 Hwy 384, Bell City, Louisiana 70630
PHONE: (337) 905-1079 FAX: (337) 905-1076

COASTAL PROTECTION AND
RESTORATION AUTHORITY

450 LAUREL STREET
BATON ROUGE, LOUISIANA 70801

DRAWN BY: AARON HARPER

DESIGNED BY: CHRIS WHEAT, PE

CAMERON-CREOLE LEVEE
LAKESHORE PROTECTION PROJECT

STATE PROJECT NUMBER: CS-04-A

FEDERAL PROJECT NUMBER:

APPROVED BY: LONNIE HARPER, PE

MARINE ACCESS
ROUTE PROFILE

DATE: 12/01/2015

SHEET 09 OF 19



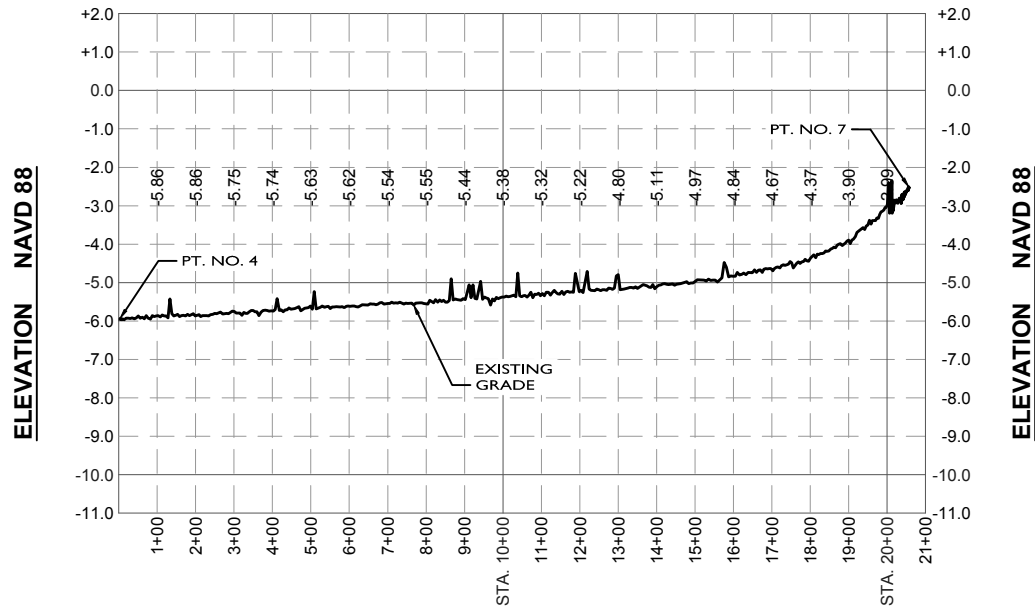

ACCESS ROUTE NO. 6
PROFILE VIEW

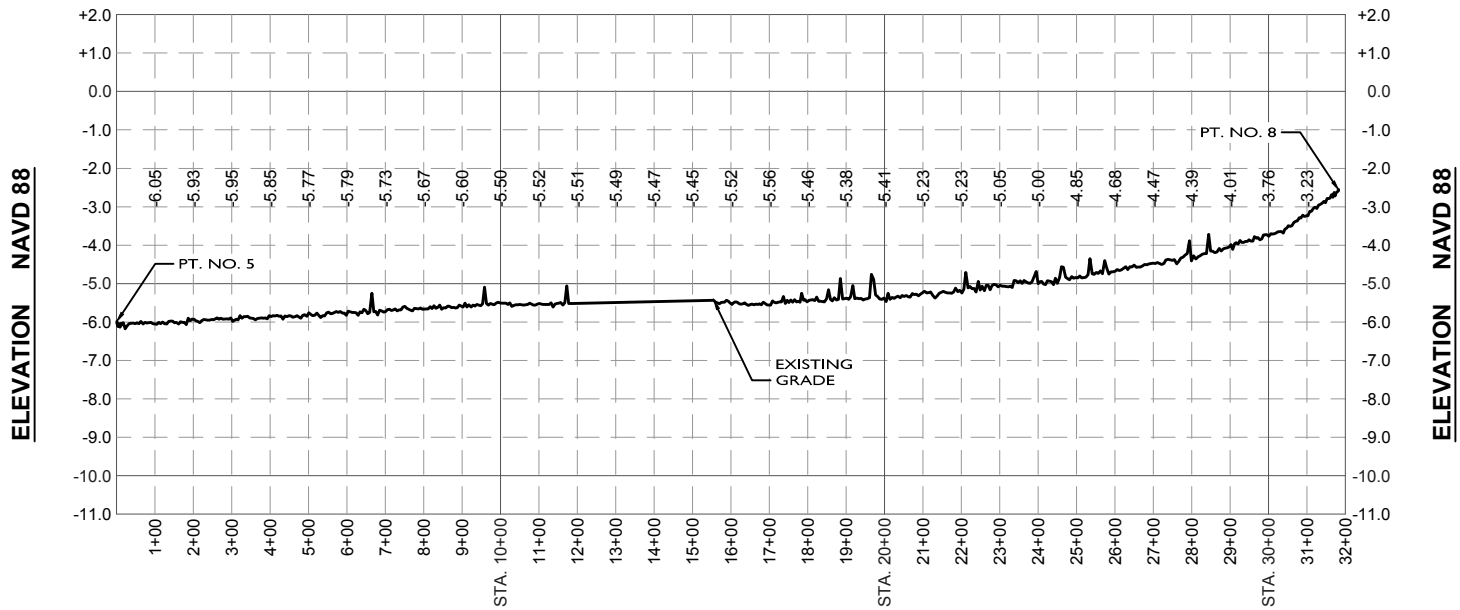

ACCESS ROUTE NO. 7
PROFILE VIEW

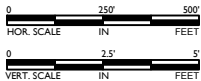

NOTES:

- ALL ELEVATIONS, COORDINATES, AND STATION NUMBERS ARE EXPRESSED IN TERMS OF FEET, UNLESS OTHERWISE DENOTED.
- ALL VERTICAL POSITIONS ARE REFERENCED TO THE NORTH AMERICAN VERTICAL DATUM OF 1988 (NAVD88). CORS2011 EPOCH 2010, GEOID 12A, AND HORIZONTAL POSITIONS ARE REFERENCED TO THE NORTH AMERICAN DATUM OF 1983 (NAD 83).
- SURVEY CONTROL FOR ALL WORK PERFORMED UNDER THIS CONTRACT SHALL BE SURVEY MONUMENTS "CRMSCS-SM-10A" AND/OR "CRMSCS-SM-10".
- ALL SURVEY DATA USED TO PREPARE THESE DRAWINGS WAS COLLECTED BETWEEN SEPTEMBER AND DECEMBER OF 2013. THE PROJECT SITES ARE LOCATED IN A DYNAMIC COASTAL ENVIRONMENT WHICH CAN UNDERGO SIGNIFICANT ENVIRONMENTAL CHANGES OVER SHORT TIME PERIODS. CONTRACTOR SHALL NOT TAKE ADVANTAGE OF THE STATE FOR ACTUAL SITE CONDITIONS VARYING FROM THE EXISTING CONDITIONS SHOWN IN THESE DRAWINGS.
- CONTRACTOR SHALL CONTACT LA ONE CALL PRIOR TO MOBILIZING TO THE PROJECT SITES.

REV.	DATE	DESCRIPTION	BY



LONNIE G. HARPER
and Associates, Inc.
CIVIL ENGINEERING
AND LAND SURVEYING
2746 Hwy 384, Bell City, Louisiana 70630
PHONE: (337) 905-1079 FAX: (337) 905-1076

COASTAL PROTECTION AND
RESTORATION AUTHORITY

450 LAUREL STREET
BATON ROUGE, LOUISIANA 70801

DRAWN BY: AARON HARPER

DESIGNED BY: CHRIS WHEAT, PE

CAMERON-CREOLE LEVEE
LAKESHORE PROTECTION PROJECT

STATE PROJECT NUMBER: CS-04-A

FEDERAL PROJECT NUMBER:

APPROVED BY: LONNIE HARPER, PE

MARINE ACCESS
ROUTE PROFILE

DATE: 12/01/2015

SHEET 10 OF 19



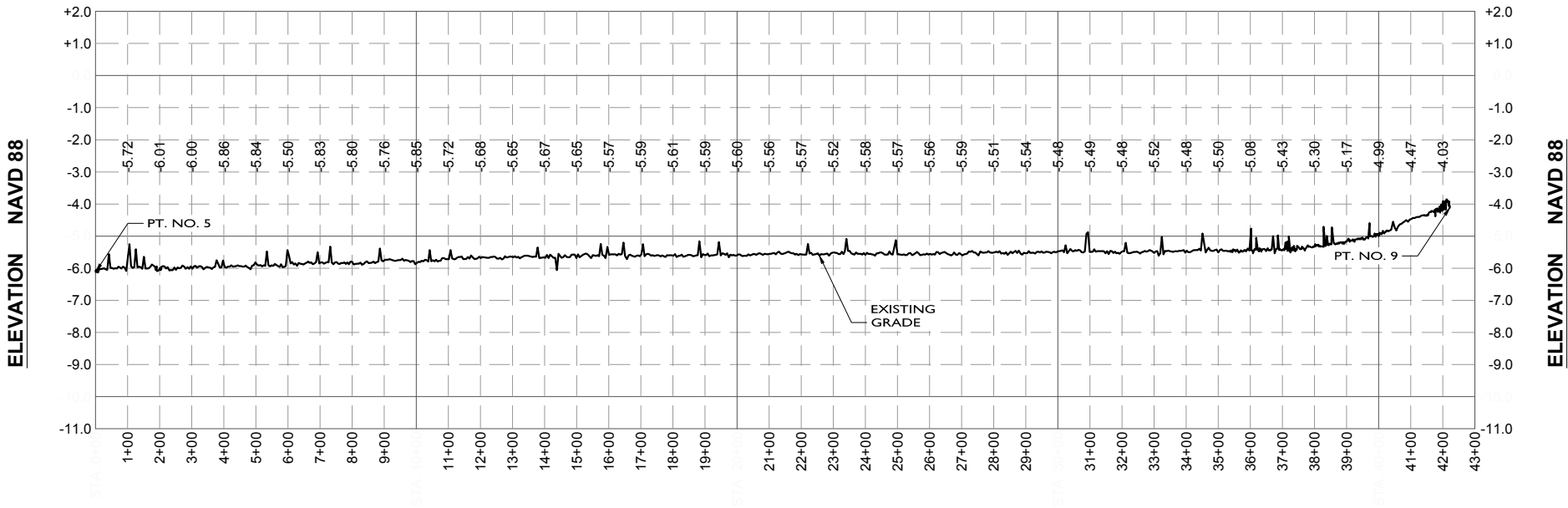

**ACCESS ROUTE NO. 8
PROFILE VIEW**

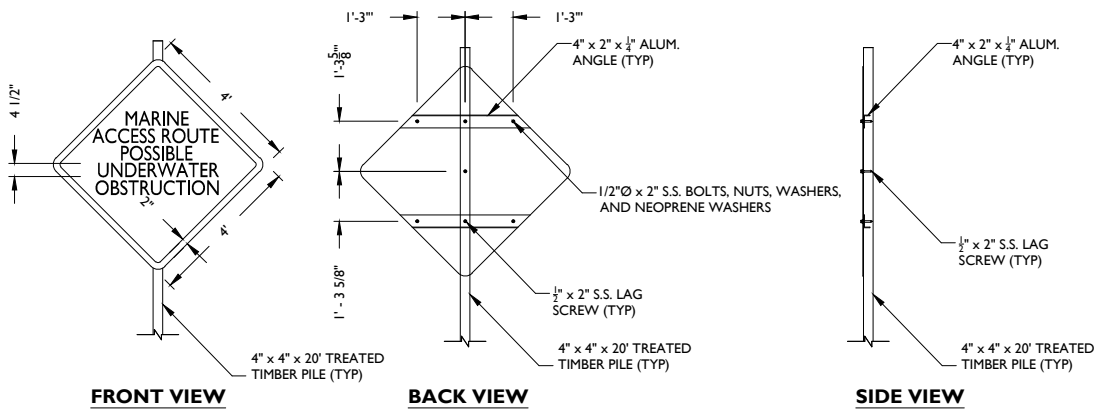

NOTE:
THE SIGN SHALL BE 0.1875" THICK,
CONSTRUCTED OF 6061-T6 OF 6063-T6 ALLOY,
AND CONFORM TO ASTM B209.

TYPICAL WARNING SIGN



NOTES:

- ALL ELEVATIONS, COORDINATES, AND STATION NUMBERS ARE EXPRESSED IN TERMS OF FEET, UNLESS OTHERWISE DENOTED.
- ALL VERTICAL POSITIONS ARE REFERENCED TO THE NORTH AMERICAN VERTICAL DATUM OF 1988 (NAVD88). CORS2011 EPOCH 2010, GEOID 12A, AND HORIZONTAL POSITIONS ARE REFERENCED TO THE NORTH AMERICAN DATUM OF 1983 (NAD 83)
- SURVEY CONTROL FOR ALL WORK PERFORMED UNDER THIS CONTRACT SHALL BE SURVEY MONUMENTS "CRMSCS-SM-10A" AND/OR "CRMSCS-SM-10"
- ALL SURVEY DATA USED TO PREPARE THESE DRAWINGS WAS COLLECTED BETWEEN SEPTEMBER AND DECEMBER OF 2013. THE PROJECT SITES ARE LOCATED IN A DYNAMIC COASTAL ENVIRONMENT WHICH CAN UNDERGO SIGNIFICANT ENVIRONMENTAL CHANGES OVER SHORT TIME PERIODS. CONTRACTOR SHALL NOT TAKE ADVANTAGE OF THE STATE FOR ACTUAL SITE CONDITIONS VARYING FROM THE EXISTING CONDITIONS SHOWN IN THESE DRAWINGS.
- CONTRACTOR SHALL CONTACT LA ONE CALL PRIOR TO MOBILIZING TO THE PROJECT SITES.

REV.	DATE	DESCRIPTION	BY



LONNIE G. HARPER
and Associates, Inc.
CIVIL ENGINEERING
AND LAND SURVEYING
2746 Hwy 384, Bell City, Louisiana 70630
PHONE: (337) 905-1079 FAX: (337) 905-1076

**COASTAL PROTECTION AND
RESTORATION AUTHORITY**

450 LAUREL STREET
BATON ROUGE, LOUISIANA 70801

DRAWN BY: AARON HARPER

DESIGNED BY: CHRIS WHEAT, PE

**CAMERON-CREOLE LEVEE
LAKESHORE PROTECTION PROJECT**

STATE PROJECT NUMBER: CS-04-A

FEDERAL PROJECT NUMBER:

APPROVED BY: LONNIE HARPER, PE

**MARINE ACCESS
ROUTE PROFILE**



DATE: 12/01/2015

SHEET 11 OF 19

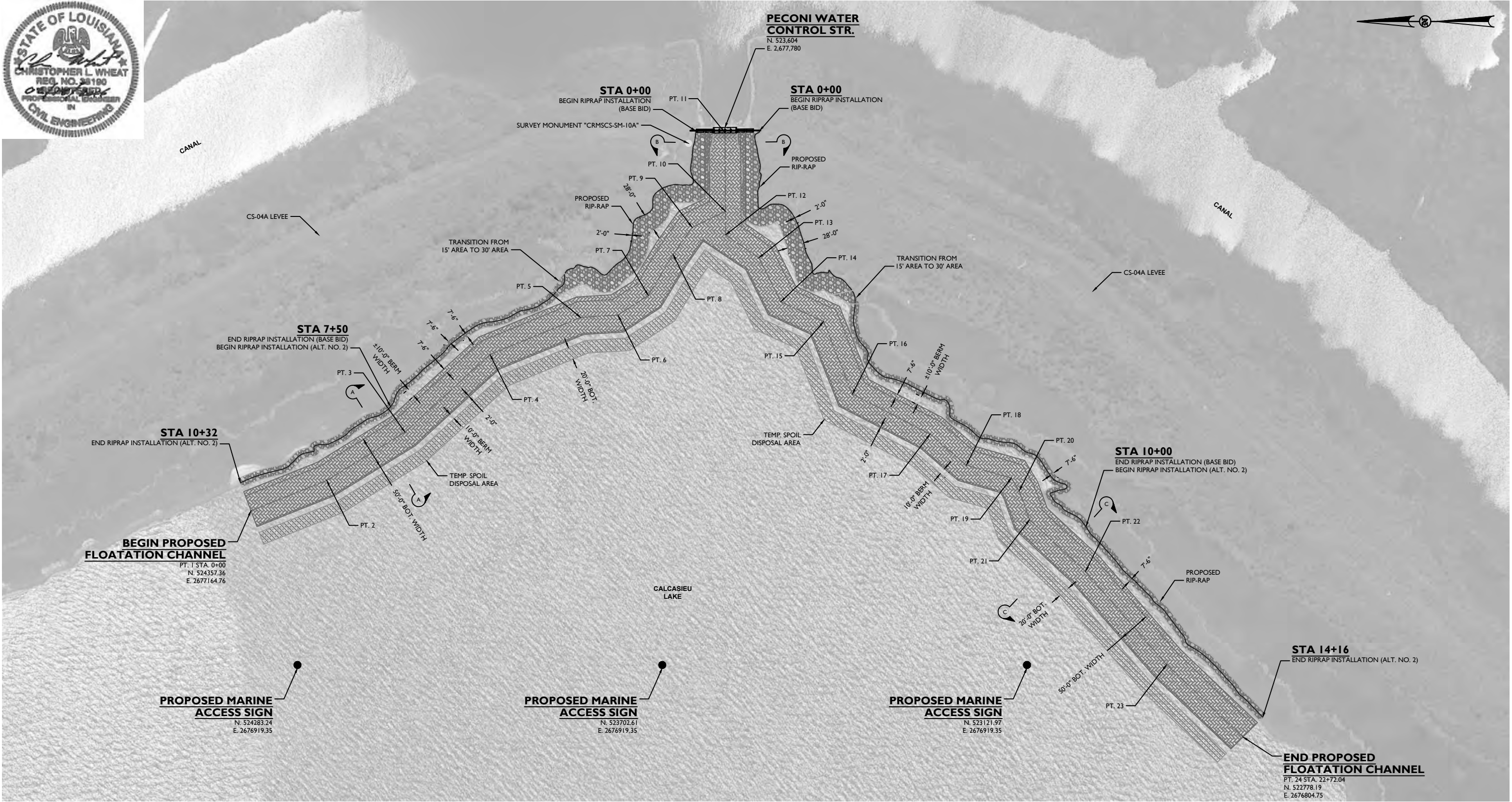

NOTES:

- ALL ELEVATIONS, COORDINATES, AND STATION NUMBERS ARE EXPRESSED IN TERMS OF FEET, UNLESS OTHERWISE DENOTED.
- ALL VERTICAL POSITIONS ARE REFERENCED TO THE NORTH AMERICAN VERTICAL DATUM OF 1988 (NAVD88). CORRS2011 EPOCH 2010, GEOID 12A, AND HORIZONTAL POSITIONS ARE REFERENCED TO THE NORTH AMERICAN DATUM OF 1983 (NAD 83)
- SURVEY CONTROL FOR ALL WORK PERFORMED UNDER THIS CONTRACT SHALL BE SURVEY MONUMENTS "CRMSCS-SM-10A" AND/OR "CRMSCS-SM-10"
- ALL SURVEY DATA USED TO PREPARE THESE DRAWINGS WAS COLLECTED BETWEEN SEPTEMBER AND DECEMBER OF 2013. THE PROJECT SITES ARE LOCATED IN A DYNAMIC COASTAL ENVIRONMENT WHICH CAN UNDERGO SIGNIFICANT ENVIRONMENTAL CHANGES OVER SHORT TIME PERIODS. CONTRACTOR SHALL NOT TAKE ADVANTAGE OF THE STATE FOR ACTUAL SITE CONDITIONS VARYING FROM THE EXISTING CONDITIONS SHOWN IN THESE DRAWINGS.
- CONTRACTOR SHALL CONTACT LA ONE CALL PRIOR TO MOBILIZING TO THE PROJECT SITES.

REV.	DATE	DESCRIPTION	BY



LONNIE G. HARPER
 and Associates, Inc.
 CIVIL ENGINEERING
 AND LAND SURVEYING
 2746 Hwy 384, Bell City, Louisiana 70630
 PHONE: (337) 905-1079 FAX: (337) 905-1076

COASTAL PROTECTION AND
 RESTORATION AUTHORITY

450 LAUREL STREET
 BATON ROUGE, LOUISIANA 70801

DRAWN BY: AARON HARPER

DESIGNED BY: CHRIS WHEAT, PE

CAMERON-CREOLE LEVEE
 LAKESHORE PROTECTION PROJECT

STATE PROJECT NUMBER: CS-04-A

FEDERAL PROJECT NUMBER:

APPROVED BY: LONNIE HARPER, PE

DETAIL "A"
 PECONI BAYOU

DATE: 12/01/2015

SHEET 12 OF 19

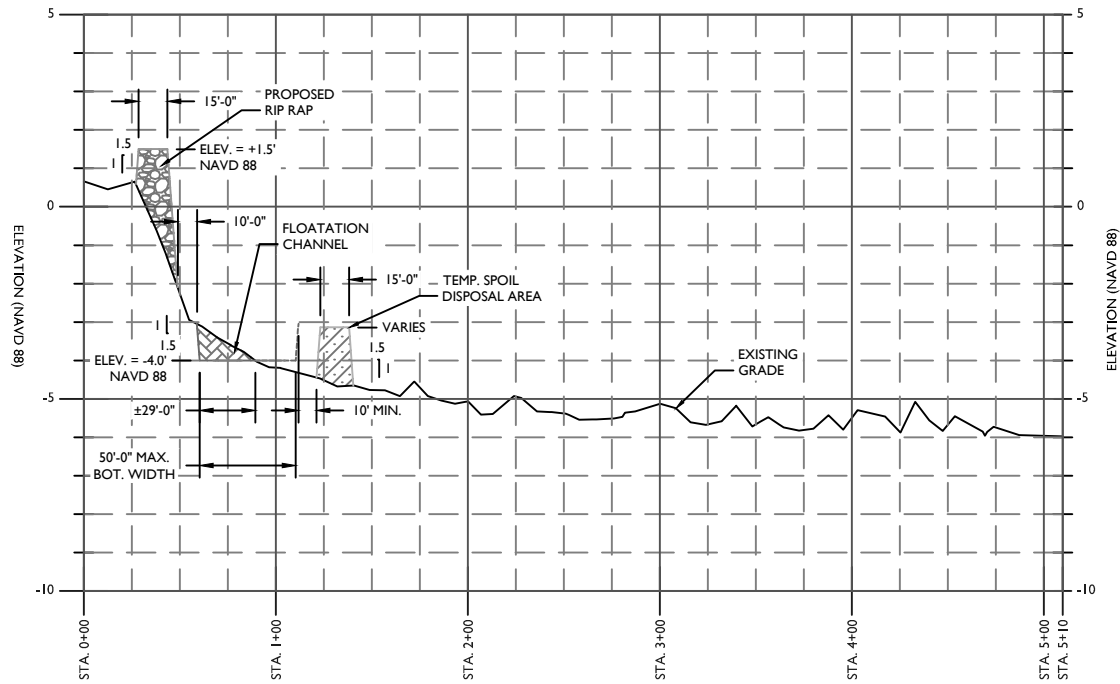

SECTION "A-A"

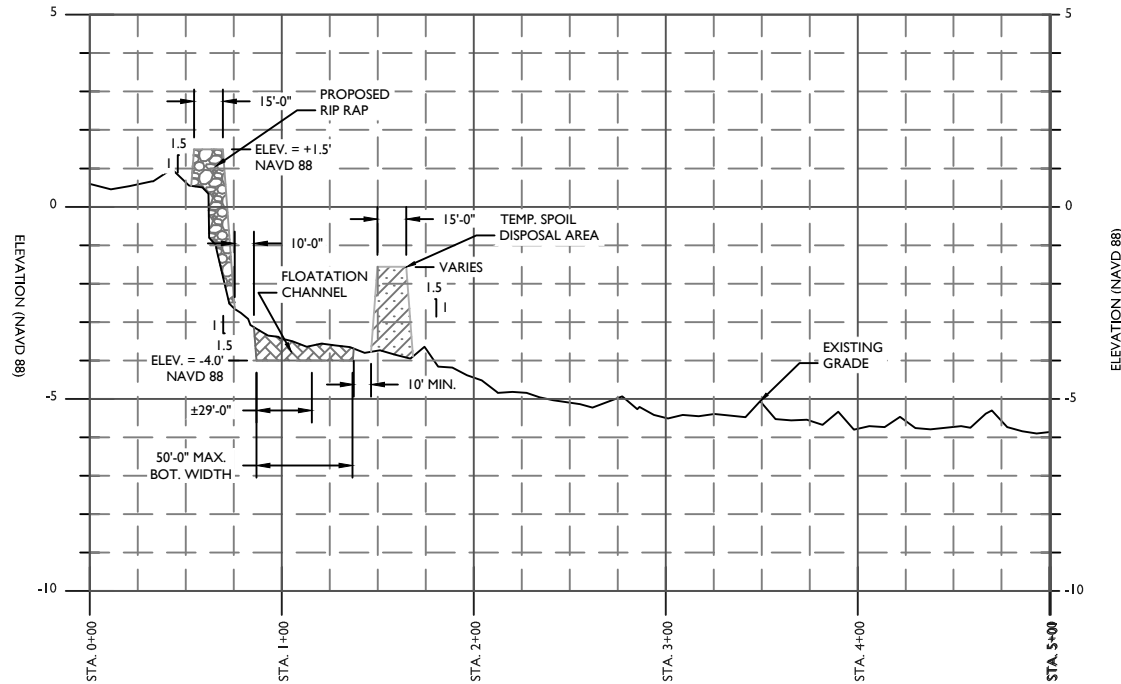
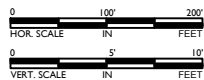

SECTION "C-C"

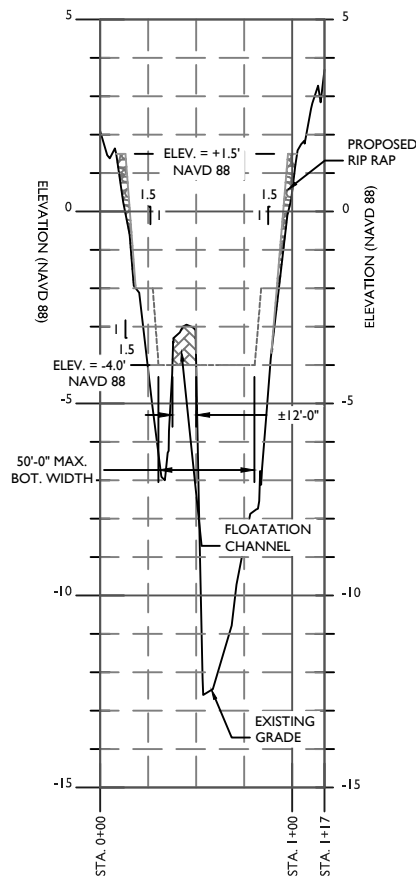

SECTION "B-B"

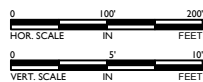

FLOATATION CHANNEL COORDINATE DATA TABLE					
PT. NUMBER	NORTHING	EASTING	PT. NUMBER	NORTHING	EASTING
1	524357.36	2677164.76	13	523548.83	2677567.16
2	524236.94	2677212.84	14	523513.97	2677497.37
3	524112.33	2677289.68	15	523445.66	2677465.86
4	523976.89	2677413.37	16	523399.91	2677350.43
5	523832.57	2677472.44	17	523276.15	2677286.66
6	523773.10	2677476.07	18	523218.52	2677237.30
7	523724.86	2677507.28	19	52677237.30	2677216.83
8	523685.38	2677572.75	20	523134.21	2677196.37
9	523654.90	2677615.72	21	523117.77	2677150.32
10	523602.12	2677641.36	22	523028.81	2677067.85
11	523602.71	2677766.04	23	522899.62	2676919.75
12	523601.80	2677603.83	24	522778.19	2676804.75

MATERIAL QUANTITY SUMMARY

SOUTH SIDE RIPRAP QUANTITY (BASE)	1,690 TONS
SOUTH SIDE RIPRAP QUANTITY (ALTERNATE NO. 2)	477 TONS
NORTH SIDE RIPRAP QUANTITY (BASE)	1,267 TONS
NORTH SIDE RIPRAP QUANTITY (ALTERNATE NO. 2)	703 TONS
SOUTH SIDE GEOTEXTILE REINFORCEMENT QUANTITY (BASE)	2,275 SQ. YDS.
SOUTH SIDE GEOTEXTILE REINFORCEMENT QUANTITY (ALTERNATE NO. 2)	695 SQ. YDS.
NORTH SIDE GEOTEXTILE REINFORCEMENT QUANTITY (BASE)	1,942 SQ. YDS.
NORTH SIDE GEOTEXTILE REINFORCEMENT QUANTITY (ALTERNATE NO. 2)	463 SQ. YDS.

NOTES:

- ALL ELEVATIONS, COORDINATES, AND STATION NUMBERS ARE EXPRESSED IN TERMS OF FEET, UNLESS OTHERWISE DENOTED.
- ALL VERTICAL POSITIONS ARE REFERENCED TO THE NORTH AMERICAN VERTICAL DATUM OF 1988 (NAVD88), CORS2011 EPOCH 2010, GEOID 12A, AND HORIZONTAL POSITIONS ARE REFERENCED TO THE NORTH AMERICAN DATUM OF 1983 (NAD 83).
- SURVEY CONTROL FOR ALL WORK PERFORMED UNDER THIS CONTRACT SHALL BE SURVEY MONUMENTS "CRMCS-SM-10A" AND/OR "CRMCS-SM-10".
- ALL SURVEY DATA USED TO PREPARE THESE DRAWINGS WAS COLLECTED BETWEEN SEPTEMBER AND DECEMBER OF 2013. THE PROJECT SITES ARE LOCATED IN A DYNAMIC COASTAL ENVIRONMENT WHICH CAN UNDERGO SIGNIFICANT ENVIRONMENTAL CHANGES OVER SHORT TIME PERIODS. CONTRACTOR SHALL NOT TAKE ADVANTAGE OF THE STATE FOR ACTUAL SITE CONDITIONS VARYING FROM THE EXISTING CONDITIONS SHOWN IN THESE DRAWINGS.
- CONTRACTOR SHALL CONTACT LA ONE CALL PRIOR TO MOBILIZING TO THE PROJECT SITES.



REV.	DATE	DESCRIPTION	BY



LONNIE G. HARPER
and Associates, Inc.
CIVIL ENGINEERING
AND LAND SURVEYING
2746 Hwy 384, Bell City, Louisiana 70630
PHONE: (337) 905-1079 FAX: (337) 905-1076

COASTAL PROTECTION AND RESTORATION AUTHORITY

450 LAUREL STREET
BATON ROUGE, LOUISIANA 70801

DRAWN BY: AARON HARPER

DESIGNED BY: CHRIS WHEAT, PE

CAMERON-CREOLE LEVEE LAKESHORE PROTECTION PROJECT

STATE PROJECT NUMBER: CS-04-A

FEDERAL PROJECT NUMBER:

APPROVED BY: LONNIE HARPER, PE

SECTIONS "A-A" THRU "C-C" PECONI BAYOU

DATE: 12/01/2015

SHEET 13 OF 19

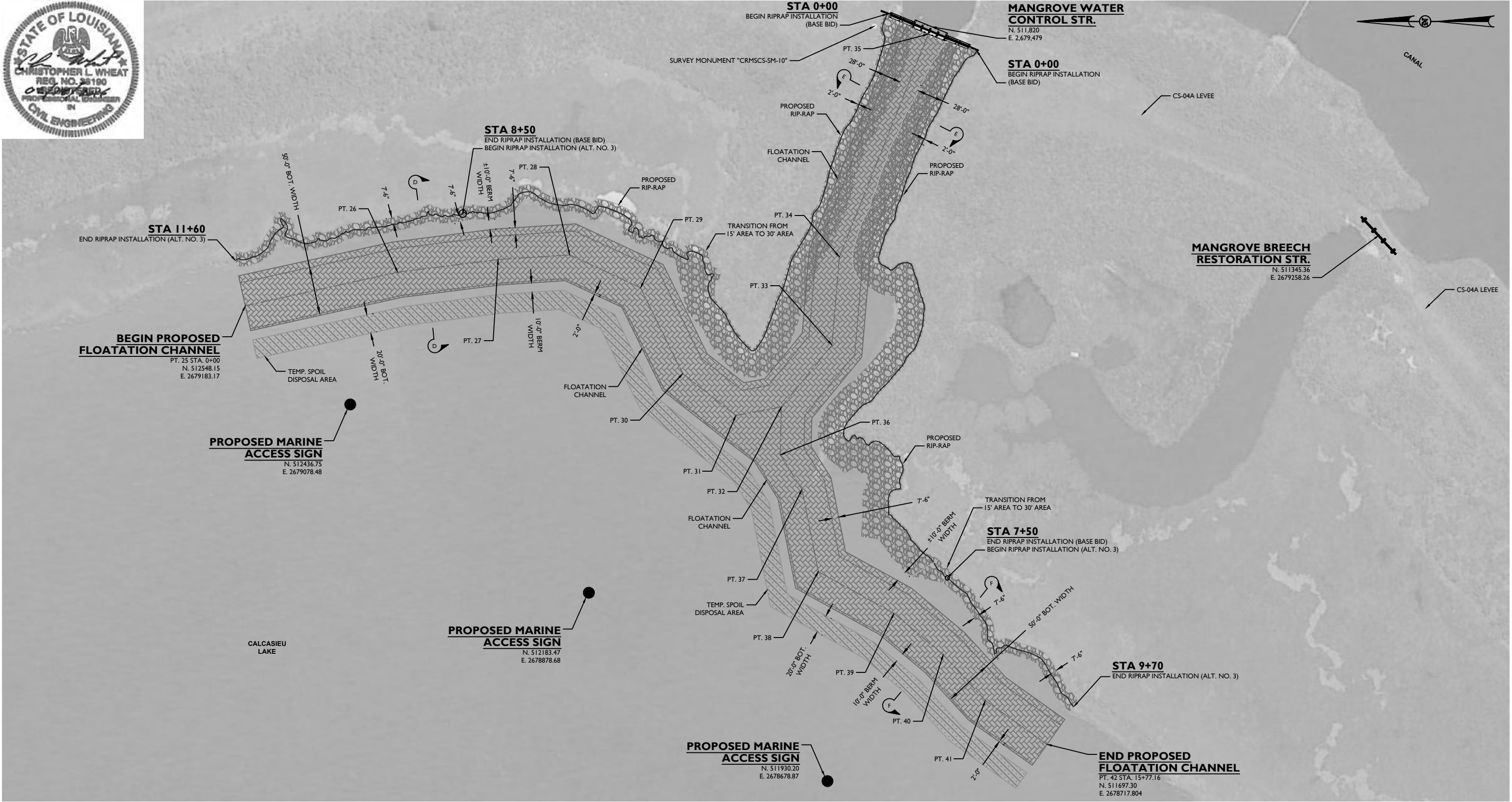

NOTES:

- ALL ELEVATIONS, COORDINATES, AND STATION NUMBERS ARE EXPRESSED IN TERMS OF FEET, UNLESS OTHERWISE DENOTED.
- ALL VERTICAL POSITIONS ARE REFERENCED TO THE NORTH AMERICAN VERTICAL DATUM OF 1988 (NAVD88). CORRS2011 EPOCH 2010, GEOID 12A, AND HORIZONTAL POSITIONS ARE REFERENCED TO THE NORTH AMERICAN DATUM OF 1983 (NAD 83)
- SURVEY CONTROL FOR ALL WORK PERFORMED UNDER THIS CONTRACT SHALL BE SURVEY MONUMENTS "CRMSCS-SM-10A" AND/OR "CRMSCS-SM-10"
- ALL SURVEY DATA USED TO PREPARE THESE DRAWINGS WAS COLLECTED BETWEEN SEPTEMBER AND DECEMBER OF 2013. THE PROJECT SITES ARE LOCATED IN A DYNAMIC COASTAL ENVIRONMENT WHICH CAN UNDERGO SIGNIFICANT ENVIRONMENTAL CHANGES OVER SHORT TIME PERIODS. CONTRACTOR SHALL NOT TAKE ADVANTAGE OF THE STATE FOR ACTUAL SITE CONDITIONS VARYING FROM THE EXISTING CONDITIONS SHOWN IN THESE DRAWINGS.
- CONTRACTOR SHALL CONTACT LA ONE CALL PRIOR TO MOBILIZING TO THE PROJECT SITES.

REV.	DATE	DESCRIPTION	BY



LONNIE G. HARPER
 and Associates, Inc.
 CIVIL ENGINEERING
 AND LAND SURVEYING
 2746 Hwy 384, Bell City, Louisiana 70630
 PHONE: (337) 905-1079 FAX: (337) 905-1076

COASTAL PROTECTION AND
 RESTORATION AUTHORITY

450 LAUREL STREET
 BATON ROUGE, LOUISIANA 70801

DRAWN BY: AARON HARPER

DESIGNED BY: CHRIS WHEAT, PE

CAMERON-CREOLE LEVEE
 LAKESHORE PROTECTION PROJECT

STATE PROJECT NUMBER: CS-04-A

FEDERAL PROJECT NUMBER:

APPROVED BY: LONNIE HARPER, PE

DETAIL "B"
 MANGROVE BAYOU

DATE: 12/01/2015

SHEET 14 OF 19

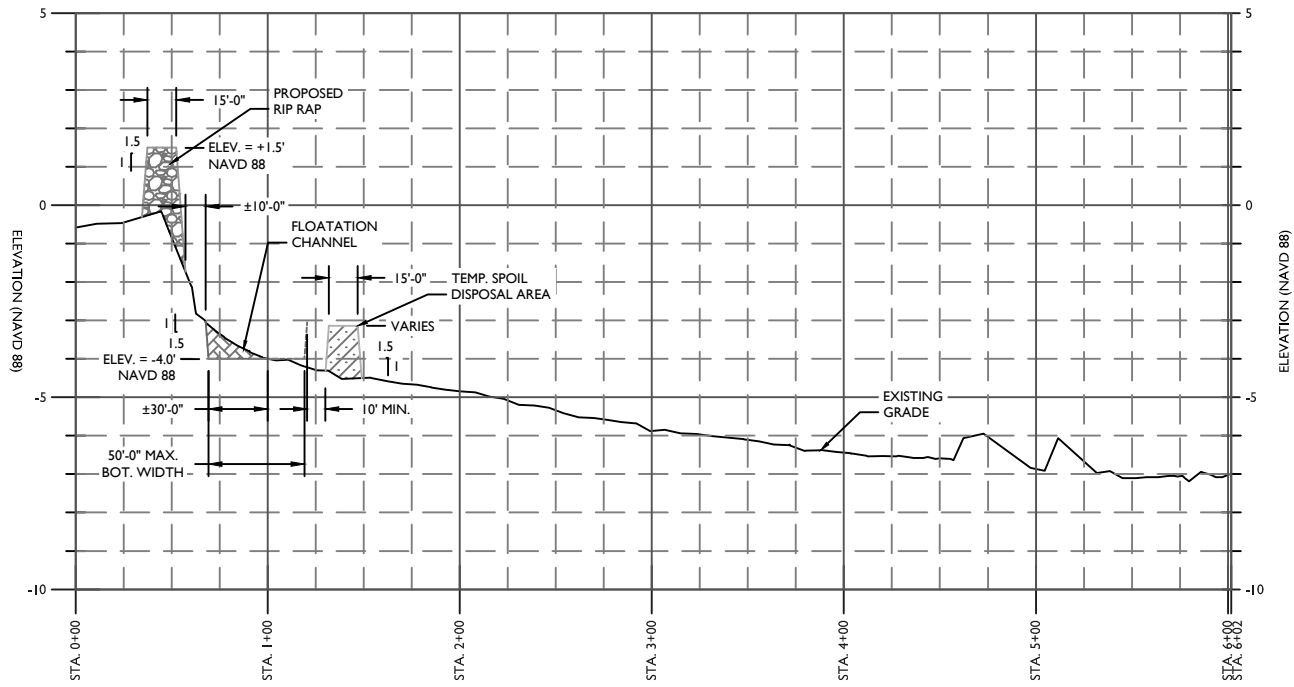

SECTION "D-D"

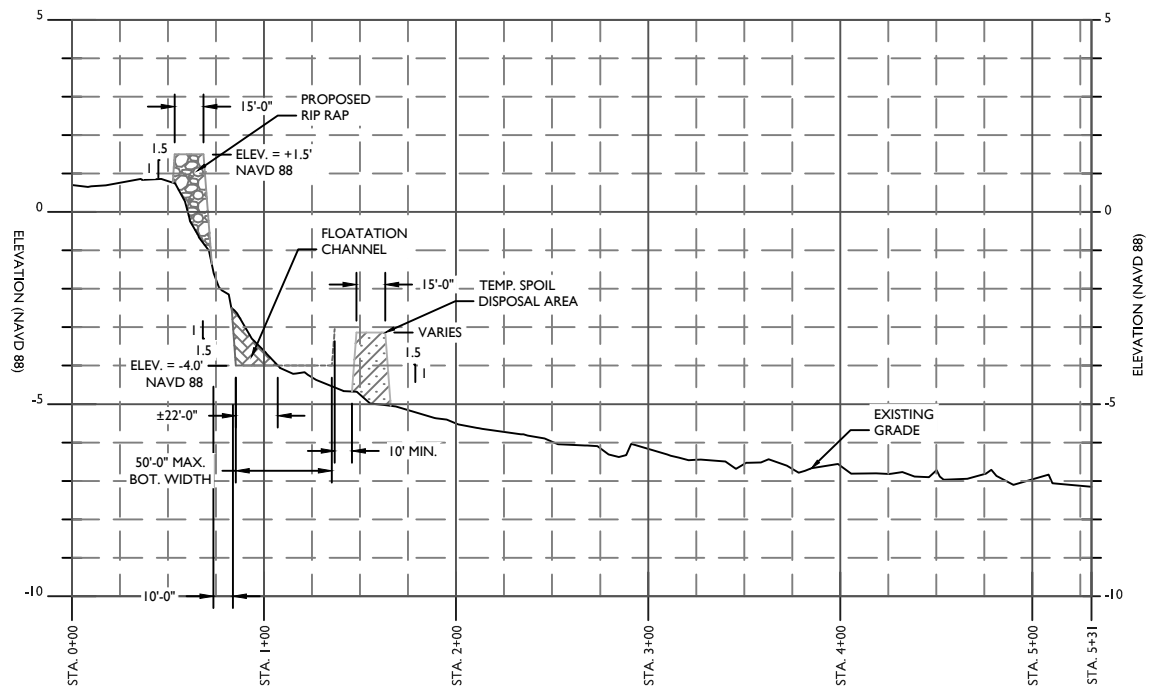
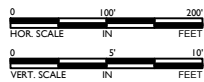

SECTION "F-F"

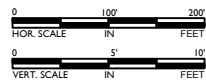

MATERIAL QUANTITY SUMMARY

SOUTH SIDE RIPRAP QUANTITY (BASE)	1,268 TONS
SOUTH SIDE RIPRAP QUANTITY (ALTERNATE NO. 3)	372 TONS
NORTH SIDE RIPRAP QUANTITY (BASE)	1,437 TONS
NORTH SIDE RIPRAP QUANTITY (ALTERNATE NO. 3)	524 TONS
SOUTH SIDE GEOTEXTILE REINFORCEMENT QUANTITY (BASE)	2,421 SQ. YDS.
SOUTH SIDE GEOTEXTILE REINFORCEMENT QUANTITY (ALTERNATE NO. 3)	434 SQ. YDS.
NORTH SIDE GEOTEXTILE REINFORCEMENT QUANTITY (BASE)	2,355 SQ. YDS.
NORTH SIDE GEOTEXTILE REINFORCEMENT QUANTITY (ALTERNATE NO. 3)	488 SQ. YDS.

NOTES:

- ALL ELEVATIONS, COORDINATES, AND STATION NUMBERS ARE EXPRESSED IN TERMS OF FEET, UNLESS OTHERWISE DENOTED.
- ALL VERTICAL POSITIONS ARE REFERENCED TO THE NORTH AMERICAN VERTICAL DATUM OF 1988 (NAVD88), CORS2011 EPOCH 2010, GEOID 12A, AND HORIZONTAL POSITIONS ARE REFERENCED TO THE NORTH AMERICAN DATUM OF 1983 (NAD 83)
- SURVEY CONTROL FOR ALL WORK PERFORMED UNDER THIS CONTRACT SHALL BE SURVEY MONUMENTS "CRMCS-SM-10A" AND/OR "CRMCS-SM-10".
- ALL SURVEY DATA USED TO PREPARE THESE DRAWINGS WAS COLLECTED BETWEEN SEPTEMBER AND DECEMBER OF 2013. THE PROJECT SITES ARE LOCATED IN A DYNAMIC COASTAL ENVIRONMENT WHICH CAN UNDERGO SIGNIFICANT ENVIRONMENTAL CHANGES OVER SHORT TIME PERIODS. CONTRACTOR SHALL NOT TAKE ADVANTAGE OF THE STATE FOR ACTUAL SITE CONDITIONS VARYING FROM THE EXISTING CONDITIONS SHOWN IN THESE DRAWINGS.
- CONTRACTOR SHALL CONTACT LA ONE CALL PRIOR TO MOBILIZING TO THE PROJECT SITES.

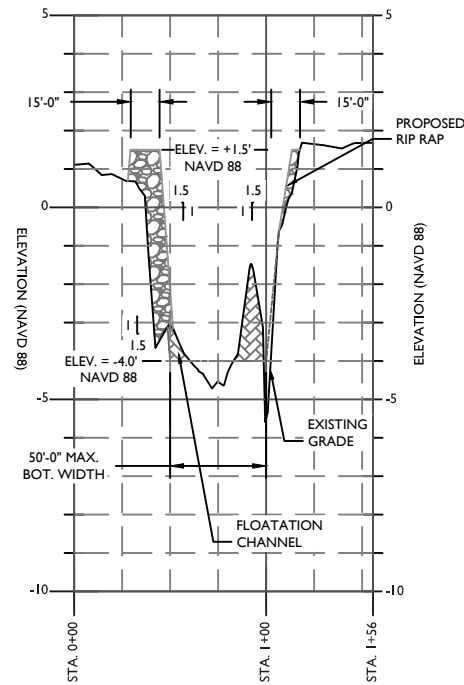

SECTION "E-E"

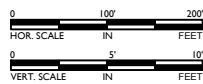

FLOATATION CHANNEL COORDINATE DATA TABLE					
PT. NUMBER	NORTHING	EASTING	PT. NUMBER	NORTHING	EASTING
25	512548.16	2679183.18	34	511917.59	2679235.14
26	512386.36	2679218.83	35	511823.26	2679471.50
27	512279.70	2679232.27	36	511980.29	2679024.95
28	512203.66	2679237.19	37	511957.27	2678988.39
29	512128.61	2679202.26	38	511939.95	2678901.11
30	512083.83	2679111.12	39	511859.69	2678856.81
31	512027.44	2679066.82	40	511807.39	2678813.07
32	511979.06	2679075.87	41	511762.70	2678764.34
33	511925.50	2679141.47	42	511697.30	2678717.80



REV.	DATE	DESCRIPTION	BY



LONNIE G. HARPER
and Associates, Inc.
CIVIL ENGINEERING
AND LAND SURVEYING
2746 Hwy 384, Bell City, Louisiana 70630
PHONE: (337) 905-1079 FAX: (337) 905-1076

COASTAL PROTECTION AND RESTORATION AUTHORITY

450 LAUREL STREET
BATON ROUGE, LOUISIANA 70801

DRAWN BY: AARON HARPER

DESIGNED BY: CHRIS WHEAT, PE

CAMERON-CREOLE LEVEE LAKESHORE PROTECTION PROJECT

STATE PROJECT NUMBER: CS-04-A

FEDERAL PROJECT NUMBER:

APPROVED BY: LONNIE HARPER, PE

SECTIONS "D-D" THRU "F-F" MANGROVE BAYOU

DATE: 12/01/2015

SHEET 15 OF 19

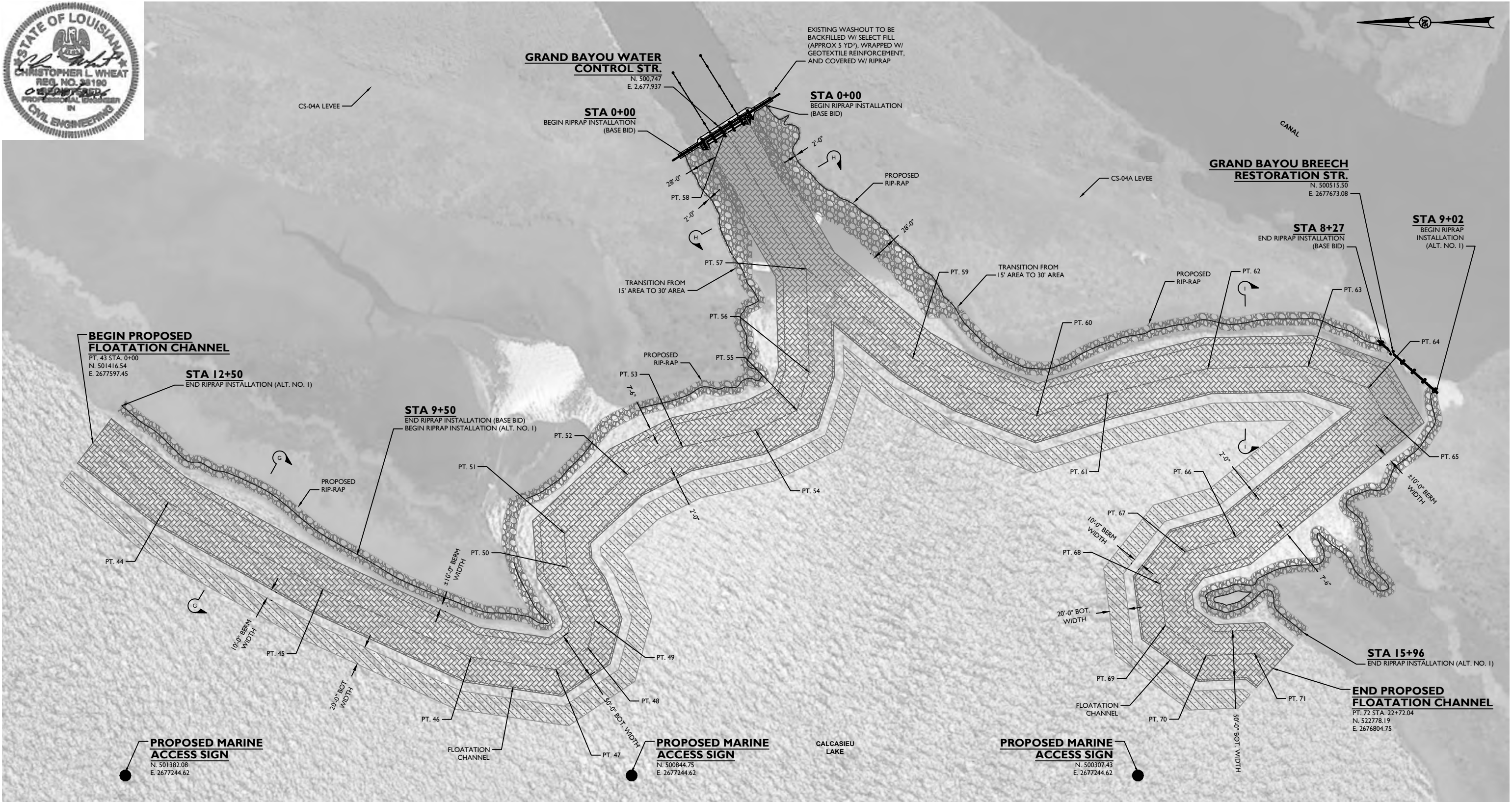

NOTES:

- ALL ELEVATIONS, COORDINATES, AND STATION NUMBERS ARE EXPRESSED IN TERMS OF FEET, UNLESS OTHERWISE DENOTED.
- ALL VERTICAL POSITIONS ARE REFERENCED TO THE NORTH AMERICAN VERTICAL DATUM OF 1988 (NAVD88). CORRS2011 EPOCH 2010, GEOID 12A, AND HORIZONTAL POSITIONS ARE REFERENCED TO THE NORTH AMERICAN DATUM OF 1983 (NAD 83)
- SURVEY CONTROL FOR ALL WORK PERFORMED UNDER THIS CONTRACT SHALL BE SURVEY MONUMENTS "CRMSCS-SM-10A" AND/OR "CRMSCS-SM-10"
- ALL SURVEY DATA USED TO PREPARE THESE DRAWINGS WAS COLLECTED BETWEEN SEPTEMBER AND DECEMBER OF 2013. THE PROJECT SITES ARE LOCATED IN A DYNAMIC COASTAL ENVIRONMENT WHICH CAN UNDERGO SIGNIFICANT ENVIRONMENTAL CHANGES OVER SHORT TIME PERIODS. CONTRACTOR SHALL NOT TAKE ADVANTAGE OF THE STATE FOR ACTUAL SITE CONDITIONS VARYING FROM THE EXISTING CONDITIONS SHOWN IN THESE DRAWINGS.
- CONTRACTOR SHALL CONTACT LA ONE CALL PRIOR TO MOBILIZING TO THE PROJECT SITES.

REV.	DATE	DESCRIPTION	BY



LONNIE G. HARPER
 and Associates, Inc.
 CIVIL ENGINEERING
 AND LAND SURVEYING
 2746 Hwy 384, Bell City, Louisiana 70630
 PHONE: (337) 905-1079 FAX: (337) 905-1076

COASTAL PROTECTION AND
 RESTORATION AUTHORITY

450 LAUREL STREET
 BATON ROUGE, LOUISIANA 70801

DRAWN BY: AARON HARPER

DESIGNED BY: CHRIS WHEAT, PE

CAMERON-CREOLE LEVEE
 LAKESHORE PROTECTION PROJECT

STATE PROJECT NUMBER: CS-04-A

FEDERAL PROJECT NUMBER:

APPROVED BY: LONNIE HARPER, PE

DETAIL "C"
 GRAND BAYOU

DATE: 12/01/2015

SHEET 16 OF 19

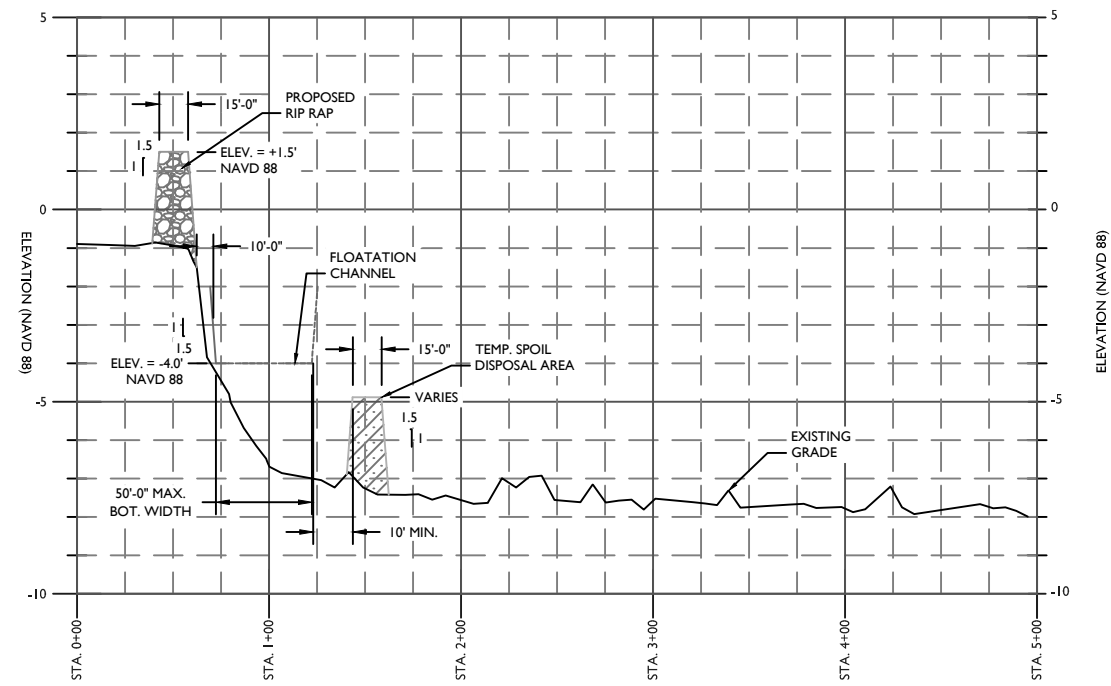

0 100' 200'
HOR. SCALE IN FEET

0 5' 10'
VERT. SCALE IN FEET

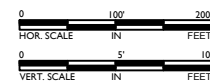

SECTIONS "G-G" THRU "I-I"
GRAND BAYOU



NOTES:

- THE ABOVE DRAWING DEPICTS THE 4 FEET DEEP WATER DEPTH CONTOUR ALONG THE EASTERN SHORE OF CALCASIEU LAKE AS WELL AS POTENTIAL PIPELINE LOCATIONS WITHIN THE LAKE AND LEVEE SYSTEM.
- CONTRACTOR SHALL COORDINATE PIPELINE CROSSINGS (IF NECESSARY) WITH THE PIPELINE COMPANY AND HAVE A REPRESENTATIVE PRESENT DURING THE CROSSING IF REQUIRED BY THE COMPANY.
- FLOTATION DREDGING IN CLOSE PROXIMITY TO EXISTING PIPELINES (IF ANY) SHALL BE COMPLETED IN ACCORDANCE WITH THE PIPELINE COMPANY'S RECOMMENDATIONS AND REQUIREMENTS.
- CONTRACTOR SHALL CONTACT LA ONE CALL PRIOR TO MOBILIZING TO THE PROJECT SITES.

REV.	DATE	DESCRIPTION	BY



LONNIE G. HARPER
 and Associates, Inc.
 CIVIL ENGINEERING
 AND LAND SURVEYING
 2746 Hwy 384, Bell City, Louisiana 70630
 PHONE: (337) 905-1079 FAX: (337) 905-1076

COASTAL PROTECTION AND
 RESTORATION AUTHORITY

450 LAUREL STREET
 BATON ROUGE, LOUISIANA 70801

DRAWN BY: AARON HARPER

DESIGNED BY: CHRIS WHEAT, PE

CAMERON-CREOLE LEVEE
 LAKESHORE PROTECTION PROJECT

STATE PROJECT NUMBER: CS-04-A

FEDERAL PROJECT NUMBER:

APPROVED BY: LONNIE HARPER, PE

4' WATER DEPTH CONTOUR
 AND POTENTIAL PIPELINES

DATE: 12/01/2015

SHEET 18 OF 19

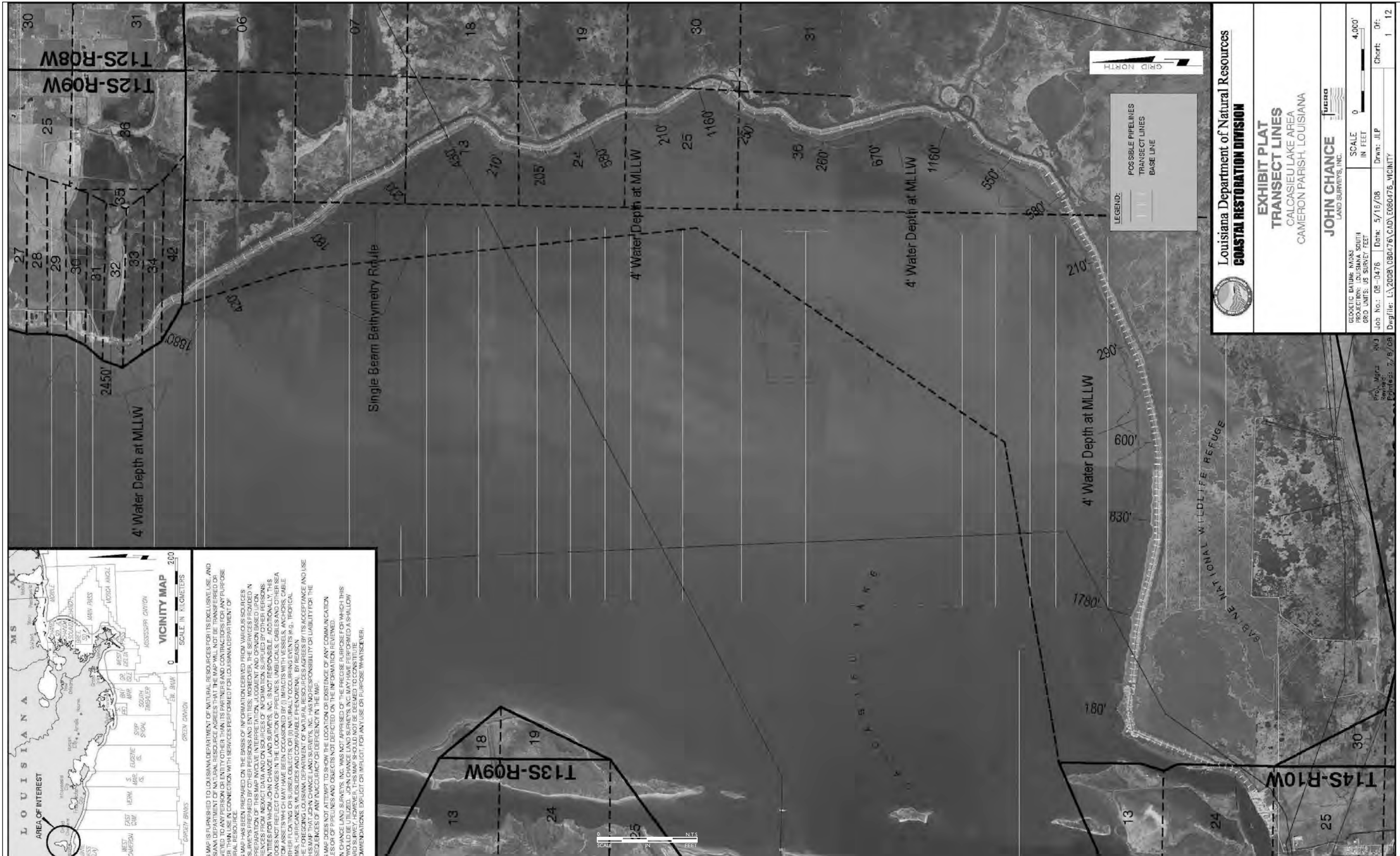

Louisiana Department of Natural Resources
 COASTAL RESTORATION DIVISION

EXHIBIT PLAT
 TRANSECT LINES
 CALCASIEU LAKE AREA
 CAMERON PARISH, LOUISIANA

JOHN CHANCE

LAND SURVEYOR, INC.



GEODETTIC DATUM: NAD83
 PROJECTION: LOUISIANA SOUTH
 GRID UNITS: US SURVEY FEET

SCALE: 0 4,000'
 IN FEET

Job No.: 08-0476 Date: 5/16/08 Drawn: JLP

Dwgfile: L:\2008\080476\CAD\E080476_VICINITY

Chart: 1 12

Proj. Mgr.: RYJ
 Surveyor: JLP
 Date: 7/15/08

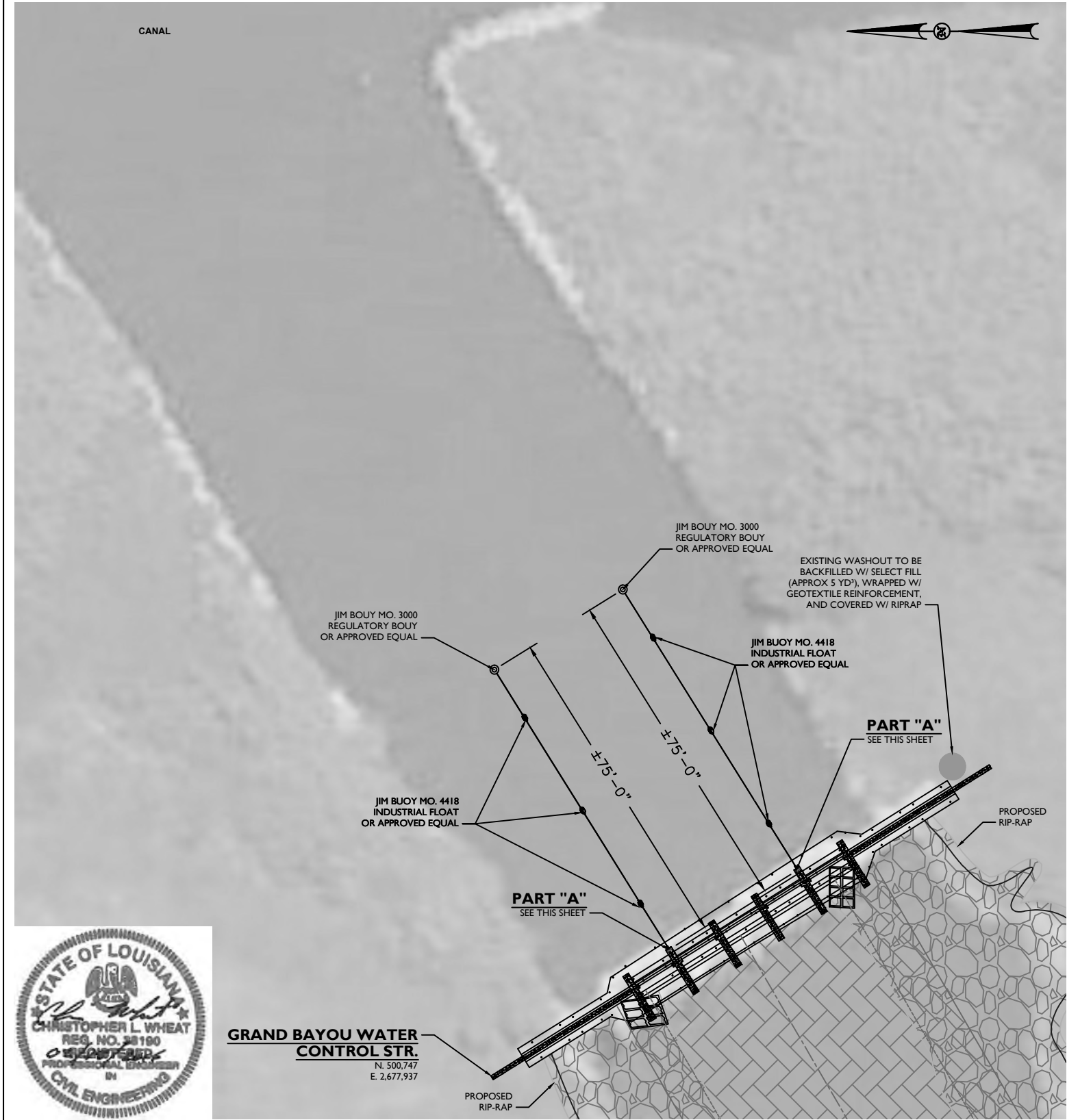

NOTES:

- ALL ELEVATIONS, COORDINATES, AND STATION NUMBERS ARE EXPRESSED IN TERMS OF FEET, UNLESS OTHERWISE DENOTED.
- ALL VERTICAL POSITIONS ARE REFERENCED TO THE NORTH AMERICAN VERTICAL DATUM OF 1988 (NAVDS8). CORS2011 EPOCH 2010, GEOID 12A, AND HORIZONTAL POSITIONS ARE REFERENCED TO THE NORTH AMERICAN DATUM OF 1983 (NAD 83)
- SURVEY CONTROL FOR ALL WORK PERFORMED UNDER THIS CONTRACT SHALL BE SURVEY MONUMENTS "CRMSCS-SM-10A" AND/OR "CRMSCS-SM-10"
- ALL SURVEY DATA USED TO PREPARE THESE DRAWINGS WAS COLLECTED BETWEEN SEPTEMBER AND DECEMBER OF 2013. THE PROJECT SITES ARE LOCATED IN A DYNAMIC COASTAL ENVIRONMENT WHICH CAN UNDERGO SIGNIFICANT ENVIRONMENTAL CHANGES OVER SHORT TIME PERIODS. CONTRACTOR SHALL NOT TAKE ADVANTAGE OF THE STATE FOR ACTUAL SITE CONDITIONS VARYING FROM THE EXISTING CONDITIONS SHOWN IN THESE DRAWINGS.
- CONTRACTOR SHALL CONTACT LA ONE CALL PRIOR TO MOBILIZING TO THE PROJECT SITES.

HAZARD LINE PLAN



REV.	DATE	DESCRIPTION	BY



LONNIE G. HARPER
and Associates, Inc.
CIVIL ENGINEERING
AND LAND SURVEYING
2746 Hwy 384, Bell City, Louisiana 70630
PHONE: (337) 905-1079 FAX: (337) 905-1076

COASTAL PROTECTION AND RESTORATION AUTHORITY

450 LAUREL STREET
BATON ROUGE, LOUISIANA 70801

DRAWN BY: AARON HARPER

DESIGNED BY: CHRIS WHEAT, PE

CAMERON-CREOLE LEVEE LAKESHORE PROTECTION PROJECT

STATE PROJECT NUMBER: CS-04-A

FEDERAL PROJECT NUMBER:

APPROVED BY: LONNIE HARPER, PE

HAZARD LINE PLAN & DET. GRAND BAYOU

DATE: 12/01/2015

SHEET 19 OF 19

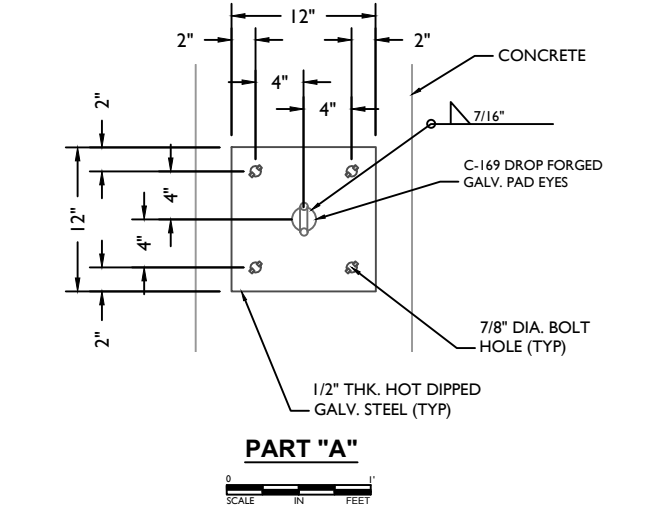

PART "A"

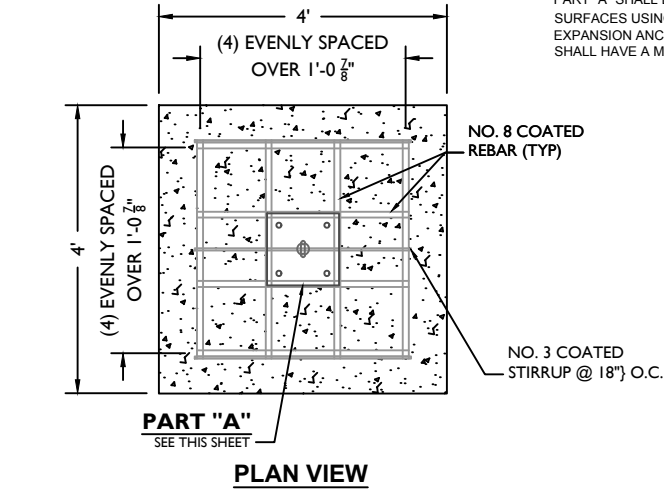

PLAN VIEW

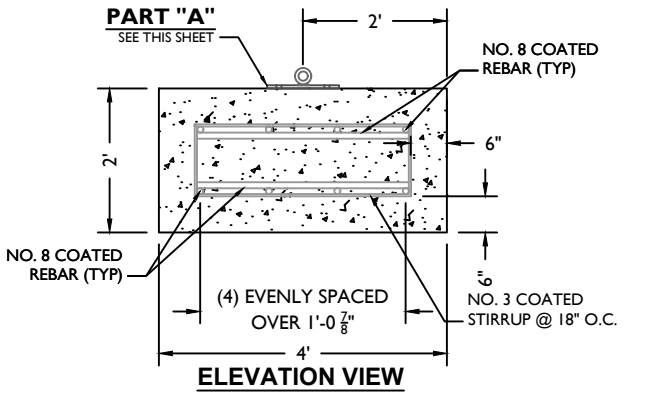

ELEVATION VIEW

MODEL NO. 3000 BOUY ATTACHMENT DETAIL

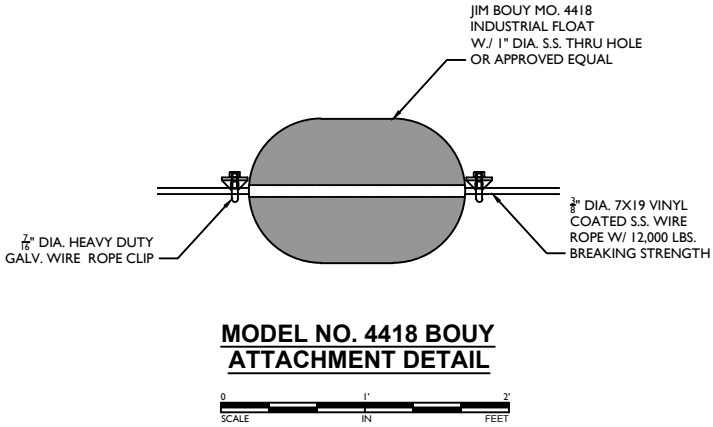

MODEL NO. 4418 BOUY ATTACHMENT DETAIL

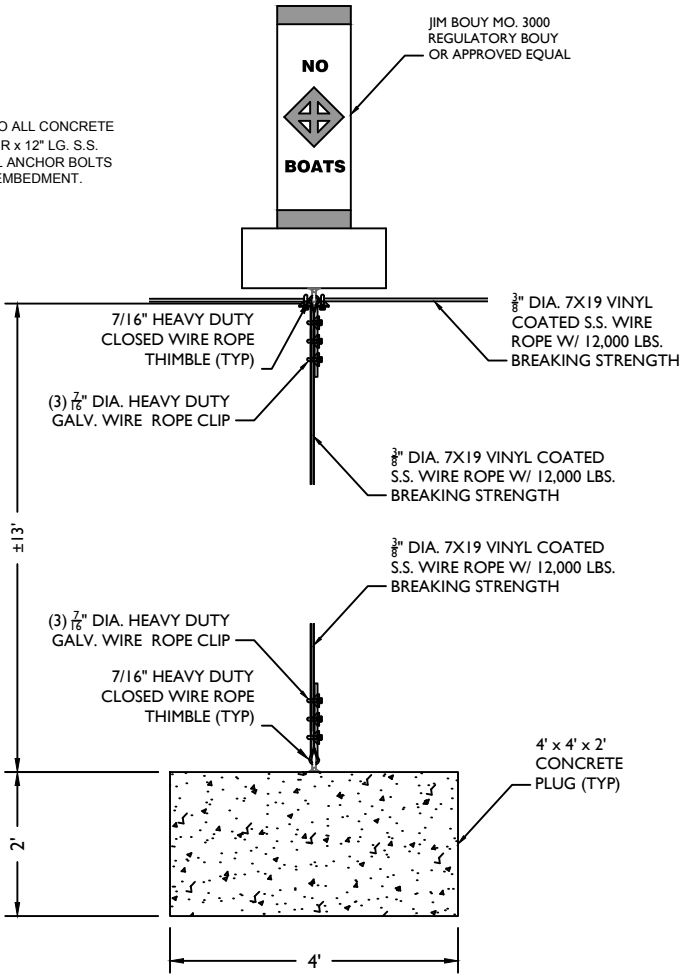
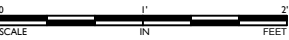

MODEL NO. 3000 BOUY ATTACHMENT DETAIL

