

State of Louisiana



KATHLEEN BABINEAUX BLANCO
GOVERNOR

SCOTT A. ANGELLE
SECRETARY

DEPARTMENT OF NATURAL RESOURCES
OFFICE OF COASTAL RESTORATION AND MANAGEMENT

October 6, 2006

Richard Hartman
National Marine Fisheries Service
Habitat Conservation Division
c/o Louisiana State University
Baton Rouge, LA 70808-7535

RE: **C20030606**, Coastal Zone Consistency Modification
NMFS
Direct Federal Action
Chaland Headland Restoration CWPPRA Project (BA-38-2), modification for excavation of a supplemental borrow area D1, **Plaquemines Parish, Louisiana**

Dear Mr. Hartman:

The above referenced project modification has been reviewed for consistency with the approved Louisiana Coastal Resources Program (LCRP) as required by Section 307 of the Coastal Zone Management Act of 1972, as amended. The modification, as proposed in the application, is consistent with the LCRP.

If you have any questions concerning this information request, please contact Brian Marcks of the Consistency Section at (225)342-7939 or 1-800-267-4019.

Sincerely,

A handwritten signature in black ink, appearing to read "Jim Rives".

Jim Rives
Acting Administrator

JR/JH/bgm

cc: Greg Grandy, CED
Frank Cole, CMD FI
Andrew MacInnes, Plaquemines Parish
Ron Ventola, COE-NOD

CHALAND HEADLAND RESTORATION (BA-38-2) CWPPRA PROJECT

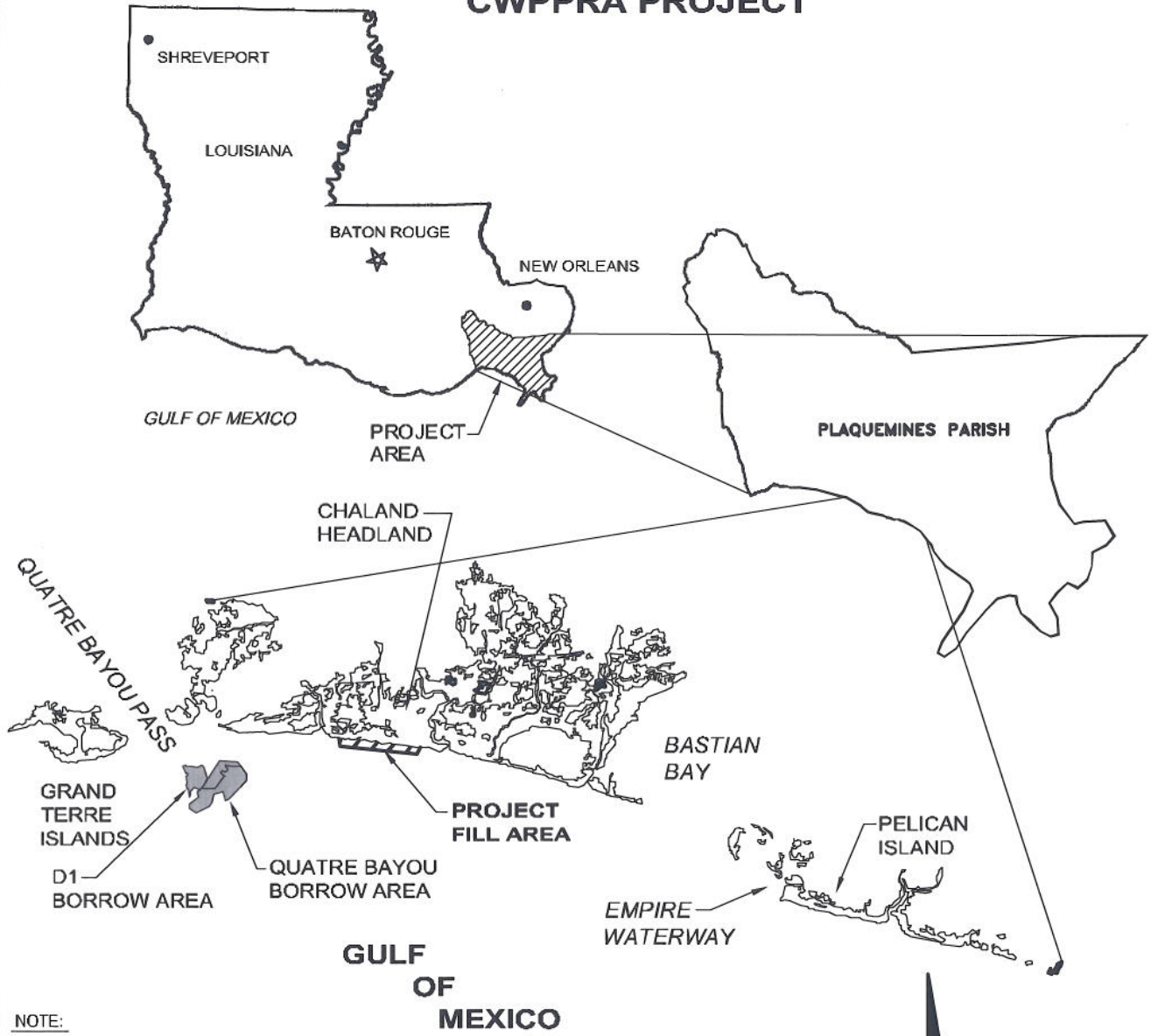

**CHALAND HEADLAND RESTORATION
(BA-38-2) CWPPRA PROJECT
LOCATION MAP**

TITLE:
 2481 N.W. BOCA RATON BLVD.
 BOCA RATON, FL 33431
 PH. (561) 391-8102 FAX (561) 391-9116

COASTAL PLANNING & ENGINEERING, INC.
 www.CoastalPlanning.net

DATE: 11/17/03
 BY: JRC
 COMM NO.: 7261.07
 SHEET: 1

NOTE:
 SOURCE OF MAP: LOUISIANA GIS CD;
 A DIGITAL MAP OF THE STATE, 2 CD SET.

SHEET INDEX

NO.	TITLE
1	LOCATION MAP
2-3	PROJECT PLAN VIEW
4	QUATRE BAYOU BORROW AREA BATHYMETRY
5-6	QUATRE BAYOU BORROW AREA CROSS SECTIONS
7-9	FILL CROSS SECTIONS
10	BARGE ACCESS CANAL CROSS SECTION A-A' (TYP.)
11	TYPICAL CANAL CLOSURE PROFILE B-B' (TYP.)
12	TYPICAL CANAL CLOSURE CROSS SECTION C-C' (TYP.)
13	BREACH CLOSURE CROSS SECTION D-D'
14	BREACH CLOSURE PROFILE E-E'
15-22	D1 BORROW AREA BATHYMETRY
23-28	D1 BORROW AREA CROSS SECTIONS

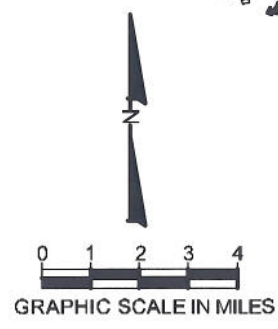

REVISIONS		
DATE	BY	DESCRIPTION
09/05/06	STR	BORROW AREA D1 ADDED

H:\Louisiana\7261\07\PERMITS\CHALAND\CHALAND LOCATION MAP.dwg

H:\Louisiana\726107\IPERMITS\CHALAND\Chaland_Borrow Area PV D1.dwg - Sep 05, 2006 @ 3:05pm - dubin

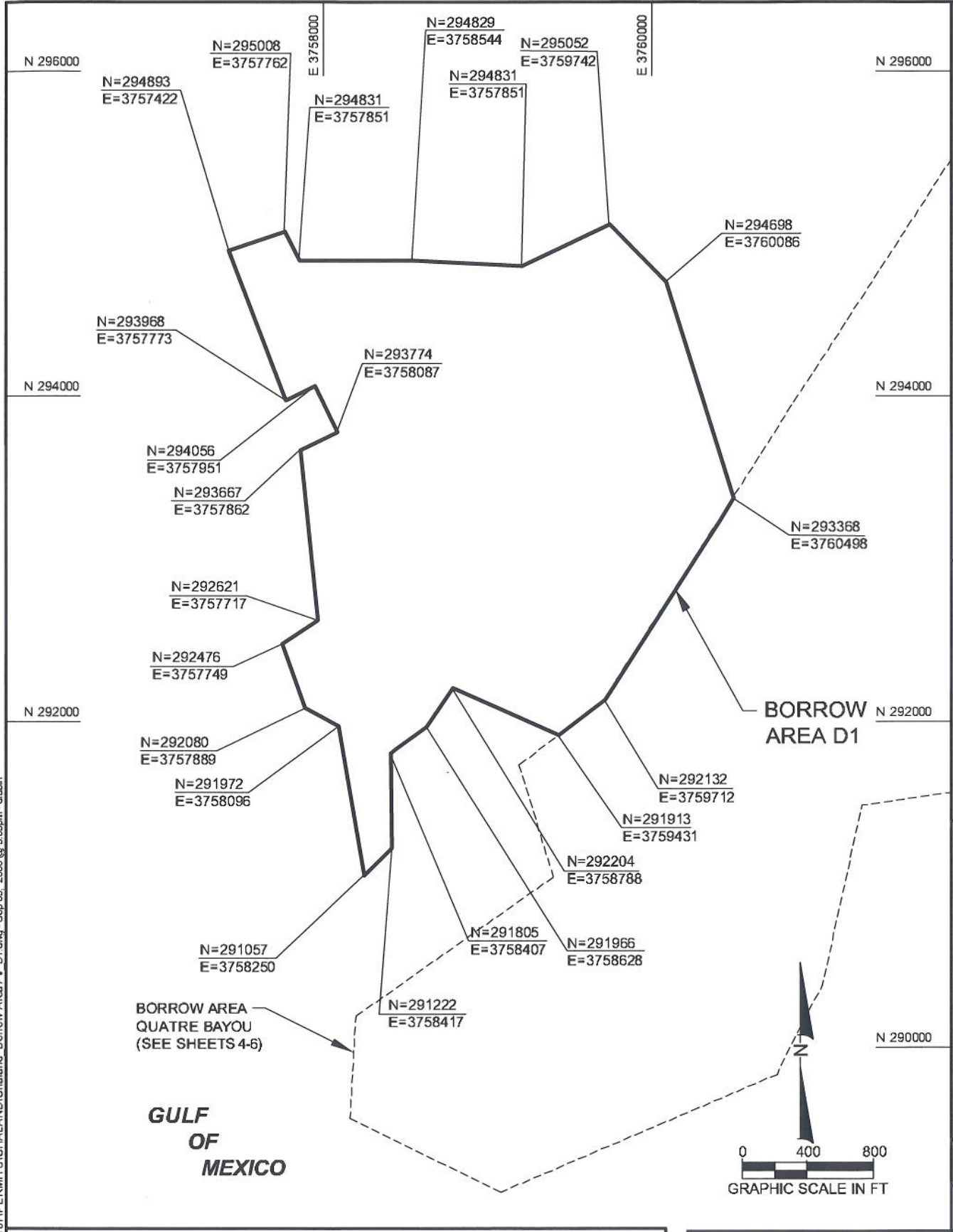

**CHALAND HEADLAND RESTORATION
(BA-38-2) CWPRA PROJECT
BORROW AREA D1 COORDINATES**

TITLE:
2481 N.W. BOCA RATON BLVD.
BOCA RATON, FL 33431
PH. (561) 391-8102 FAX (561) 391-9116

COASTAL PLANNING & ENGINEERING, INC.
www.CoastalPlanning.net

DATE: 7/22/05
BY: JRC
COMM NO.: 7900.05
SHEET: 15

NOTES:



- COORDINATES SHOWN HEREON ARE IN FEET BASED ON LOUISIANA STATE PLANE COORDINATE SYSTEM, SOUTH ZONE, NAD 1983.

REVISIONS		
DATE	BY	DESCRIPTION

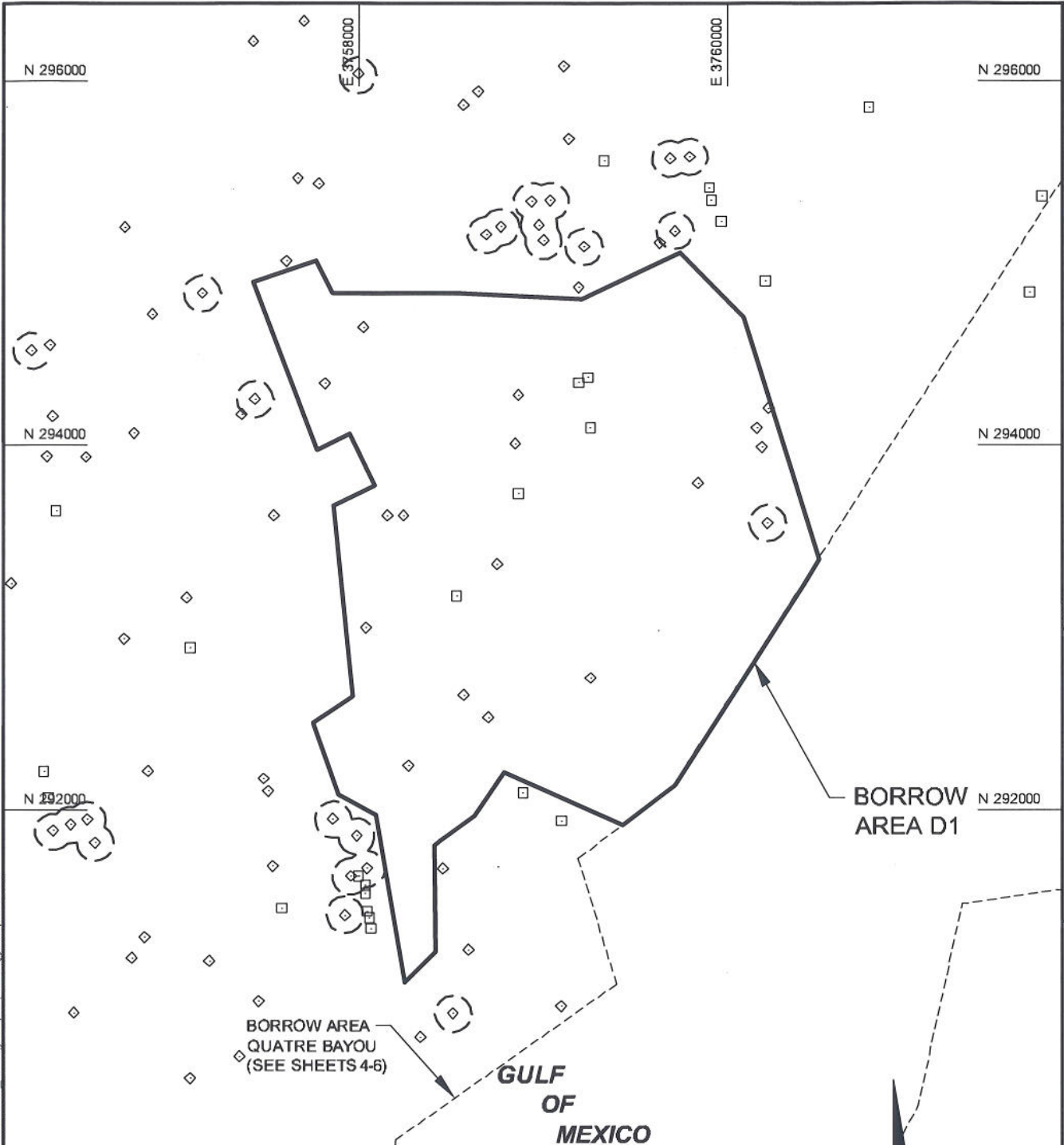
H:\Louisiana\1726107\PERMITS\CHALAND\Chaland_Borrow Area PV Dr.dwg - Sep 05, 2006 @ 5:05pm - drubin



LEGEND:

-  MAGNETIC ANOMALY AREA OF AVOIDANCE (100' BUFFER)
-  2004 CULTURAL RESOURCE MAGNETIC ANOMALY
-  2003 MAGNETIC ANOMALY

NOTES:

1. COORDINATES SHOWN HEREON ARE IN FEET BASED ON LOUISIANA STATE PLANE COORDINATE SYSTEM, SOUTH ZONE, NAD 1983.
2. DATE OF MAGNETOMETER SURVEY: SEPTEMBER 2003, CONDUCTED BY CPE.

REVISIONS		
DATE	BY	DESCRIPTION

**CHALAND HEADLAND RESTORATION
(BA-38-2) CWPRA PROJECT
BORROW AREA D1 MAGNETIC ANOMALIES**

TITLE:

2481 N.W. BOCA RATON BLVD.
BOCA RATON, FL 33431
PH. (561) 391-8102 FAX (561) 391-9116

COASTAL PLANNING & ENGINEERING, INC.
www.CoastalPlanning.net

DATE: 7/22/05

BY: JRC

COMM NO.: 7900.05

SHEET: 16

H:\Louisiana\1726107\PERMITS\CHALAND\Chaland Borrow Area PV D1.dwg - Sep 05 2006 @ 5:02pm - dhubin

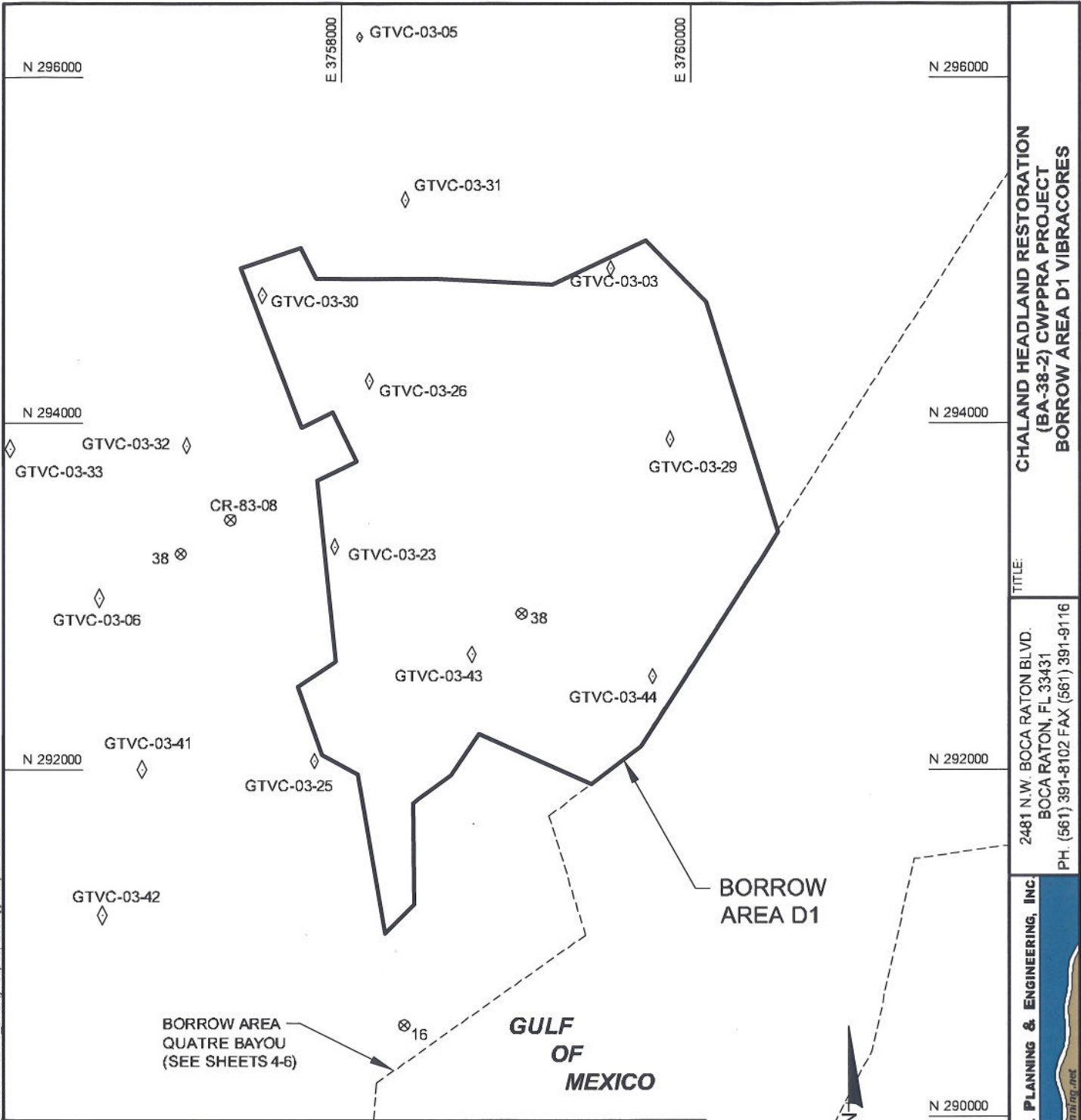

**CHALAND HEADLAND RESTORATION
(BA-38-2) CWPRA PROJECT
BORROW AREA D1 VIBRACORES**

TITLE:
2481 N.W. BOCA RATON BLVD.
BOCA RATON, FL 33431
PH. (561) 391-8102 FAX (561) 391-9116



DATE: 7/22/05
BY: JRC
COMM NO.: 7900.05
SHEET: 17

LEGEND:

- ◇ 2003 CPE VIBRACORE
- ⊗ USGS VIBRACORE
- D1-E' CROSS SECTION LABELS

NOTES:

1. COORDINATES SHOWN HEREON ARE IN FEET BASED ON LOUISIANA STATE PLANE COORDINATE SYSTEM, SOUTH ZONE, NAD 1983.
2. ELEVATIONS SHOWN HEREON ARE IN FEET BASED ON NAVD 1988.
3. DATE OF BATHYMETRIC SURVEY, SEISMIC SCAN, SIDE SCAN SONAR, AND MAGNETOMETER SURVEY: SEPTEMBER 2003, CONDUCTED BY CPE.

REVISIONS		
DATE	BY	DESCRIPTION

H:\Louisiana\7261071\PERMITS\CHALAND\Chaland Borrow Area PV D1.dwg - Sep 05, 2006 @ 3:02pm - dhbin

**CHALAND HEADLAND RESTORATION
(BA-38-2) CWPBRA PROJECT
BORROW AREA D1 BATHYMETRIC SURVEY**

TITLE:

2481 N.W. BOCA RATON BLVD.
BOCA RATON, FL 33431
PH: (561) 391-8102 FAX (561) 391-9116

COASTAL PLANNING & ENGINEERING, INC
www.CoastalPlanning.net

DATE: 7/22/05
BY: JRC
COMM NO.: 7900.05
SHEET: 18

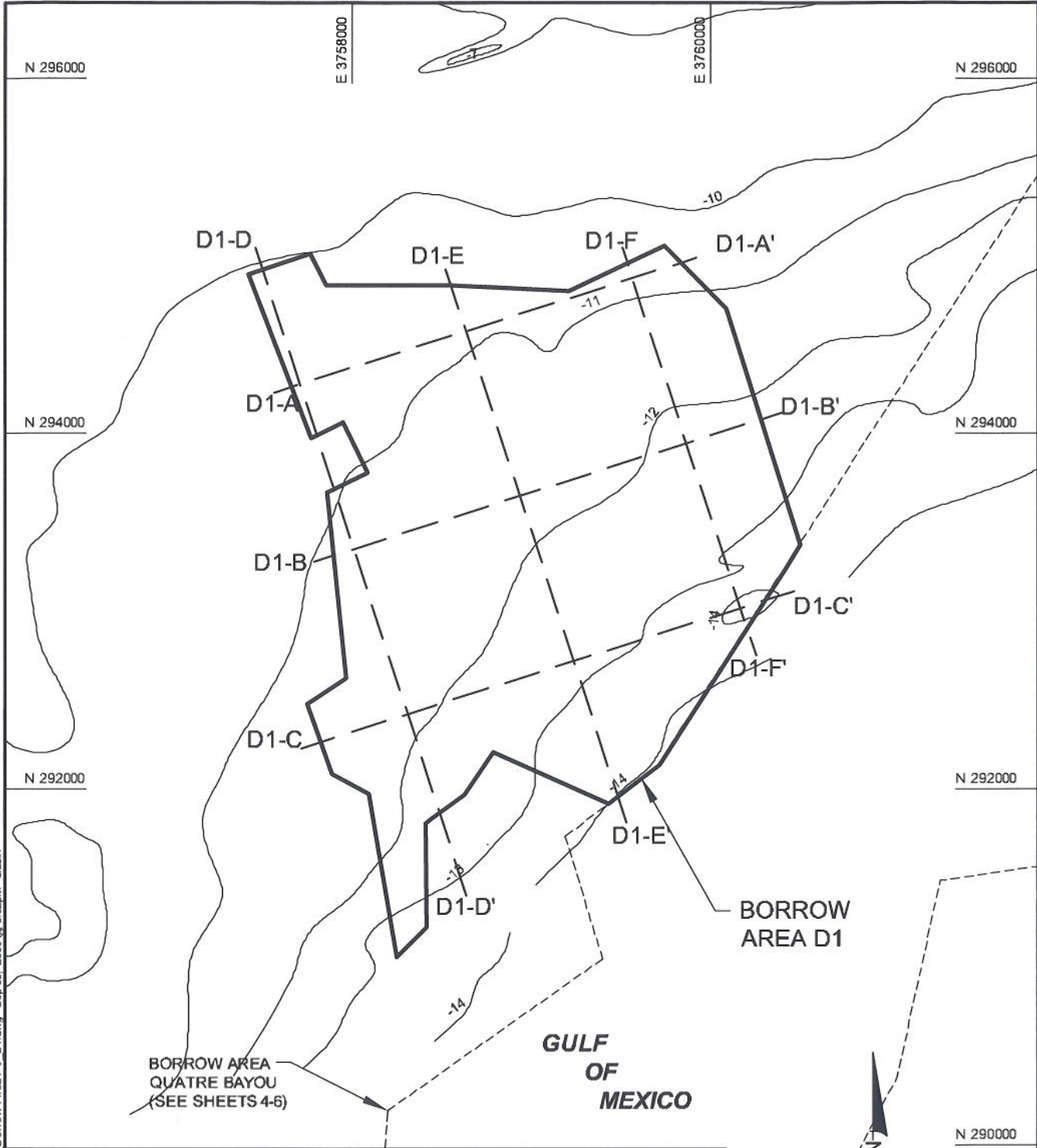

LEGEND:

- ◇ 2003 CPE VIBRACORE
- ⊗ USGS VIBRACORE
- D1-E' CROSS SECTION LABELS

NOTES:

1. COORDINATES SHOWN HEREON ARE IN FEET BASED ON LOUISIANA STATE PLANE COORDINATE SYSTEM, SOUTH ZONE, NAD 1983.
2. ELEVATIONS SHOWN HEREON ARE IN FEET BASED ON NAVD 1988.
3. DATE OF BATHYMETRIC SURVEY, SEISMIC SCAN, SIDE SCAN SONAR, AND MAGNETOMETER SURVEY: SEPTEMBER 2003, CONDUCTED BY CPE.

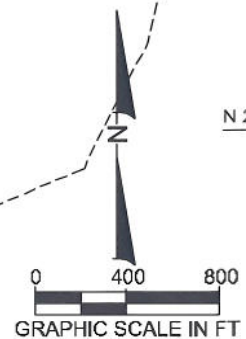

REVISIONS		
DATE	BY	DESCRIPTION

N 296000

E 3758000

E 3760000

N 296000

DREDGE CUTS NOTED ON THIS SHEET
REFER TO REMOVAL ELEVATION OF MARSH
CONSTRUCTION MATERIAL

CUT TO
-23.5 NAVD

CUT TO
-19 NAVD

CUT TO
-20 NAVD

CUT TO
-21 NAVD

CUT TO
-19 NAVD

CUT TO
-20 NAVD

CUT TO
-21 NAVD

CUT TO
-22 NAVD

CUT TO
-19 NAVD

CUT TO
-15.5 NAVD

CUT TO
-17 NAVD

CUT TO
-24 NAVD

CUT TO
-17 NAVD

CUT TO
-20 NAVD

CUT TO
-24 NAVD

N 294000

N 294000

N 292000

N 292000

BORROW
AREA D1

BORROW AREA
QUATRE BAYOU
(SEE SHEETS 4-6)

GULF
OF
MEXICO

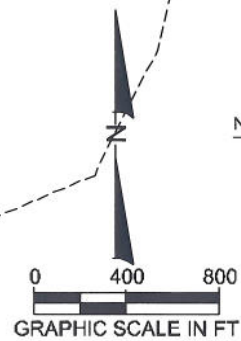

TITLE:
**CHALAND HEADLAND RESTORATION
(BA-38-2) CWPRA PROJECT
BORROW AREA D1 CUT DEPTHS MARSH MATERIAL**

2481 N.W. BOCA RATON BLVD.
BOCA RATON, FL 33431
PH. (561) 391-8102 FAX (561) 391-9116



DATE:
7/22/05

BY:
JRC

COMM NO.:
7900.05

SHEET:
19

NOTES:

- COORDINATES SHOWN HEREON ARE IN FEET BASED ON LOUISIANA STATE PLANE COORDINATE SYSTEM, SOUTH ZONE, NAD 1983.
- ALLOWABLE OVER DREDGE IS 3' (FEET) BELOW DESIGN CUT.

REVISIONS		
DATE	BY	DESCRIPTION

N 296000

E 3758000

E 3760000

N 296000

DREDGE CUTS NOTED ON THIS SHEET REFER TO REMOVAL ELEVATION OF BEACH AND DUNE CONSTRUCTION MATERIAL

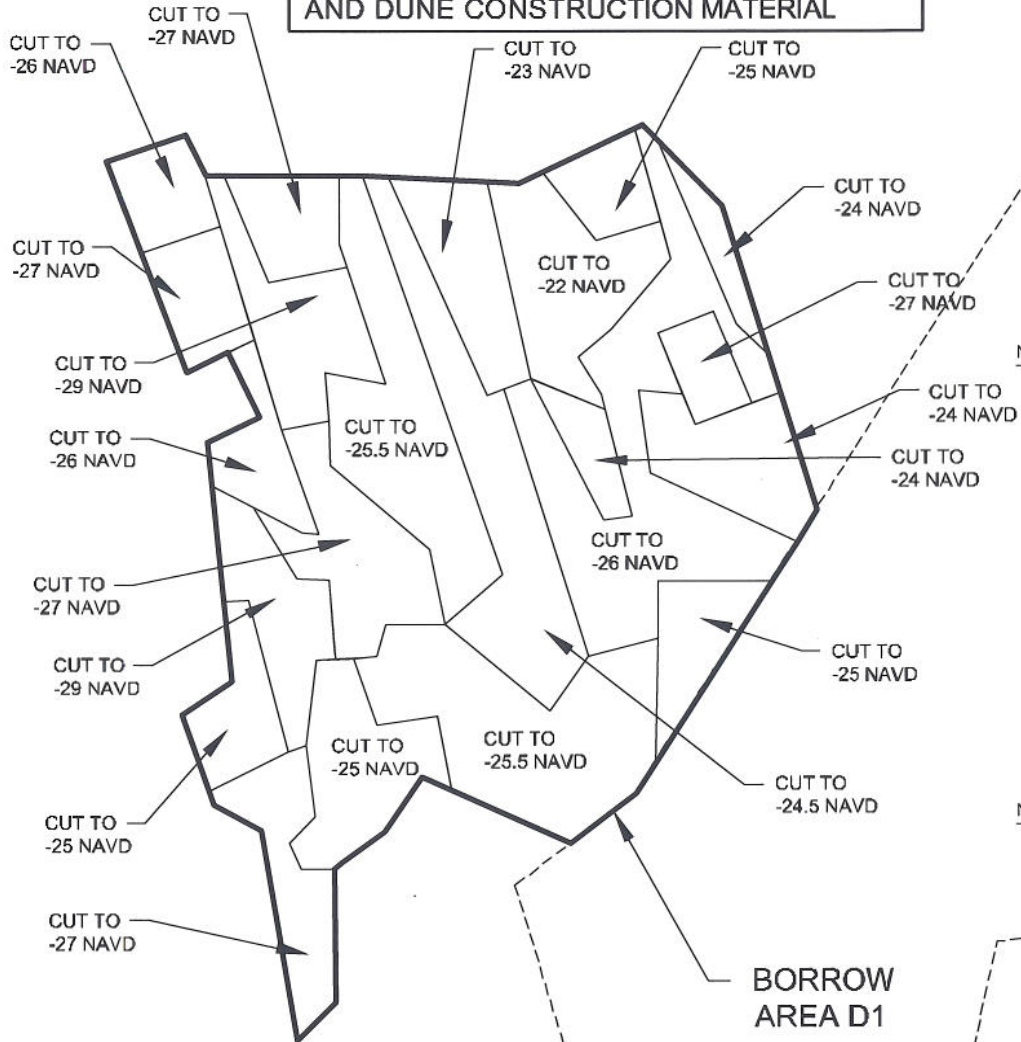

N 294000

N 294000

N 292000

N 292000

CHALAND HEADLAND RESTORATION (BA-38-2) CWPRA PROJECT BORROW AREA D1 BEACH & DUNE MATERIAL CUT DEPTHS

2481 N.W. BOCA RATON BLVD. BOCA RATON, FL 33431 PH: (561) 391-8102 FAX (561) 391-9116

COASTAL PLANNING & ENGINEERING, INC www.CoastalPlanning.net

LEGEND:

D1-E' NOTES: CROSS SECTION LABELS

1. COORDINATES SHOWN HEREON ARE IN FEET BASED ON LOUISIANA STATE PLANE COORDINATE SYSTEM, SOUTH ZONE, NAD 1983.
2. ELEVATIONS SHOWN HEREON ARE IN FEET BASED ON NAVD 1988.
3. DATE OF BATHYMETRIC SURVEY, SEISMIC SCAN, SIDE SCAN SONAR, AND MAGNETOMETER SURVEY: SEPTEMBER 2003, CONDUCTED BY CPE.
4. CONTOURS REPRESENT BOTTOM OF SAND LAYER.

DATE: 7/22/05

BY: JRC

COMM NO.: 7900.05

SHEET: 20



REVISIONS		
DATE	BY	DESCRIPTION

H:\Louisiana\1726107\PERMITS\CHALAND\Borrow Area PV D1.dwg - Sep 05, 2006 @ 5:03pm - dhbin

H:\Louisiana\1726107\PERMITS\CHALAND\Chaland Borrow Area PV D1.dwg - Sep 05, 2006 @ 5:04pm - drubin

N 296000

E 3758000

E 3760000

N 296000

N 294000

N 294000

N 292000

N 292000

N 290000

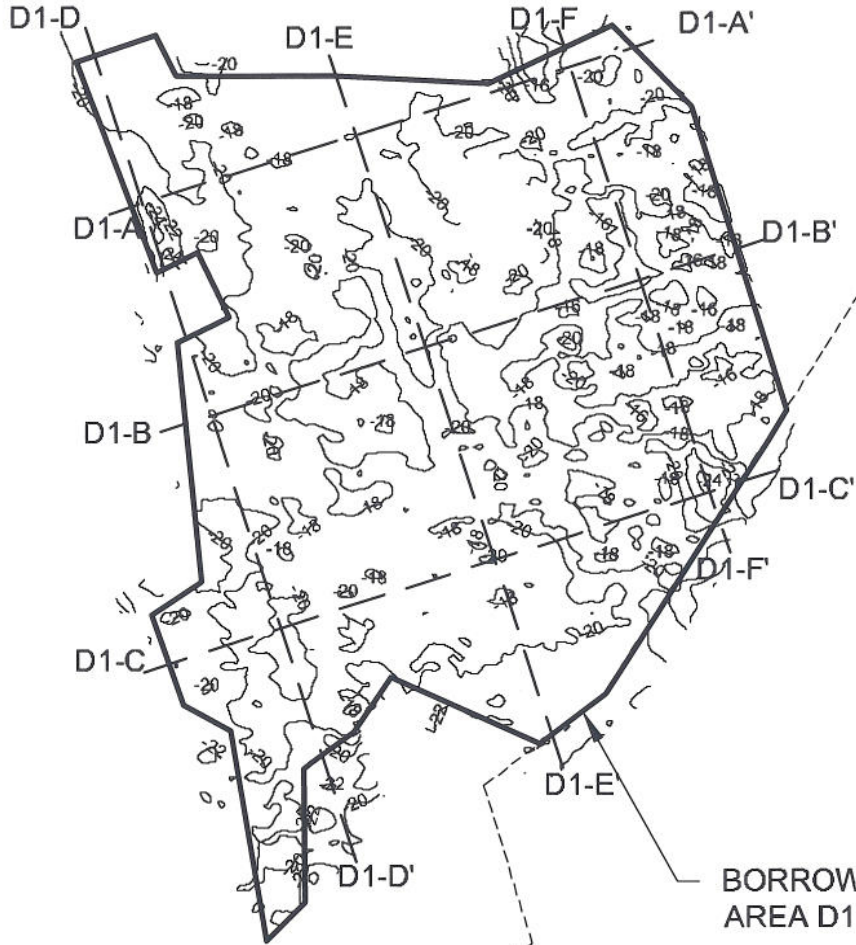

BORROW AREA
QUATRE BAYOU
(SEE SHEETS 4-6)

**GULF
OF
MEXICO**

**BORROW
AREA D1**

LEGEND:

D1-E' CROSS SECTION LABELS

NOTES:

1. COORDINATES SHOWN HEREON ARE IN FEET BASED ON LOUISIANA STATE PLANE COORDINATE SYSTEM, SOUTH ZONE, NAD 1983.
2. ELEVATIONS SHOWN HEREON ARE IN FEET BASED ON NAVD 1988.
3. DATE OF BATHYMETRIC SURVEY, SEISMIC SCAN, SIDE SCAN SONAR, AND
4. CONTOURS REPRESENT BOTTOM OF SILT/CLAY LAYER AND TOP OF SAND LAYER.



REVISIONS		
DATE	BY	DESCRIPTION

**CHALAND HEADLAND RESTORATION
(BA-38-2) CWPBRA PROJECT
BORROW AREA D1 SILT/CLAY ELEVATIONS**

TITLE:

2481 N.W. BOCA RATON BLVD.
BOCA RATON, FL 33431
PH: (561) 391-8102 FAX (561) 391-9116

COASTAL PLANNING & ENGINEERING, INC.
www.CoastalPlanning.net

DATE:
7/22/05

BY:
JRC

COMM NO.:
7900.05

SHEET:
21

H:\Louisiana\1726107\PERMITS\CHALAND\Chaland_Borrow Area PV D1.dwg - Sep 05, 2006 @ 5:04pm - dhubin

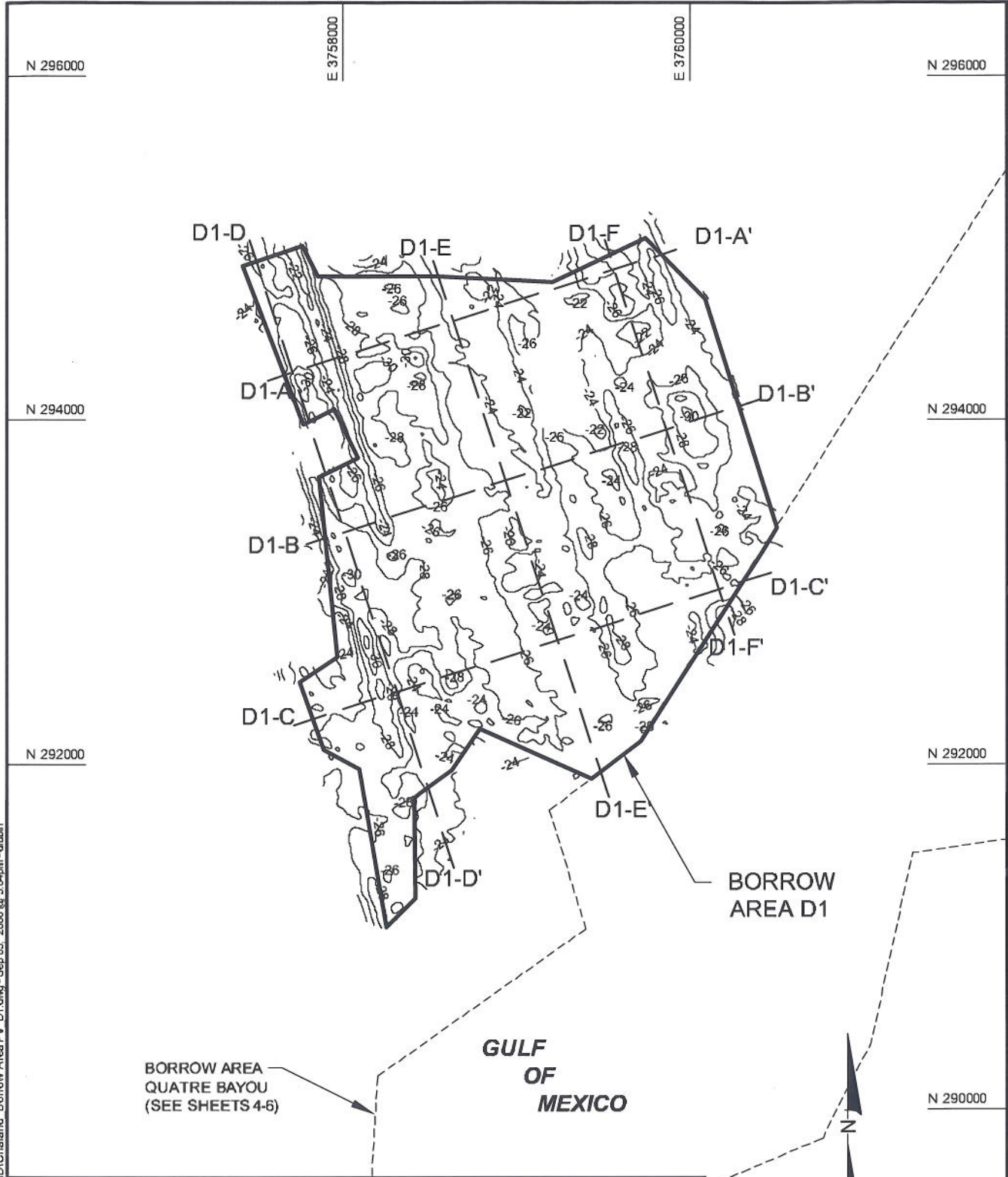

**CHALAND HEADLAND RESTORATION
(BA-38-2) CWPRA PROJECT
BORROW AREA D1 BEACH & DUNE MATERIAL CONTOURS**

TITLE:
2481 N.W. BOCA RATON BLVD.
BOCA RATON, FL 33431
PH. (561) 391-8102 FAX (561) 391-9116

COASTAL PLANNING & ENGINEERING, INC
www.CoastalPlanning.net

DATE: 7/22/05
BY: JRC
COMM NO.: 7900.05
SHEET: 22

LEGEND:

D1-E' CROSS SECTION LABELS

NOTES:

1. COORDINATES SHOWN HEREON ARE IN FEET BASED ON LOUISIANA STATE PLANE COORDINATE SYSTEM, SOUTH ZONE, NAD 1983.
2. ELEVATIONS SHOWN HEREON ARE IN FEET BASED ON NAVD 1988.
3. DATE OF BATHYMETRIC SURVEY, SEISMIC SCAN, SIDE SCAN SONAR, AND MAGNETOMETER SURVEY: SEPTEMBER 2003, CONDUCTED BY CPE.
4. CONTOURS REPRESENT BOTTOM OF SAND LAYER.

REVISIONS		
DATE	BY	DESCRIPTION

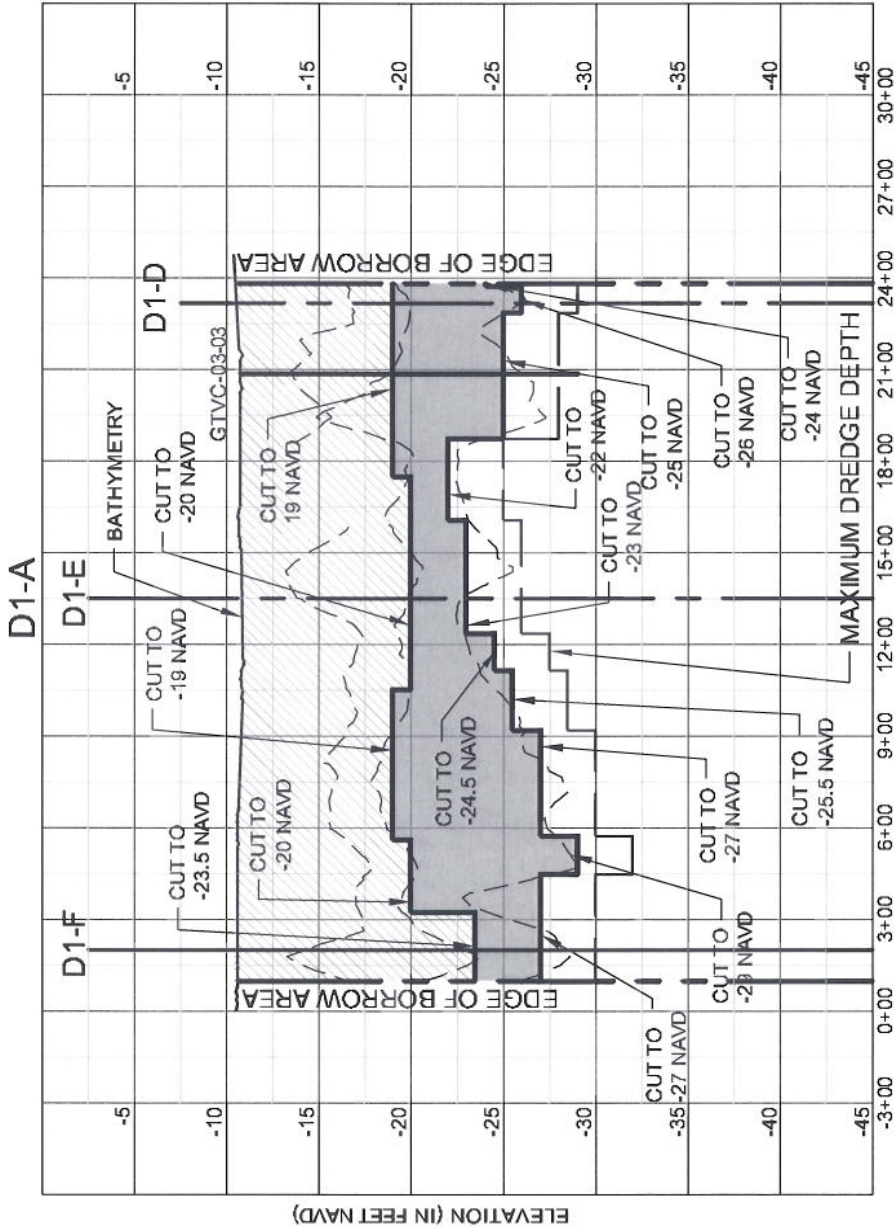

SCALE: HORZ. 1" = 600'
VERT. 1" = 10'

NOTES:

1. CORES MAY NOT FALL DIRECTLY ON CROSS SECTION LINE, BUT ARE LOCATED SUFFICIENTLY CLOSE TO REPRESENT SIMILAR MATERIAL.
2. WIDTH OF LAYERS IS REPRESENTATIVE ONLY. ACTUAL MATERIAL MAY VARY.
3. SEE PAGES 18, 21 & 22 FOR LOCATION OF CROSS SECTION LINE.
4. MAXIMUM DREDGE DEPTH 3 FEET BELOW DESIGN CUT DEPTH SHOWN.

LEGEND:

- MARSH FILL MATERIAL
- BEACH FILL MATERIAL
- SEISMIC REFLECTOR

REVISIONS		
DATE	BY	DESCRIPTION
09/05/06	STR	BORROW AREA D1 ADDED

DATE:	7/22/05
BY:	JRC
COMM NO.:	7900.05
SHEET:	23

COASTAL PLANNING & ENGINEERING, INC.
 2481 N.W. BOCA RATON BLVD.
 BOCA RATON, FL 33431
 PH. (561) 391-8102 FAX (561) 391-9116
www.CoastalPlanning.net

TITLE: **CHALAND HEADLAND RESTORATION
(BA-38-2) CWPRA PROJECT
BORROW AREA D1 CROSS SECTION D1-A**

D1-B

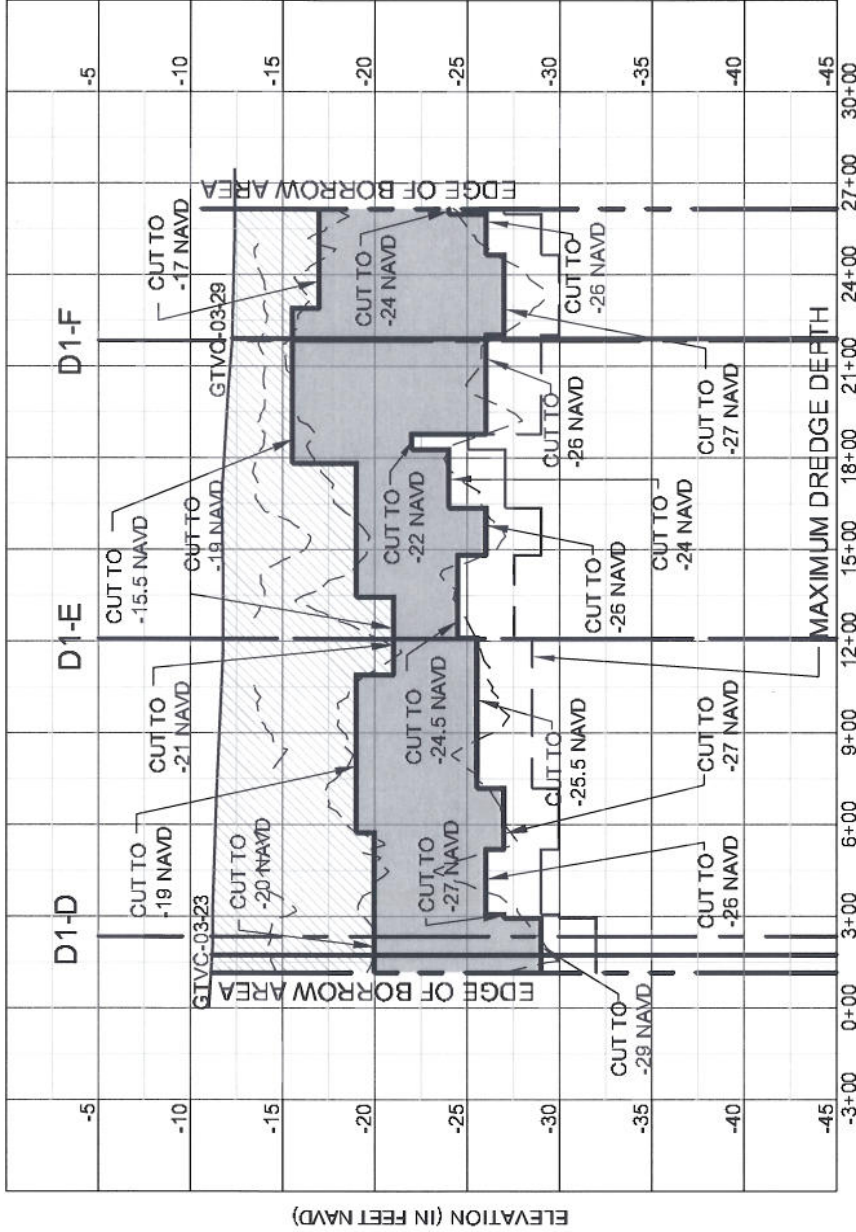

SCALE: HORZ. 1" = 600'
VERT. 1" = 10'

NOTES:

1. CORES MAY NOT FALL DIRECTLY ON CROSS SECTION LINE, BUT ARE LOCATED SUFFICIENTLY CLOSE TO REPRESENT SIMILAR MATERIAL.
2. WIDTH OF LAYERS IS REPRESENTATIVE ONLY. ACTUAL MATERIAL MAY VARY.
3. SEE PAGES 18, 21 & 22 FOR LOCATION OF CROSS SECTION LINE.
4. MAXIMUM DREDGE DEPTH 3 FEET BELOW DESIGN CUT DEPTH SHOWN.

LEGEND:

-  MARSH FILL MATERIAL
-  BEACH FILL MATERIAL
-  SEISMIC REFLECTOR

REVISIONS		
DATE	BY	DESCRIPTION
09/05/06	STR	BORROW AREA D1 ADDED

DATE:	7/22/05
BY:	JRC
COMM NO.:	7900.05
SHEET:	24

TITLE: CHALAND HEADLAND RESTORATION
(BA-38-2) CWPRA PROJECT
BORROW AREA D1 CROSS SECTION D1-B

2481 N.W. BOCA RATON BLVD.
BOCA RATON, FL 33431
PH. (561) 391-8102 FAX (561) 391-9116

COASTAL PLANNING & ENGINEERING, INC.
www.CoastalPlanning.net



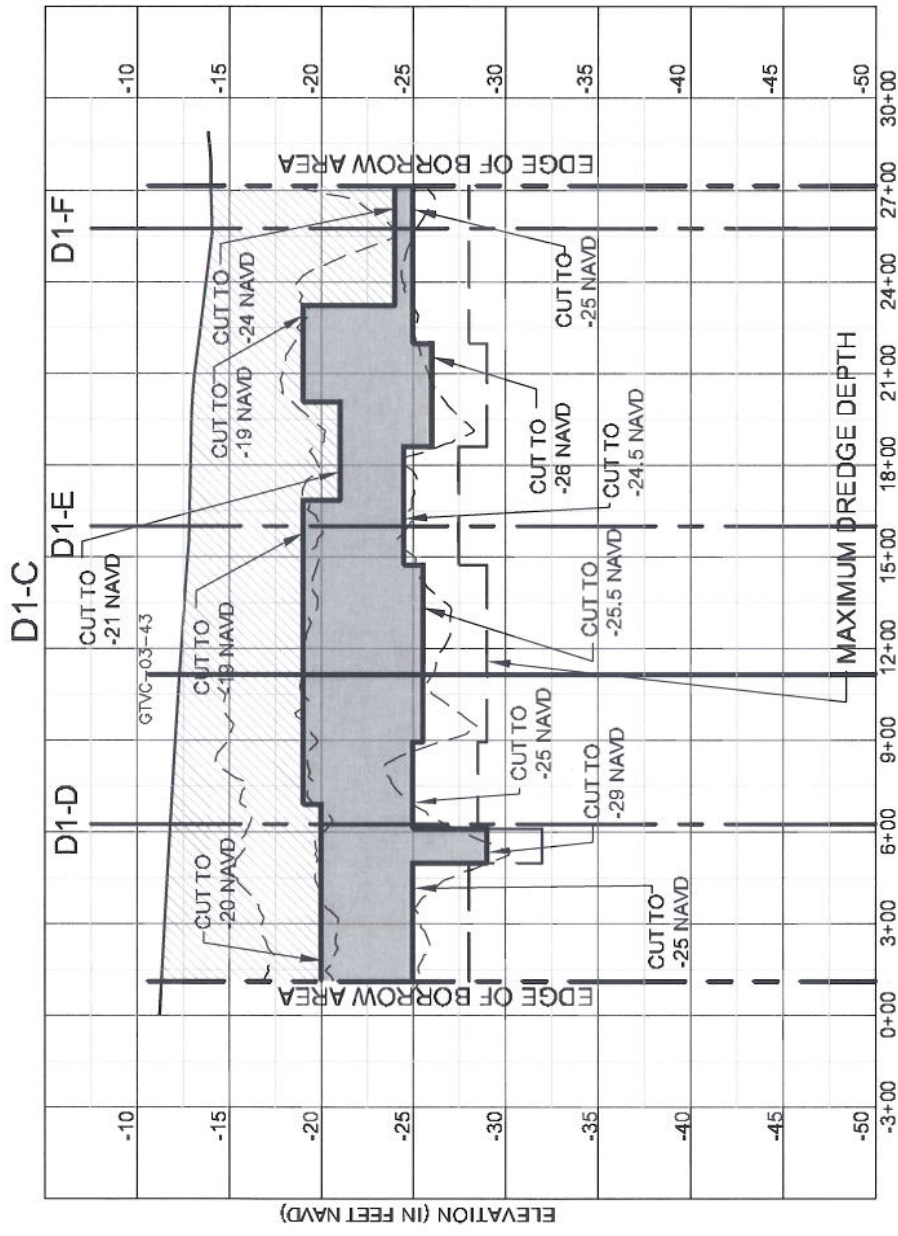

SCALE: HORZ. 1" = 600'
VERT. 1" = 10'

CHALAND HEADLAND RESTORATION
(BA-38-2) CWPPRA PROJECT
BORROW AREA D1 CROSS SECTION D1-C

2481 N.W. BOCA RATON BLVD.
BOCA RATON, FL 33431
PH. (561) 391-8102 FAX (561) 391-9116

COASTAL PLANNING & ENGINEERING, INC.
www.CoastalPlanning.net

NOTES:

1. CORES MAY NOT FALL DIRECTLY ON CROSS SECTION LINE, BUT ARE LOCATED SUFFICIENTLY CLOSE TO REPRESENT SIMILAR MATERIAL.
2. WIDTH OF LAYERS IS REPRESENTATIVE ONLY. ACTUAL MATERIAL MAY VARY.
3. SEE PAGES 18, 21 & 22 FOR LOCATION OF CROSS SECTION LINE.
4. MAXIMUM DREDGE DEPTH 3 FEET BELOW DESIGN CUT DEPTH SHOWN.

LEGEND:

-  MARSH FILL MATERIAL
-  BEACH FILL MATERIAL
-  SEISMIC REFLECTOR

REVISIONS	
DATE	DESCRIPTION
09/05/06	STR BORROW AREA D1 ADDED

DATE:	7/22/05
BY:	JRC
COMM NO.:	7900.05
SHEET:	25

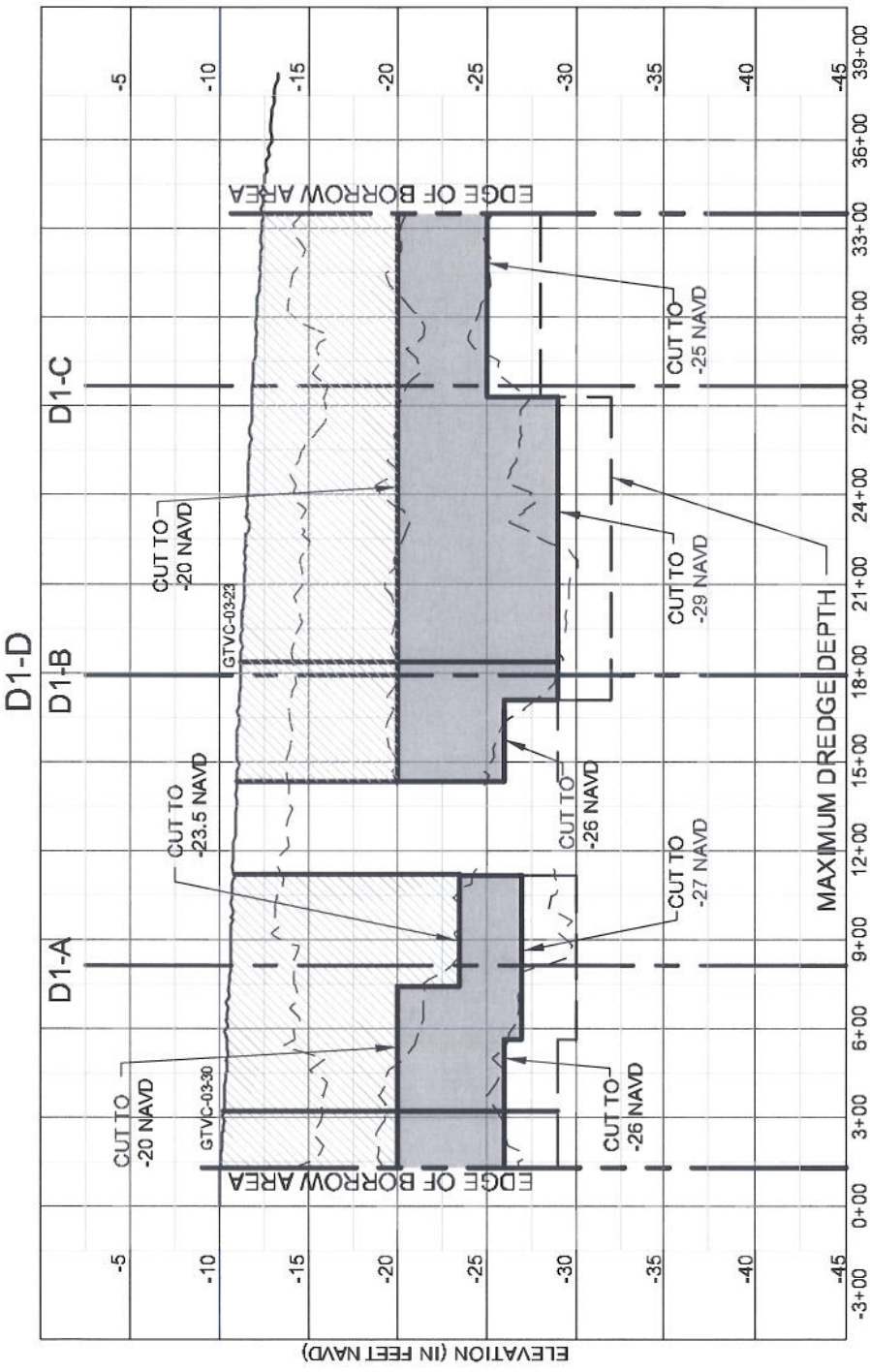

SCALE: HORZ. 1" = 600'
VERT. 1" = 10'

NOTES:

1. CORES MAY NOT FALL DIRECTLY ON CROSS SECTION LINE, BUT ARE LOCATED SUFFICIENTLY CLOSE TO REPRESENT SIMILAR MATERIAL.
2. WIDTH OF LAYERS IS REPRESENTATIVE ONLY. ACTUAL MATERIAL MAY VARY.
3. SEE PAGES 18, 21 & 22 FOR LOCATION OF CROSS SECTION LINE.
4. MAXIMUM DREDGE DEPTH 3 FEET BELOW DESIGN CUT DEPTH SHOWN

LEGEND:

-  MARSH FILL MATERIAL
-  BEACH FILL MATERIAL
-  SEISMIC REFLECTOR

REVISIONS	
DATE	DESCRIPTION
09/05/06	str BORROW AREA D1 ADDED

DATE:	7/22/05
BY:	JRC
COMM NO.:	7900.05
SHEET:	26

COASTAL PLANNING & ENGINEERING, INC.

2481 N.W. BOCA RATON BLVD.
BOCA RATON, FL 33431
PH. (561) 391-8102 FAX (561) 391-9116

TITLE

**CHALAND HEADLAND RESTORATION
(BA-38-2) CWPPRA PROJECT
BORROW AREA D1 CROSS SECTION D1-D**



D1-E

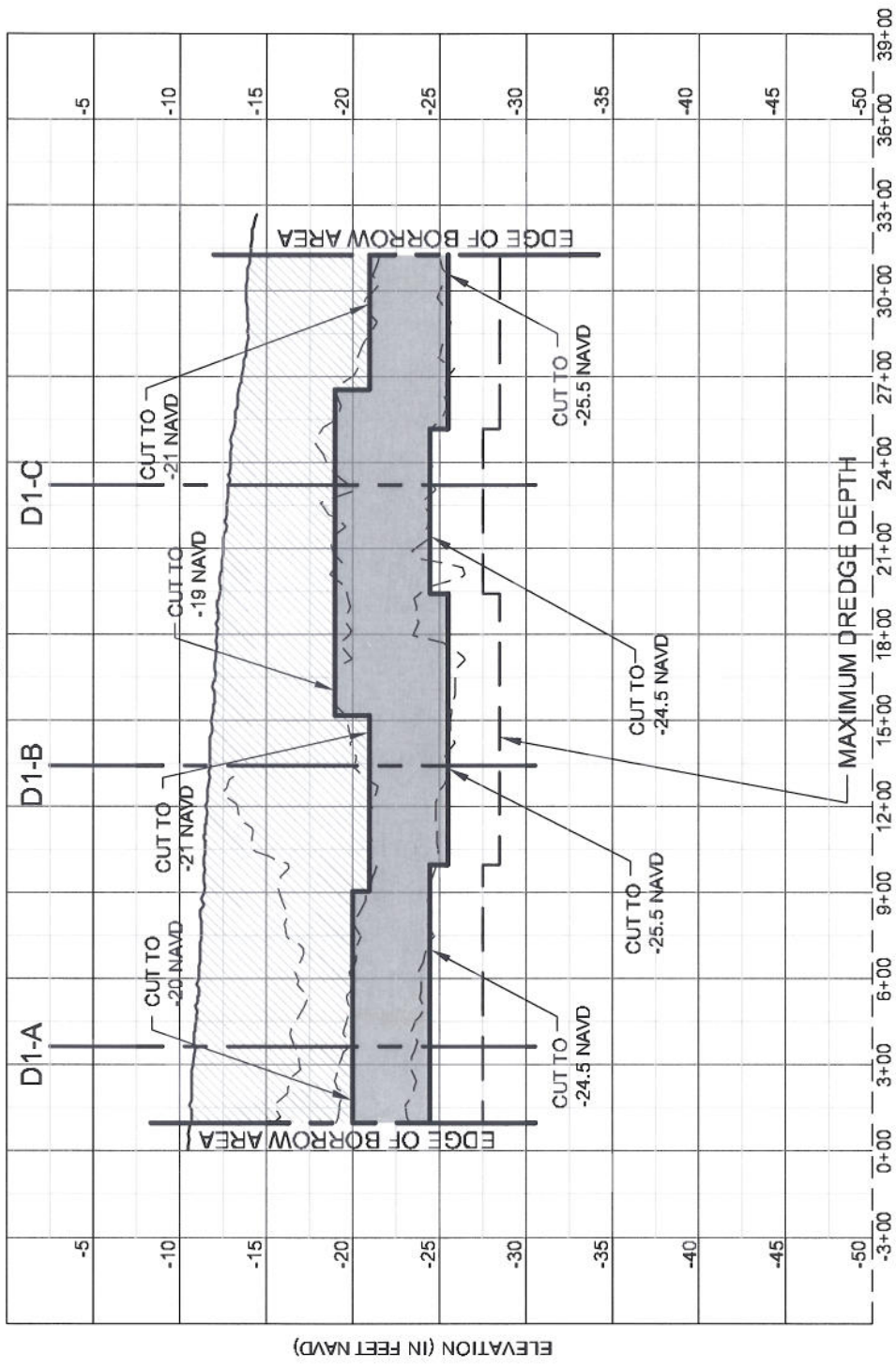

NOTES:

1. CORES MAY NOT FALL DIRECTLY ON CROSS SECTION LINE, BUT ARE LOCATED SUFFICIENTLY CLOSE TO REPRESENT SIMILAR MATERIAL.
2. WIDTH OF LAYERS IS REPRESENTATIVE ONLY. ACTUAL MATERIAL MAY VARY.
3. SEE PAGES 18, 21 & 22 FOR LOCATION OF CROSS SECTION LINE.
4. MAXIMUM DREDGE DEPTH 3 FEET BELOW DESIGN CUT DEPTH SHOWN.

LEGEND:

- MARSH FILL MATERIAL
- BEACH FILL MATERIAL
- SEISMIC REFLECTOR

REVISIONS		
DATE	BY	DESCRIPTION
09/05/06	STR	BORROW AREA D1 ADDED

SCALE: HORZ. 1" = 600'
VERT. 1" = 10'

**CHALAND HEADLAND RESTORATION
(BA-38-2) CWPPRA PROJECT
BORROW AREA D1 CROSS SECTION D1-E**

TITLE
2481 N.W. BOCA RATON BLVD.
BOCA RATON, FL 33431
PH. (561) 391-8102 FAX (561) 391-9116

COASTAL PLANNING & ENGINEERING, INC
www.CoastalPlanning.net

DATE:	7/22/05
BY:	JRC
COMM NO.:	7900.05
SHEET:	27

D1-F

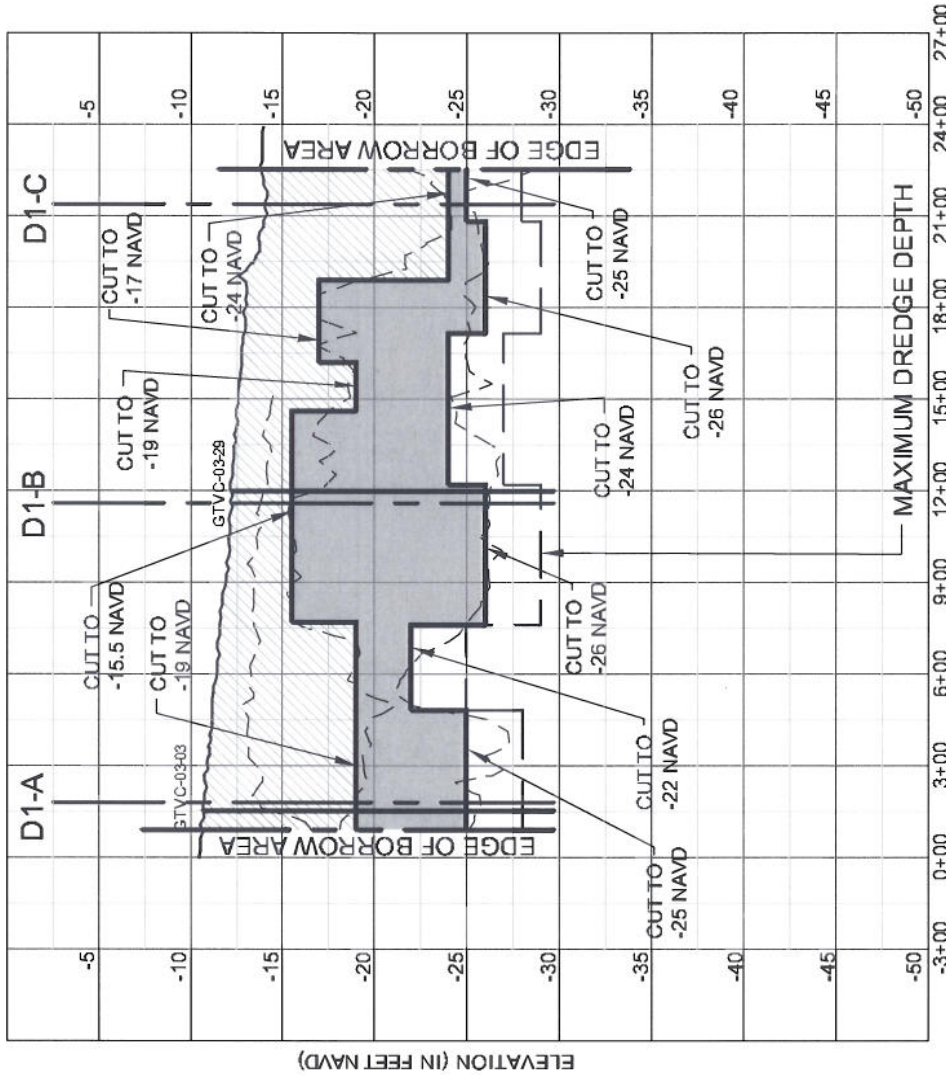

SCALE: HORZ. 1" = 600'
VERT. 1" = 10'

NOTES:

1. CORES MAY NOT FALL DIRECTLY ON CROSS SECTION LINE, BUT ARE LOCATED SUFFICIENTLY CLOSE TO REPRESENT SIMILAR MATERIAL.
2. WIDTH OF LAYERS IS REPRESENTATIVE ONLY. ACTUAL MATERIAL MAY VARY.
3. SEE PAGES 18, 21 & 22 FOR LOCATION OF CROSS SECTION LINE.
4. MAXIMUM DREDGE DEPTH 3 FEET BELOW DESIGN CUT DEPTH SHOWN.

LEGEND:

-  MARSH FILL MATERIAL
-  BEACH FILL MATERIAL
-  SEISMIC REFLECTOR

REVISIONS		
DATE	BY	DESCRIPTION
09/05/06	STR	BORROW AREA D1 ADDED

DATE:	7/22/05
BY:	JRC
COMM NO.:	7900.05
SHEET:	28

COASTAL PLANNING & ENGINEERING, INC.
 2481 N.W. BOCA RATON BLVD.
 BOCA RATON, FL 33431
 PH. (561) 391-8102 FAX (561) 391-9116
www.CoastalPlanning.net

TITLE

**CHALAND HEADLAND RESTORATION
 (BA-38-2) CWPPRA PROJECT
 BORROW AREA D1 CROSS SECTION D1-F**

Habitat Conservation Division
c/o Louisiana State University
Baton Rouge, Louisiana 70808-7535

October 3, 2006

F/SER44/RS:jk
225/389-0508

Mr. Gregory DuCote
Coastal Management Division
Louisiana Department of Natural Resources
Post Office Box 44487
Baton Rouge, Louisiana 70804-4497

Dear Mr. DuCote:

Reference is made to Coastal Zone Consistency C20030606 for the Chaland Headland restoration project (BA-38-2) located in Plaquemines Parish, Louisiana. The purpose of this letter is to request authorization for excavation of a supplemental borrow area to allow completion of the project as designed. The modification is required due to cut-to-fill ratios in excess of that anticipated during the design process.

The attached plats depict the location and extent of the proposed supplemental borrow area. It is anticipated that less than 500,000 cubic yards of material will be excavated from this area. The proposed supplemental borrow area has been through a complete cultural resources investigation, and no unavoidable resources were noted. Additionally, excavation of the supplemental borrow area has been modeled to assess potential changes in wave climate and shoreline erosion. The analyses suggest predicted wave heights are not anticipated to change due to excavation of the proposed borrow areas. The analyses also suggest that although minor changes in wave direction may occur, induced impacts to shoreline erosion are not anticipated.

Based on the enclosed information and draft construction plans and specifications, it is our determination that the proposed action is consistent with the Louisiana Coastal Resources Program.

We are requesting that you authorize this modification at the earliest possible time. Project construction is ongoing, and delayed authorization of the requested modification could result in termination of the construction contract. If you have any questions regarding the applications, the projects, or enclosed documents, please contact Rachel Sweeney at (225)389-0508. Thank you for your attention to this matter.

Sincerely,

Rachel Sweeney,
Project Manager

Enclosures