

**GENERAL NOTES**

- ALL ELEVATIONS ARE GIVEN IN THE NORTH AMERICAN VERTICAL DATUM OF 1988 (NAVD88-GE01099) U.S. SURVEY FEET (FEET). ALL HORIZONTAL COORDINATES ARE GIVEN IN THE NORTH AMERICAN DATUM OF 1983 (NAD83, LOUISIANA STATE PLANE SOUTH ZONE U.S. FEET). ELEVATIONS BASED ON A BENCHMARK PROVIDED BY LDNR, "RONQUILLE 2 - 2005". ELEVATION = 6.06 FEET (NAVD88-GE0103(05)). N: 297,126.23, E: 3,793,517.87 (NAD83, LSZ-1702). SEE APPENDIX A OF THE SPECIFICATIONS.
- TOPOGRAPHIC AND BATHYMETRIC SURVEYS WERE CONDUCTED BY SJB GROUP, LLC, AND COASTAL ENGINEERING CONSULTANTS, INC. IN 2007. MAGNETOMETER SURVEYS WERE CONDUCTED BY ALPINE OCEAN SEISMIC SURVEY INC. IN 2003 AND 2004. INFORMATION SHOWN HEREON REFLECTS CONDITIONS AS THEY EXISTED ON THE SURVEY DATE AND CAN ONLY BE CONSIDERED INDICATIVE OF THE CONDITIONS AT THAT TIME. RESULTS OF THE MAGNETOMETER SURVEY ARE PRESENTED IN APPENDIX B OF THE SPECIFICATIONS.
- AERIAL PHOTOGRAPHY OBTAINED FROM LOUISIANA ATLAS WEBSITE (<http://atlas.lsu.edu>). PHOTOGRAPHY FROM 2005 MAY NOT BE INDICATIVE OF CURRENT CONDITIONS.
- THE CONTRACTOR SHALL BE RESPONSIBLE FOR NOTIFYING PIPELINE AND UTILITY OPERATORS WITHIN 7 DAYS AFTER THE NOTICE TO PROCEED. ALL PIPELINES AND UNDERGROUND UTILITIES SHALL BE MARKED WITH BUOYS AND OR STAKES BY THE CONTRACTOR AND VERIFIED BY AUTHORIZED PIPELINE PERSONNEL. THE CONTRACTOR SHALL MAINTAIN BUOYS AND OR STAKES DURING CONSTRUCTION. IT IS THE CONTRACTORS RESPONSIBILITY TO MAINTAIN THE CLEARANCES FROM THE PIPELINES SET FORTH IN THE PLAN DRAWINGS OR IN THE BID DOCUMENTS. SEE GP-28 "UTILITIES AND IMPROVEMENTS" FOR ADDITIONAL REQUIREMENTS SET FORTH BY PIPELINE COMPANIES. NO EXCAVATION IS ALLOWED WITHIN ANY AREA RESTRICTED BY PIPELINE COMPANIES AND SET FORTH ON THE PLANS. THE FOLLOWING IS A LIST OF OPERATORS KNOWN TO HAVE PIPELINES IN THE VICINITY. PIPELINE LOCATIONS SHOWN ON SHEETS 4 - 7 AND 23 - 24 ARE APPROXIMATIONS. THE OWNER IS NOT LIABLE FOR EXACT LOCATIONS. THE CONTRACTOR MUST CALL LOUISIANA ONE CALL AT 1-800-272-3020 WITHIN 7 DAYS AFTER THE NOTICE TO PROCEED.

**2-20" AND 24" JGP GAS PIPELINE:**  
 CONTACT: KURT CHERAMIE  
 TITLE: LAND MANAGER-R-O-W AGENT  
 EMAIL: KURT.CHERAMIE@ELPASO.COM  
 PHONE: 985-223-6417  
 ADDRESS: TENNESSEE GAS PIPELINE CO.  
 158 REGAL ROW  
 HOUMA, LA 70360

**B" ENTERPRISE PRODUCTS/PROMIX LINE:**  
 CONTACT: CLINT KIFFE  
 TITLE: REPRESENTATIVE  
 PHONE: 225-571-2517  
 EMAIL: CKIFFE@EPROD.COM  
 ADDRESS: ENTERPRISE PRODUCTS  
 2727 NORTH LOOP WEST  
 HOUSTON, TX 77008-1044  
 P. O. BOX 4324  
 HOUSTON, TX 77210-4324

**12 AND 18" SNG GAS PIPELINES:**  
 CONTACT: KURT CHERAMIE  
 TITLE: LAND MANAGER-R-O-W AGENT  
 EMAIL: KURT.CHERAMIE@ELPASO.COM  
 PHONE: 985-223-6417  
 ADDRESS: SOUTHERN NATURAL GAS  
 2400 BAYOU ROAD  
 ST. BERNARD, LA 70085

- PLANS AND BID DOCUMENTS ARE COMPLIMENTARY, WHAT IS REQUIRED IN ONE IS AS BINDING AS IF REQUIRED BY ALL CLARIFICATIONS AND INTERPRETATIONS OF, OR NOTIFICATIONS OF MINOR VARIATIONS AND DEVIATIONS IN THE CONTRACT DOCUMENTS, WILL BE ISSUED BY THE OWNER OR ENGINEER.
- MEAN HIGH WATER (MHW) AND MEAN LOW WATER (MLW) ARE BASED ON TIDAL DATUM OBTAINED FROM THE NOAA OPERATED TIDE STATION, "GRAND ISLE - EAST POINT", STATION DESIGNATION 8761724. TIDAL EPOCH REFERENCED AT TIDE STATION WAS "5-YEAR SPECIAL UPDATE TO 1960-1978 TIDAL EPOCH". ELEVATIONS ARE REFERENCED TO NAVD88 (GE01099), US FEET.
- LANDOWNERS AFFECTED BY THE PROJECT ARE SHOWN ON SHEET 3. THE CONTRACTOR SHALL REFER TO SPECIAL PROVISION SP-4 "LANDOWNER REQUIREMENTS" IN THE SPECIFICATIONS FOR COORDINATION WITH THESE LANDOWNERS. CONTACT INFORMATION FOR THESE LANDOWNERS ARE LISTED BELOW:

**PLAQUEMINES PARISH GOVERNMENT:**  
 CONTACT: ALBERTINE KIMBLE  
 PHONE: 504-392-6690  
 ADDRESS: PLAQUEMINES PARISH GOVERNMENT  
 8056 HWY. 23, SUITE 308  
 BELLE CHASSE, LA 70037

**PLAQUEMINES PARISH SCHOOL BOARD:**  
 CONTACT: JAMES C. HOYLE, SUPERINTENDENT  
 PHONE: 504-392-4970  
 ADDRESS: PLAQUEMINES PARISH SCHOOL BOARD  
 P.O. BOX 69  
 BELLE CHASSE, LA 70037

**BREARLEY:**  
 CONTACT: WILLIAM CHRISTIAN, JR  
 PHONE: 713-975-1119  
 ADDRESS: 5937 STONES THROW ROAD  
 HOUSTON, TX 77057

**SUMMARY OF ESTIMATED QUANTITIES**  
**SCHEDULE OF BID ITEMS**

ITEM No.	DESCRIPTION	UNIT	ESTIMATED QUANTITY
1	MOBILIZATION/DEMOBILIZATION	LUMP SUM	1
2	SURVEYING	LUMP SUM	1
3	ACCESS CHANNEL	LUMP SUM	1
4	MARSH FILL	CUBIC YARDS	1,123,400
5	CONTAINMENT DIKE	LINEAR FEET	27,300
6	BEACH AND DUNE FILL	CUBIC YARDS	1,744,800
7	WATER EXCHANGE CHANNEL	LINEAR FEET	4,160
8	SAND FENCING	LINEAR FEET	14,400
9	SETTLEMENT PLATES	EACH	6
10	WARNING SIGNS	EACH	12
11	OVERBURDEN CUT	CUBIC YARDS	2,344,600

ESTIMATED QUANTITIES SHOWN ARE FOR BIDDING PURPOSES ONLY AND WERE CALCULATED ACCORDING TO CONDITIONS SURVEYED IN APRIL, 2007. SETTLEMENT OF THE DREDGE MATERIAL IS NOT INCLUDED IN THE BID QUANTITIES. ACTUAL QUANTITIES WILL BE BASED ON A SURVEY DONE AS PART OF THIS CONTRACT AS REQUIRED IN TS-6 "SURVEYING" OF THE SPECIFICATIONS. THE OWNER RESERVES THE RIGHT TO ADJUST QUANTITIES HIGHER OR LOWER WITHOUT ADJUSTMENT OF THE UNIT PRICE.



DATE: OCT. 2007	SHEETS: 4 OF 29
DESIGNED: T.M.A.	DRAWN: R.P.G./J.S.D.
CHECKED: M.T.P.	SCALE: AS NOTED
STATE PROJECT NUMBER: BA-35	FEDERAL PROJECT NUMBER: BA-35
APPROVED BY: R.J.J.	

LOUISIANA DEPARTMENT OF NATURAL RESOURCES  
**PASS CHALAND TO GRAND BAYOU PASS  
 BARRIER SHORELINE RESTORATION (BA-35)**  
 FILL AREA LAYOUT

**SJB GROUP**  
 P.O. BOX 1751  
 BATON ROUGE, LA 70821  
 PHONE (225) 789-3400  
 FAX (225) 789-3588

**COASTAL ENGINEERING CONSULTANTS**  
 P.H. (225) 643-2324  
 FAX: (225) 643-1143  
 3106 SOUTH HORSESHOE DRIVE  
 MAPLES, FLORIDA 34104

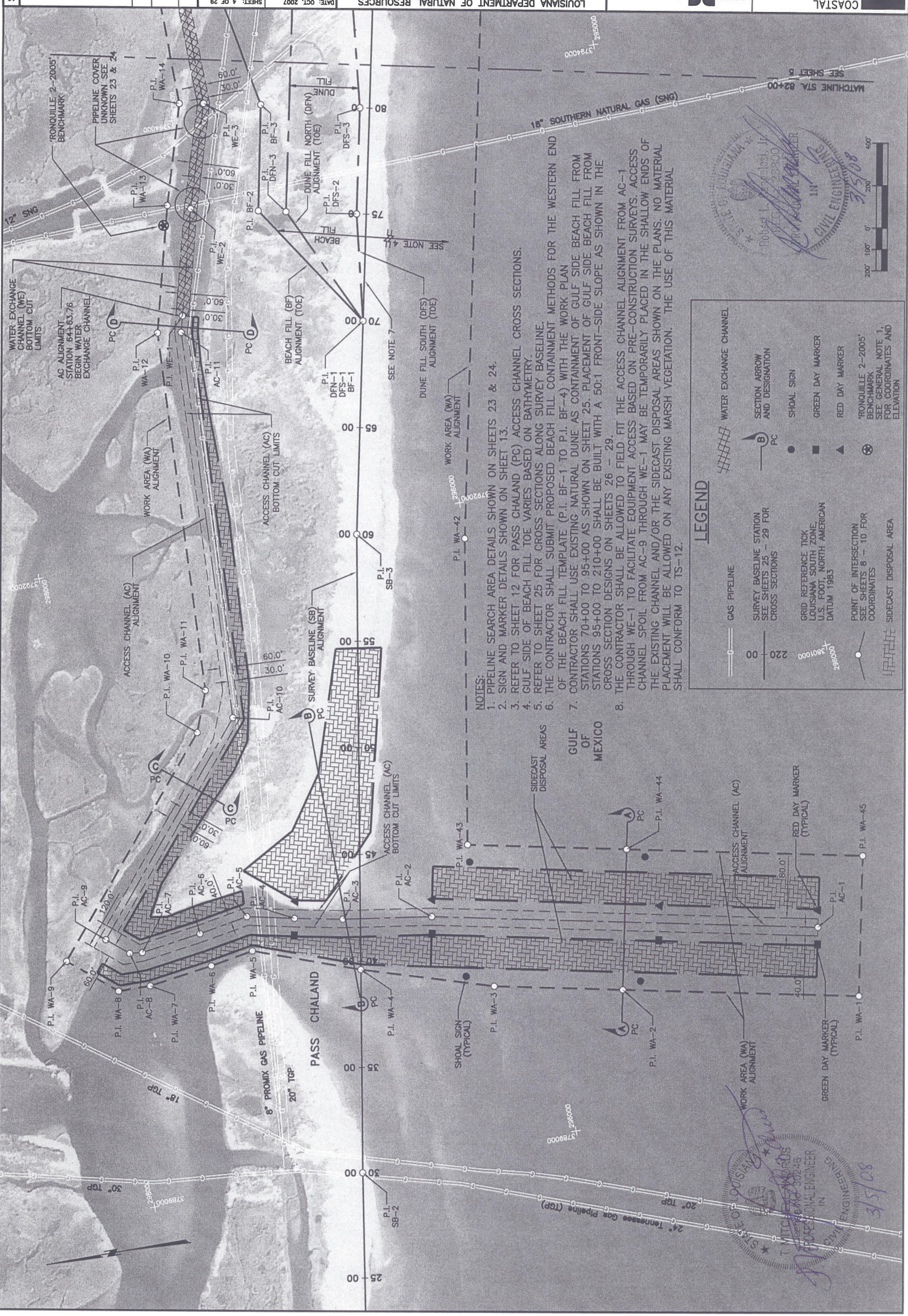

**NOTES:**

1. PIPELINE SEARCH AREA DETAILS SHOWN ON SHEETS 23 & 24.
2. SIGN AND MARKER DETAILS SHOWN ON SHEET 13.
3. REFER TO SHEET 12 FOR PASS CHALAND (PC) ACCESS CHANNEL CROSS SECTIONS.
4. GULF SIDE OF BEACH FILL TOE VARIES BASED ON BATHYMETRY.
5. REFER TO SHEET 25 FOR CROSS SECTIONS ALONG SURVEY BASELINE.
6. THE CONTRACTOR SHALL SUBMIT PROPOSED BEACH FILL CONTAINMENT METHODS FOR THE WESTERN END OF THE BEACH FILL TEMPLATE (P.I. BF-1 TO P.I. BF-4) WITH THE WORK PLAN.
7. CONTRACTOR SHALL USE EXISTING NATURAL DUNE AS CONTAINMENT OF GULF SIDE BEACH FILL FROM STATIONS 70+00 TO 95+00 AS SHOWN ON SHEET 25. PLACEMENT OF GULF SIDE BEACH FILL FROM STATIONS 95+00 TO 210+00 SHALL BE BUILT WITH A 50:1 FRONT-SIDE SLOPE AS SHOWN IN THE CROSS SECTION DESIGNS ON SHEETS 26 - 29.
8. THE CONTRACTOR SHALL BE ALLOWED TO FIELD FIT THE ACCESS CHANNEL ALIGNMENT FROM AC-1 THROUGH WE-1 TO FACILITATE EQUIPMENT ACCESS BASED ON PRE-CONSTRUCTION SURVEYS. ACCESS CHANNEL SPOIL FROM AC-9 THROUGH WE-1 MAY BE TEMPORARILY PLACED IN THE SHALLOW ENDS OF THE EXISTING CHANNEL AND/OR THE SIDECAST DISPOSAL AREAS SHOWN ON THE PLANS. NO MATERIAL PLACEMENT WILL BE ALLOWED ON ANY EXISTING MARSH VEGETATION. THE USE OF THIS MATERIAL SHALL CONFORM TO TS-12.

**LEGEND**

	GAS PIPELINE		WATER EXCHANGE CHANNEL
	SURVEY BASELINE STATION SEE SHEETS 25 - 29 FOR CROSS SECTIONS		SECTION ARROW AND DESIGNATION
	GRID REFERENCE TICK LOUISIANA SOUTH ZONE U.S. FOOT, NORTH AMERICAN DATUM 1983		SHOAL SIGN
	POINT OF INTERSECTION SEE SHEETS 8 - 10 FOR COORDINATES		GREEN DAY MARKER
	SIDECAST DISPOSAL AREA		RED DAY MARKER
			'RONQUILLE 2-2005' BENCHMARK SEE GENERAL NOTE 1, FOR COORDINATES AND ELEVATION

STATE OF LOUISIANA  
 PROFESSIONAL ENGINEER  
 T. MITCHELL ANDRUS  
 LICENSE NO. 38246  
 8/5/08

STATE OF LOUISIANA  
 PROFESSIONAL ENGINEER  
 T. MITCHELL ANDRUS  
 LICENSE NO. 38246  
 8/5/08



SEE SHEET 3  
 MATCHLINE STA 82+00

- NOTES:**
1. PIPELINE SEARCH AREA DETAILS SHOWN ON SHEETS 23 & 24. REFER TO SHEET 11 FOR TYPICAL SECTION.
  2. REFER TO SHEET 11 FOR TYPICAL SECTION.
  3. REFER TO SHEET 11 FOR POST-CONSTRUCTION CHANNEL PLUG TYPICAL SECTION.
  4. GULF SIDE OF BEACH FILL TOE VARIES BASED ON BATHYMETRY.
  5. REFER TO SHEETS 25-27 FOR CROSS SECTIONS ALONG SURVEY BASELINE.
  6. THE CONTRACTOR SHALL SUBMIT PROPOSED BEACH FILL CONTAINMENT METHODS FOR THE WESTERN END OF THE BEACH FILL TEMPLATE (P.I. BF-1 TO P.I. BF-4) WITH THE WORK PLAN.
  7. CONTRACTOR SHALL USE EXISTING NATURAL DUNE AS CONTAINMENT OF GULF SIDE BEACH FILL FROM STATIONS 70+00 TO 95+00. PLACEMENT OF GULF SIDE BEACH FILL FROM STATIONS 95+00 TO 210+00 SHALL BE BUILT WITH A 50:1 FRONT-SIDE SLOPE AS SHOWN IN THE CROSS SECTION DESIGNS ON SHEETS 26 - 25.

- NOTES CONTINUED:**
8. CHANNEL ALIGNMENT ADJUSTMENTS FOR THE WATER EXCHANGE CHANNEL FROM WE-1 THROUGH WE-9, AND THE ACCESS CHANNEL FROM WE-9 THROUGH AC-33 SHALL BE SUBMITTED IN THE WORK PLAN FOR APPROVAL AND SHALL CONFORM TO TS-12 AND THE TYPICAL SECTION SHOWN ON SHEET 11.

SHEET: 5

REV.	DATE	BY	DESCRIPTION
1	3/4/08	TMA	ADDITION

DATE: OCT. 2007  
 SHEETS: 5 OF 29  
 DRAWN: R.F.G./J.S.D.  
 CHECKED: M.T.P.  
 SCALE: AS NOTED  
 STATE PROJECT NUMBER: BA-35  
 FEDERAL PROJECT NUMBER: BA-35  
 APPROVED BY: R.J.J.

LOUISIANA DEPARTMENT OF NATURAL RESOURCES  
 PASS CHALAND TO GRAND BAYOU PASS  
 BARRIER SHORELINE RESTORATION (BA-35)  
 FILE AREA LAYOUT

SJB GROUP  
 P.O. BOX 1751  
 BAYOU ROUGE, LA. 70821  
 PHONE (225) 769-3400  
 FAX (225) 769-3588

COASTAL ENGINEERING CONSULTANTS  
 PH: (239) 643-2324  
 FAX: (239) 643-1143  
 3106 SOUTH HORSESHOE DRIVE  
 NAPLES, FLORIDA 34104

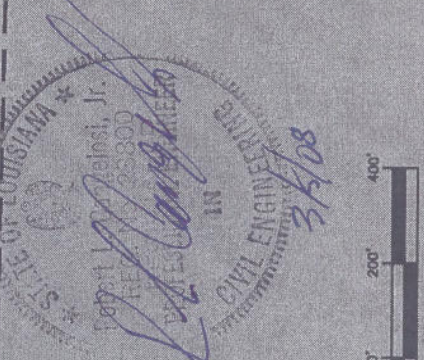
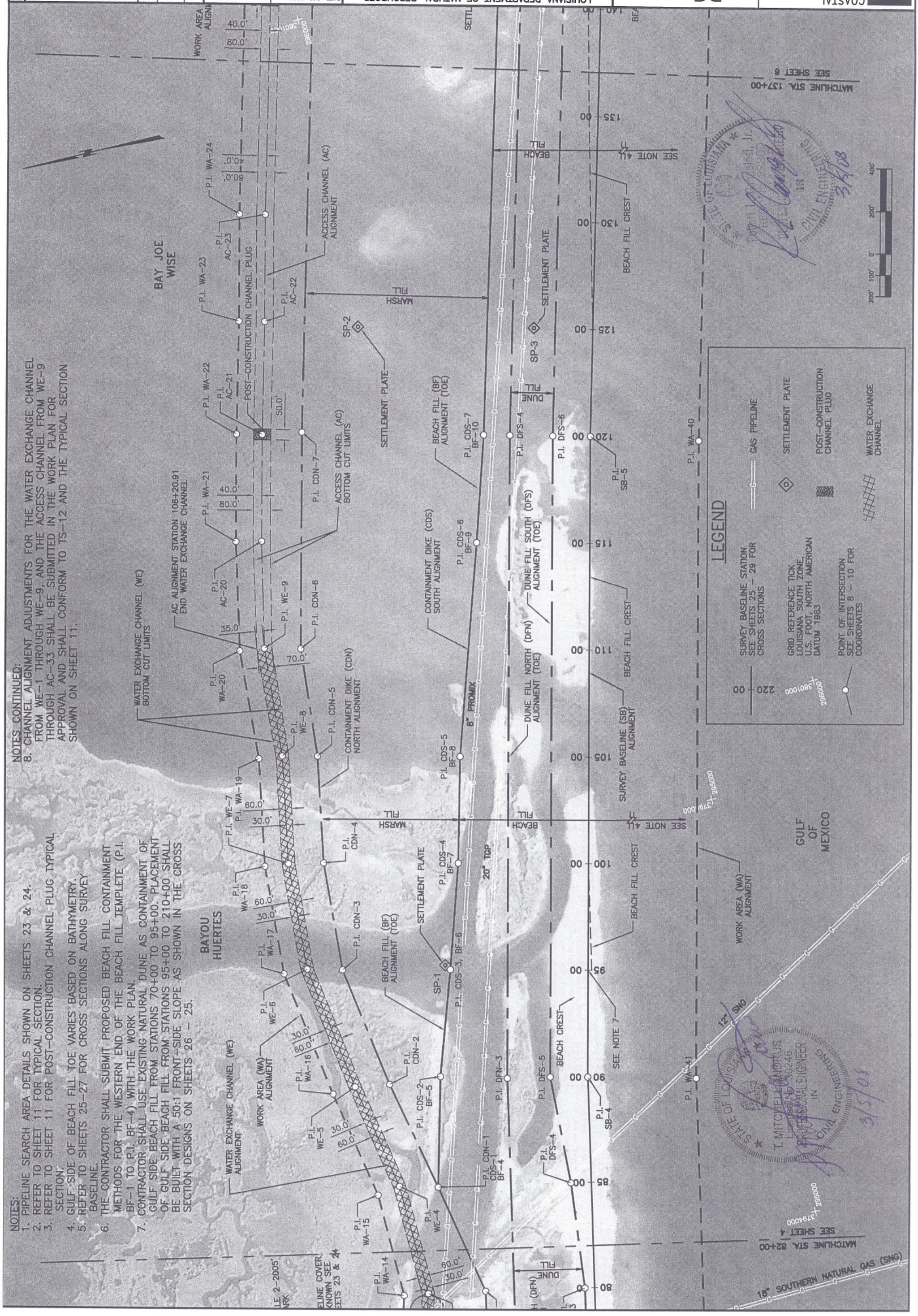

**LEGEND**

- GAS PIPELINE
- SURVEY BASELINE STATION SEE SHEETS 25 - 29 FOR CROSS SECTIONS
- SETTLEMENT PLATE
- POST-CONSTRUCTION CHANNEL PLUG
- WATER EXCHANGE CHANNEL
- POINT OF INTERSECTION SEE SHEETS 8 - 10 FOR COORDINATES
- GRID REFERENCE TICK LOUISIANA SOUTH ZONE, U.S. FOOT, NORTH AMERICAN DATUM 1983



MATCHLINE STA. R2+00  
 SEE SHEET 4  
 19" SOUTHERN NATURAL GAS (SNG)

MATCHLINE STA. 137+00  
 SEE SHEET 6

LINE COVER KNOWN SEE SHEETS 23 & 24

WORK AREA ALIGN

BAYOU HUERTES

BAY JOE WISE

GULF OF MEXICO

20' TGP

8" PROMIX

298000

298000

298000

DATE: OCT. 2007	SHEETS: 6 OF 29
DESIGNED: T.M.A.	DRAWN: R.P.G./J.S.D.
CHECKED: M.T.P.	SCALE: AS NOTED
STATE PROJECT NUMBER: BA-35	
FEDERAL PROJECT NUMBER: BA-35	
APPROVED BY: R.J.J.	
DATE: 3/4/08	T.M.A.
BY:	APPENDUM 02

LOUISIANA DEPARTMENT OF NATURAL RESOURCES  
**PASS CHALAND TO GRAND BAYOU PASS  
 BARRIER SHORELINE RESTORATION (BA-35)**  
 FILL AREA LAYOUT

**STB GROUP**  
 LLC.  
 3106 SOUTH HORSESHOE DRIVE  
 BATON ROUGE, LA. 70821  
 PHONE (225) 789-3400  
 FAX (225) 789-3588

**COASTAL ENGINEERING CONSULTANTS**  
 PH: (239) 643-2324  
 FAX: (239) 643-1143  
 3106 SOUTH HORSESHOE DRIVE  
 NAPLES, FLORIDA 34104

- NOTES:**
1. PIPELINE SEARCH AREA DETAILS SHOWN ON SHEETS 23 & 24.
  2. REFER TO SHEET 11 FOR TYPICAL SECTION.
  3. REFER TO SHEET 11 FOR POST-CONSTRUCTION CHANNEL PLUG TYPICAL SECTION.
  4. GULF SIDE OF BEACH FILL TOE VARIES BASED ON BATHYMETRY.
  5. REFER TO SHEETS 27 - 29 FOR CROSS SECTIONS ALONG SURVEY BASELINE.
  6. CHANNEL ALIGNMENT ADJUSTMENTS FOR THE ACCESS CHANNEL FROM WE-9 THROUGH AC-33 SHALL BE SUBMITTED IN THE WORK PLAN FOR APPROVAL AND SHALL CONFORM TO TS-12 AND THE TYPICAL SECTION SHOWN ON SHEET 11.

**BAY JOE WISE**

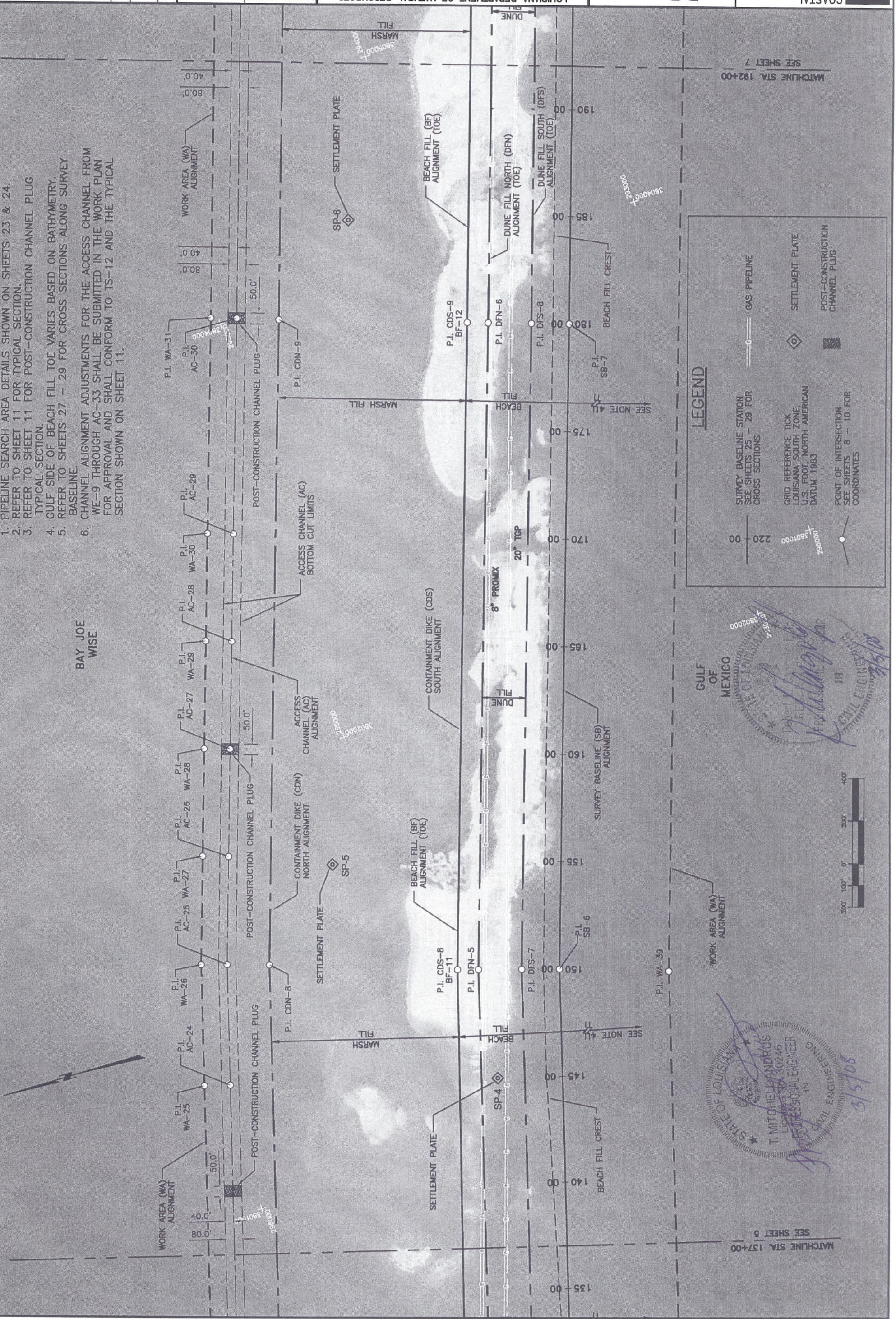

**LEGEND**

- SURVEY BASELINE STATION SEE SHEETS 25 - 29 FOR CROSS SECTIONS
- GRID REFERENCE TICK LOUISIANA SOUTH ZONE U.S. FOOT, NORTH AMERICAN DATUM 1983
- POINT OF INTERSECTION SEE SHEETS B - 10 FOR COORDINATES
- GAS PIPELINE
- SETTLEMENT PLATE
- POST-CONSTRUCTION CHANNEL PLUG

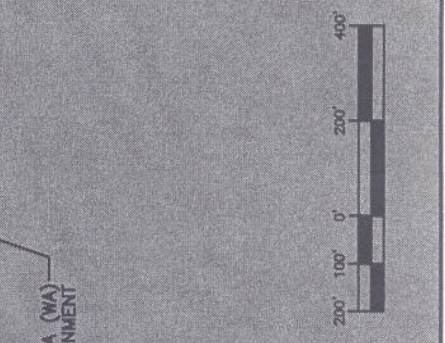

MATCHLINE STA. 137+00  
 SEE SHEET 5

MATCHLINE STA. 192+00  
 SEE SHEET 7

DATE: OCT. 2007	SHEETS: 7 OF 29
DESIGNED: T.M.A.	DRAWN: R.P.G./J.S.D.
CHECKED: M.T.P.	SCALE: AS NOTED
STATE PROJECT NUMBER: BA-35	FEDERAL PROJECT NUMBER: BA-35
APPROVED BY: R.J.J.	REV. DATE
	1 3/4/08 TMA
	ADDDNDUM 02
	DESCRIPTION

LOUISIANA DEPARTMENT OF NATURAL RESOURCES  
**PASS CHALAND TO GRAND BAYOU PASS  
 BARRIER SHORELINE RESTORATION (BA-35)**  
 FILL AREA LAYOUT

**SJB GROUP**  
 P.O. BOX 1751  
 BAYOU ROUGE, LA. 70821  
 PHONE (225) 789-3400  
 FAX (225) 789-3598

**COASTAL ENGINEERING CONSULTANTS**  
 P.H. (225) 643-2324  
 FAX: (225) 643-1143  
 3106 SOUTH HORSESHOE DRIVE  
 NAPLES, FLORIDA 34104

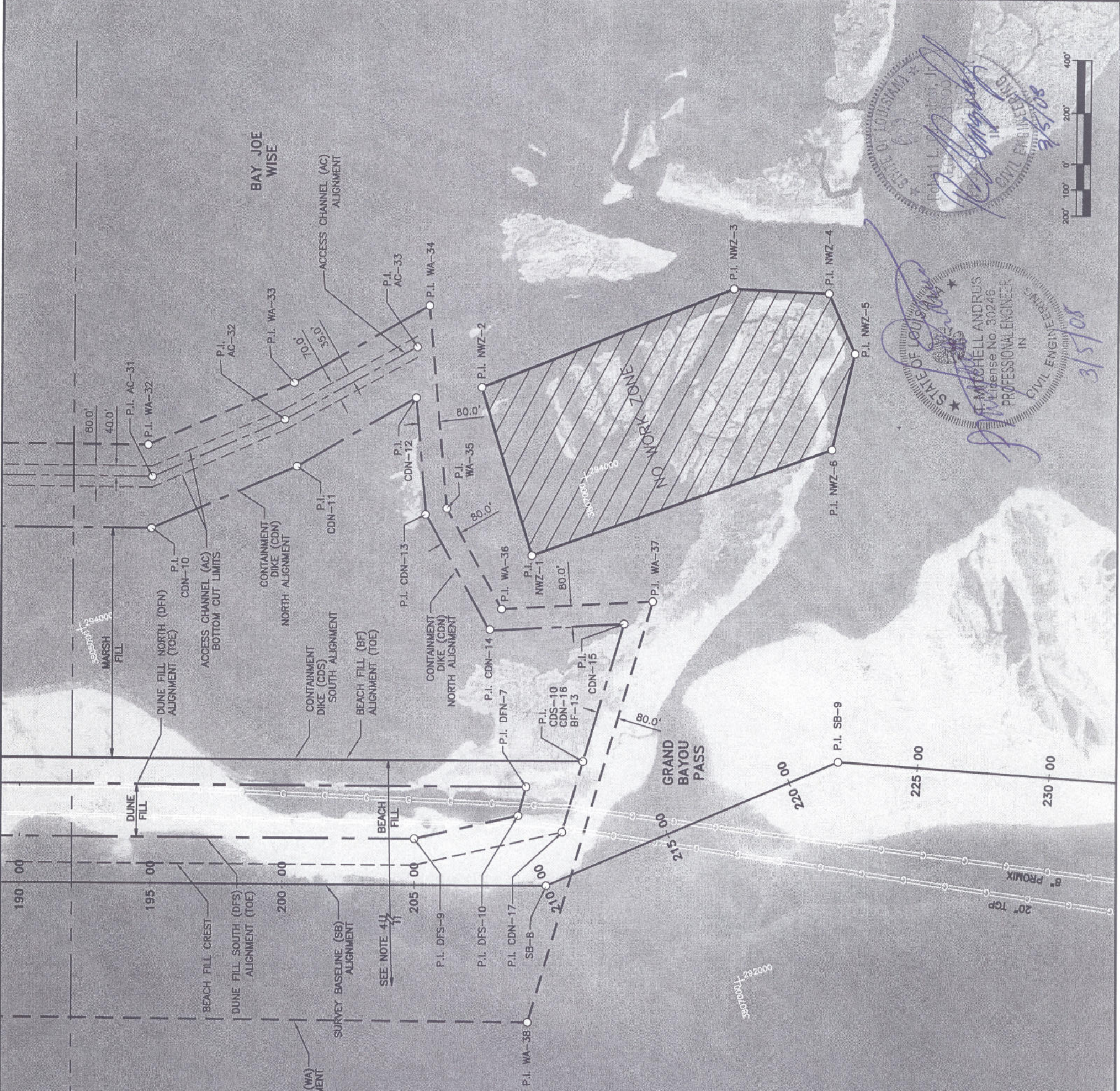

MATCHLINE STA. 192+00  
 SEE SHEET 6



- NOTES:**
1. PIPELINE SEARCH AREA DETAILS SHOWN ON SHEETS 23 & 24.
  2. REFER TO SHEET 29 FOR CROSS SECTIONS ALONG SURVEY BASELINE.
  3. NO WORK SHALL BE CONDUCTED IN THE NO WORK ZONE. SEE TS-4.2 "NO WORK ZONE".
  4. GULF SIDE OF BEACH FILL TOE VARIES BASED ON BATHYMETRY.
  5. CHANNEL ALIGNMENT ADJUSTMENTS FOR THE ACCESS CHANNEL FROM WE-9 THROUGH AC-33 SHALL BE SUBMITTED IN THE WORK PLAN FOR APPROVAL AND SHALL CONFORM TO TS-12 AND THE TYPICAL SECTION SHOWN ON SHEET 11.
  6. THE CONTRACTOR SHALL SUBMIT PROPOSED BEACH FILL CONTAINMENT METHODS FOR THE EASTERN END OF THE BEACH FILL TEMPLATE AND MARSH FILL TEMPLATE (P.I. CDN-12 TO P.I. CDN-17) WITH THE WORK PLAN

**LEGEND**

- SURVEY BASELINE STATION SEE SHEETS 25 - 29 FOR CROSS SECTIONS
- GAS PIPELINE
- GRID REFERENCE TICK LOUISIANA SOUTH ZONE, U.S. FOOT, NORTH AMERICAN DATUM 1983
- NO WORK ZONE
- POINT OF INTERSECTION SEE SHEETS B - 10 FOR COORDINATES

APPROVED BY: R.J.J.	FEDERAL PROJECT NUMBER: BA-35
CHECKED: M.T.P.	STATE PROJECT NUMBER: BA-35
SCALE: AS NOTED	
DESIGNED: T.M.A.	DRAWN: R.J.J./J.S.D.
DATE: OCT. 2007	SHEET: 11 OF 29

LOUISIANA DEPARTMENT OF NATURAL RESOURCES  
 PASS CHALAND TO GRAND BAYOU PASS  
 BARRIER SHORELINE RESTORATION (BA-35)  
 FILL AREA AND ACCESS CHANNEL

**SJB GROUP**  
 SJB LLC  
 P.O. BOX 1751  
 BAYTON ROUGE, LA 70242  
 PHONE (225) 769-3400  
 FAX (225) 769-3596

**COASTAL ENGINEERS INC.**  
 3106 SOUTH HORSESHOE DRIVE  
 NAPLES, FLORIDA 34104  
 PH: (239) 643-2324  
 FAX: (239) 643-1143

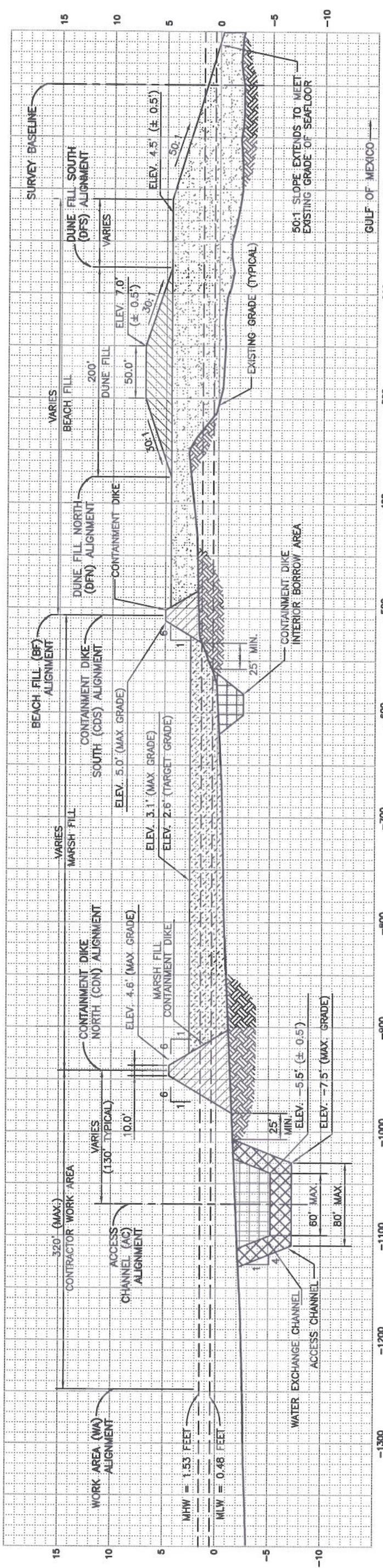

SCALES: HORIZONTAL: 1"=100'  
 VERTICAL: 1"=10'  
 ELEVATIONS ARE NAVD88 (GEOID99) FEET

**TYPICAL CROSS SECTION PERPENDICULAR TO SURVEY BASELINE**

- NOTES:
1. THE TYPICAL CROSS SECTION IS A COLLECTIVE REPRESENTATION OF PROJECT DESIGN FEATURES AND SPECIFICATIONS. THE CONTRACTOR SHALL REFER TO SPECIFIC CROSS SECTIONS ON SHEETS 25-29, FOR DEVIATIONS FROM THE TYPICAL CROSS SECTIONS.
  2. THE ACCESS CHANNEL SHALL BE PLUGGED TO ±0.5' OF PRE-CONSTRUCTION GRADE AND 50' LONG AT POST-CONSTRUCTION CHANNEL PLUG LOCATIONS (CENTERED AT STATIONS 120+00, 140+00, 160+00, AND 180+00). THE CONTRACTOR MAY STOCKPILE PLUG MATERIAL AT LOCATIONS APPROVED BY THE ENGINEER WITHIN THE WORK AREA.
  3. THE ACCESS CHANNEL SHALL HAVE A MAXIMUM BOTTOM CUT WIDTH OF 80' ALONG CHANNEL ALIGNMENT POINTS AC-1 TO AC-B. THE ACCESS CHANNEL SHALL HAVE A MAXIMUM BOTTOM CUT WIDTH OF 120' ALONG CHANNEL ALIGNMENT POINTS AC-8 TO AC-9. THE ACCESS CHANNEL SHALL HAVE A MAXIMUM BOTTOM CUT WIDTH OF 60' ALONG CHANNEL ALIGNMENT POINTS AC-9 TO WE-1. THE WATER EXCHANGE CHANNEL SHALL HAVE A MAXIMUM BOTTOM CUT WIDTH OF 60' ALONG CHANNEL ALIGNMENT POINTS WE-1 TO WE-9. THE ACCESS CHANNEL SHALL HAVE A MAXIMUM BOTTOM CUT WIDTH OF 80' ALONG CHANNEL ALIGNMENT POINTS WE-9 TO AC-33.
  4. OPTIONAL INTERIOR CONTAINMENT DIKES (ICD) MAY BE USED WITHIN THE MARSH FILL TEMPLATE. THE MAXIMUM ICD FILL ELEVATION SHALL BE NO HIGHER THAN THE MARSH FILL MAXIMUM OF 3.1' NAVD88 (GEOID99). THE LOCATIONS OF THE OPTIONAL ICD SHOULD BE INCLUDED IN THE WORK PLAN AND APPROVED BY THE ENGINEER.
  5. IF USED, ANY INTERIOR BORROW AREAS EXCAVATED TO CONSTRUCT THE CONTAINMENT DIKES SHALL BE LOCATED A MINIMUM OF 40' FROM THE TOE OF THE CONTAINMENT DIKE AND SHALL ADHERE TO ALL PIPELINE AVOIDANCE REQUIREMENTS SET FORTH IN GP-28 UTILITIES AND IMPROVEMENTS.
  6. CHANGES TO THE ACCESS CHANNEL SIDE SLOPES AND SIDE SLOPES FOR THE CDN AND CDS SHALL BE SUBMITTED IN THE WORK PLAN FOR APPROVAL AND SHALL CONFORM TO TS-11. THE WATER EXCHANGE CHANNEL DIMENSIONS SHALL NOT BE MODIFIED AS PER TS-12.5.2.

**STATE OF LOUISIANA**  
 PROFESSIONAL ENGINEER  
 T. MITCHELL ANDRUS  
 License No. 30246  
 CIVIL ENGINEERING

**STATE OF LOUISIANA**  
 CIVIL ENGINEERING  
 3/5/08

REFILL CHANNEL TO ±0.5' OF PRE-CONSTRUCTION GRADE PRIOR TO DE-MOBILIZATION

ACCESS CHANNEL ALIGNMENT

ACCESS CHANNEL

**TYPICAL CROSS SECTION POST-CONSTRUCTION CHANNEL PLUG**

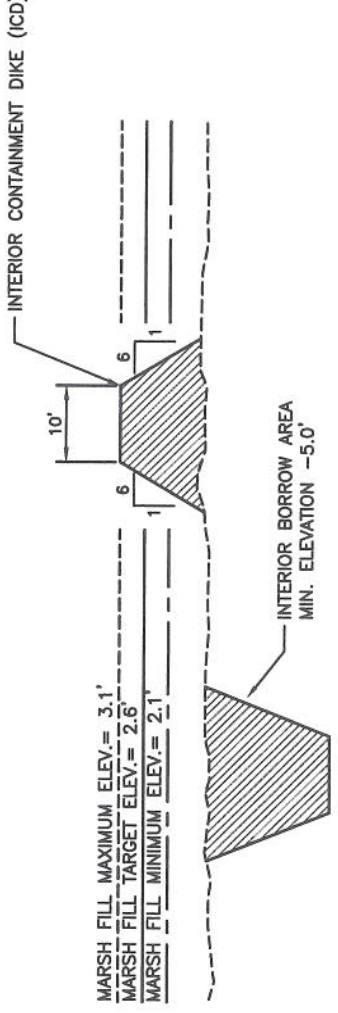

**TYPICAL CROSS SECTION OPTIONAL INTERIOR CONTAINMENT DIKE (ICD) MARSH FILL AREA**