

INDEX TO SHEETS

SHEET NO.	DESCRIPTION
1	TITLE SHEET
2 - 8	PLAN AND PROFILE SHEETS
9 - 13	CROSS SECTION SHEETS

STATE OF LOUISIANA
DEPARTMENT OF NATURAL RESOURCES
COASTAL ENGINEERING DIVISION

ASBUILT
RESTORATION OF THE CAMERON CREOLE WATERSHED LEVEE - PHASE I
CWPPRA PROJECT NO. CS-04A-L
CAMERON PARISH, LOUISIANA

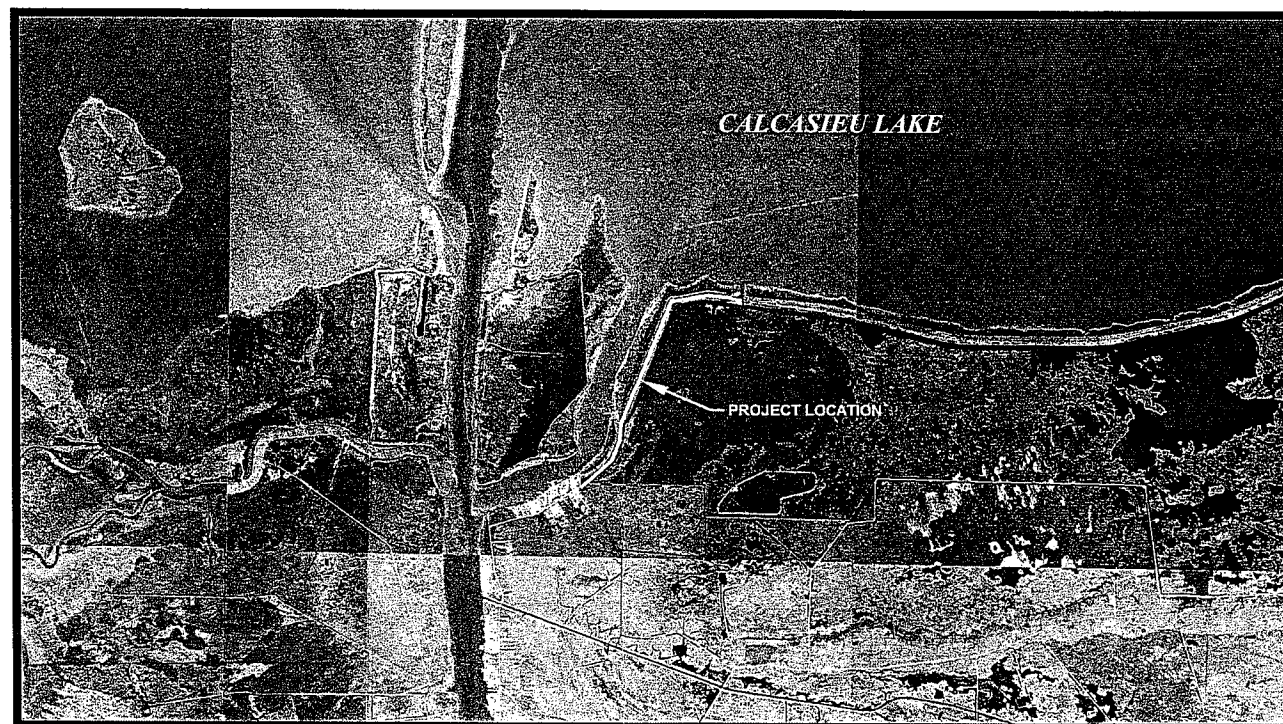

STATE PROJECT SPONSOR



FEDERAL PROJECT SPONSOR

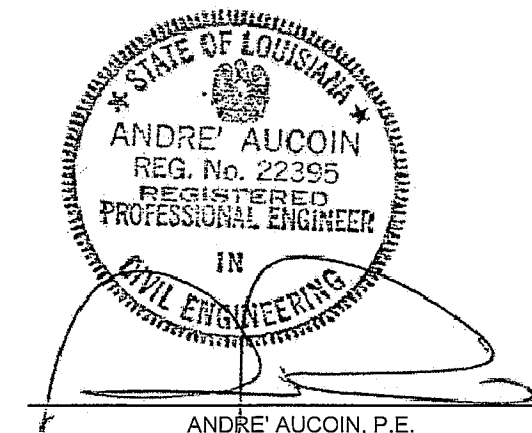

ANDRE' AUCOIN, P.E.

TYPE OF CONSTRUCTION
CLASSIFICATION III (HEAVY CONSTRUCTION)
CAMERON CREOLE WATERSHED PROJECT LEVEE RESTORATION

REV.	DATE	DESCRIPTION	BY

A E inc.
ACADIAN ENGINEERS
&
ENVIRONMENTAL CONSULTANTS INC.
1401 AMSTON ST.
EUNICE, LOUISIANA
337-357-1492

LOUISIANA DEPARTMENT OF NATURAL RESOURCES
COASTAL ENGINEERING DIVISION
617 NORTH 3RD STREET
BATON ROUGE, LOUISIANA 70802

DRAWN BY: LORI FUSELIER DESIGNED BY: ANDRE' AUCOIN

RESTORATION OF THE CAMERON CREOLE WATERSHED LEVEE - PHASE I
STATE PROJECT NUMBER: CS-04A-L
FEDERAL PROJECT NUMBER: N/A
APPROVED BY:

ASBUILT
TITLE SHEET

DATE: FEBRUARY 2010

SHEET 1 OF 13

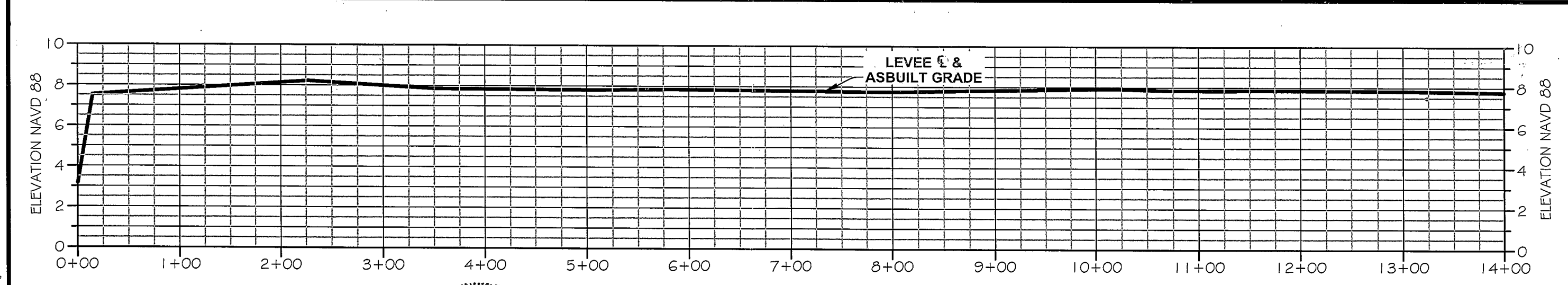
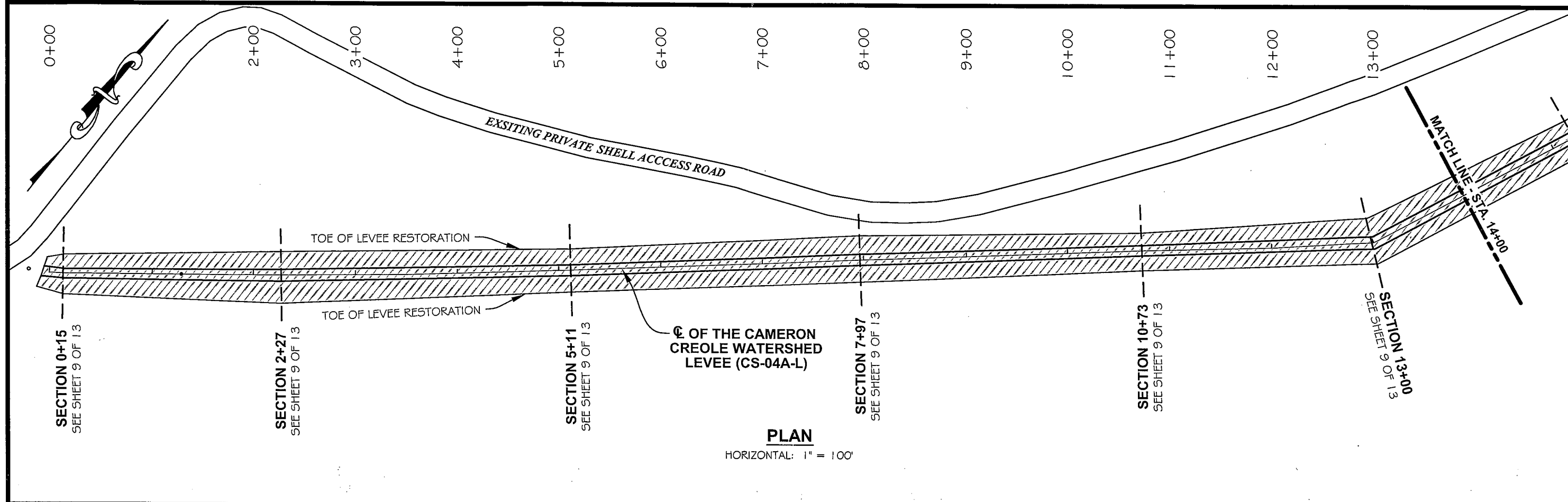

STATE OF LOUISIANA
 ANDRE' AUCOIN
 REG. No. 22395
 REGISTERED
 PROFESSIONAL ENGINEER
 IN
 CIVIL ENGINEERING

REV.	DATE	DESCRIPTION	BY

A E inc.
 ACADIAN ENGINEERS
 &
 ENVIRONMENTAL CONSULTANTS INC.
 1601 AMAZON ST.
 EUNICE, LOUISIANA
 337-457-1492

LOUISIANA DEPARTMENT OF NATURAL RESOURCES
 COASTAL ENGINEERING DIVISION
 617 NORTH 3RD STREET
 BATON ROUGE, LOUISIANA 70802

RESTORATION OF THE CAMERON CREOLE
 WATERSHED LEVEE - PHASE I
 STATE PROJECT NUMBER: CS-04A-L
 FEDERAL PROJECT NUMBER: N/A

ASBUILT
 CROSS SECTIONS
 DATE: FEBRUARY 2010
 SHEET 2 OF 13

G:\07-ac-23\Cad\Cad\Profile\Plan & Profile Sheets.dwg, 2/15/2010 8:28:30 AM

DRAWN BY: LORI FUSELIER DESIGNED BY: ANDRE' AUCOIN APPROVED BY:

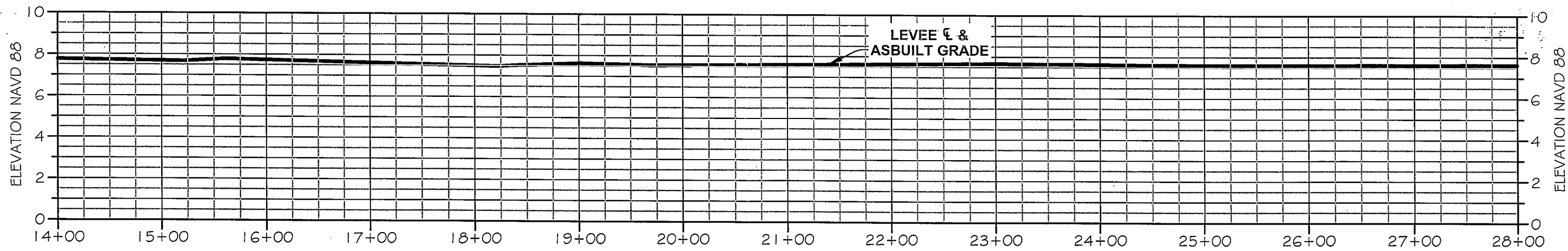
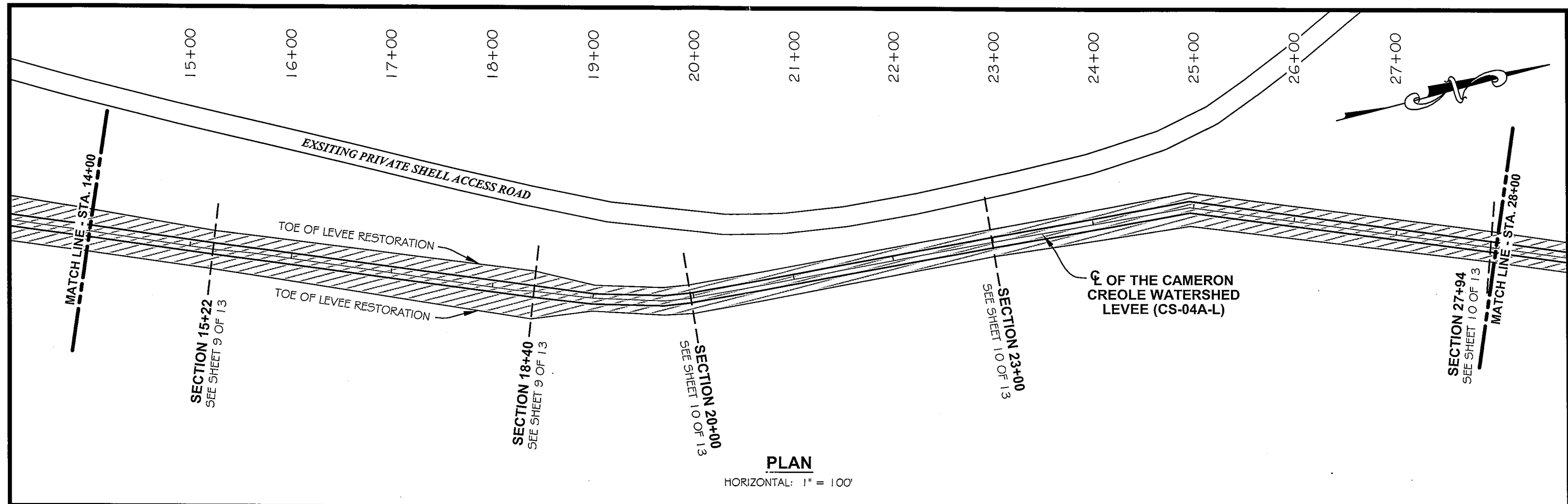

* STATE OF LOUISIANA *
 ANDRE' AUCOIN
 REG. No. 22395
 REGISTERED
 PROFESSIONAL ENGINEER
 IN
 CIVIL ENGINEERING

REV.	DATE	DESCRIPTION	BY

A
E inc.
 ACADIAN ENGINEERS
 &
 ENVIRONMENTAL CONSULTANTS INC.
 1801 AMAZON ST.
 EUNICE, LOUISIANA
 337-457-1492

LOUISIANA DEPARTMENT OF NATURAL RESOURCES
 COASTAL ENGINEERING DIVISION
 617 NORTH 3RD STREET
 BATON ROUGE, LOUISIANA 70802

RESTORATION OF THE CAMERON CREOLE
 WATERSHED LEVEE - PHASE I

ASBUILT
 CROSS SECTIONS

DRAWN BY: LORI FUSELIER

DESIGNED BY: ANDRE' AUCOIN

APPROVED BY:

DATE: FEBRUARY 2010

SHEET 3 OF 13

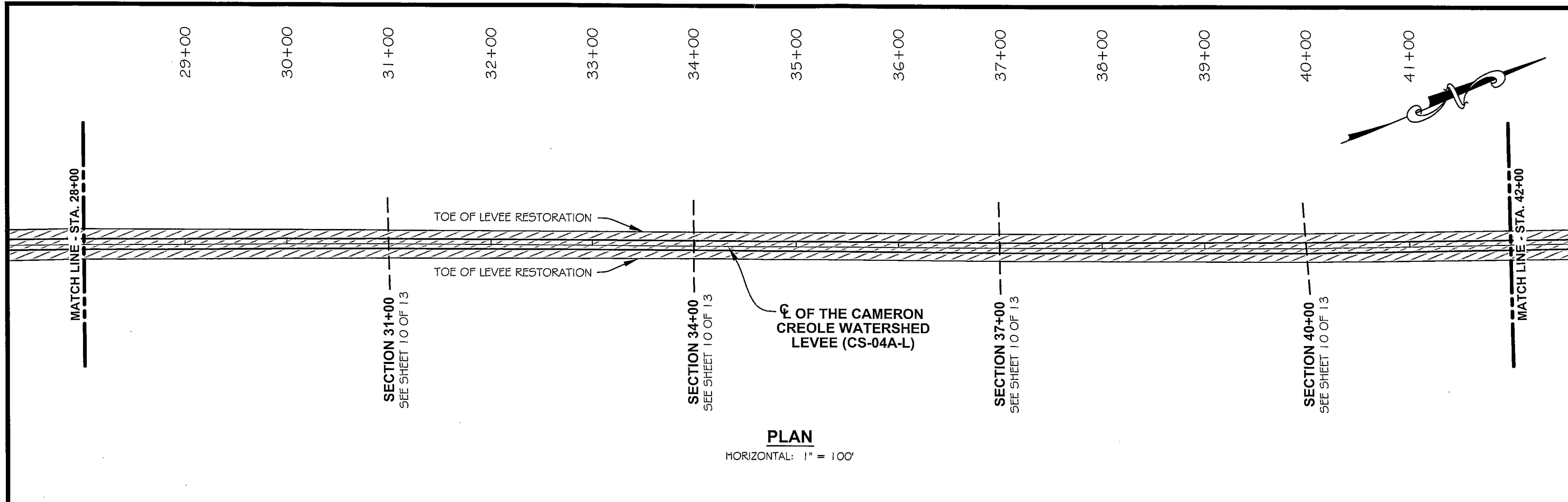

PLAN
HORIZONTAL: 1" = 100'

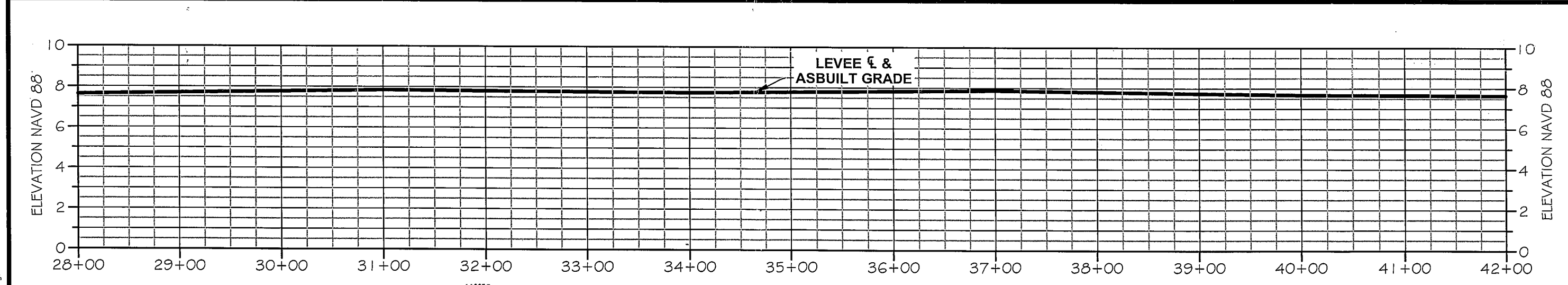

PROFILE
HORIZONTAL: 1" = 100'
VERTICAL: 1" = 5'

* STATE OF LOUISIANA *
 ANDRE' AUCOIN
 REG. No. 22395
 REGISTERED
 PROFESSIONAL ENGINEER
 IN
 CIVIL ENGINEERING

REV.	DATE	DESCRIPTION	BY

A
E inc.
 ACADIAN ENGINEERS
 ENVIRONMENTAL CONSULTANTS INC.
 1601 AMAZON ST.
 EUNICE, LOUISIANA
 337-457-1492

LOUISIANA DEPARTMENT OF NATURAL RESOURCES
 COASTAL ENGINEERING DIVISION
 617 NORTH 3RD STREET
 BATON ROUGE, LOUISIANA 70802

RESTORATION OF THE CAMERON CREOLE
 WATERSHED LEVEE - PHASE I
 STATE PROJECT NUMBER: CS-04A-L
 FEDERAL PROJECT NUMBER: N/A

ASBUILT
 CROSS SECTIONS
 DATE: FEBRUARY 2010
 SHEET 4 OF 13

G:\07-se-23\Gacael\EaglePoint\Plan & Profile Sheets.dwg, 2/15/2010 8:49:58 AM

DRAWN BY: LORI FUSELIER

DESIGNED BY: ANDRE' AUCOIN

APPROVED BY:

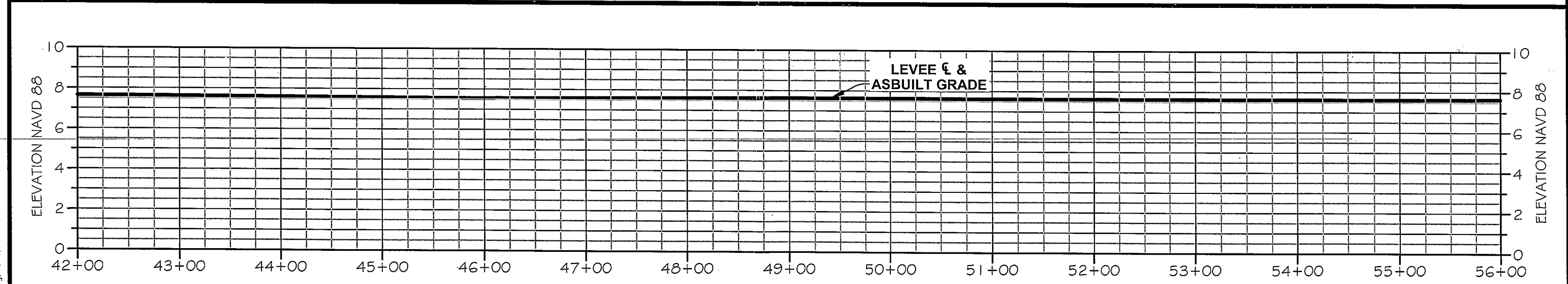
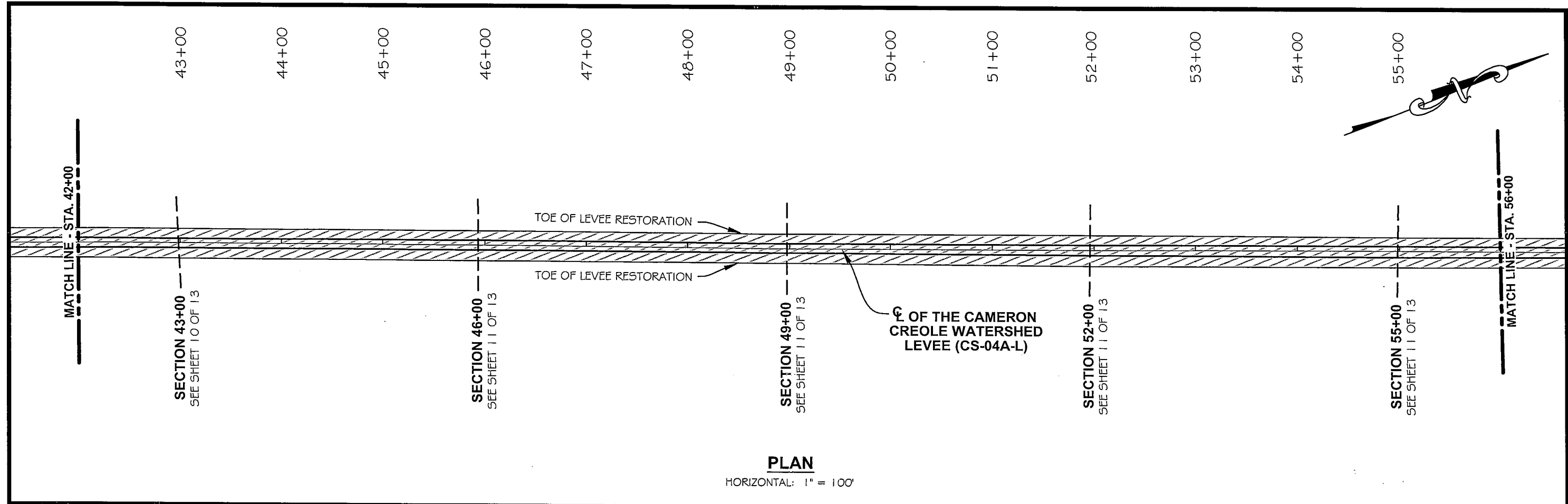

STATE OF LOUISIANA
 ANDRE' AUCOIN
 REG. No. 22395
 REGISTERED
 PROFESSIONAL ENGINEER
 IN
 CIVIL ENGINEERING

REV.	DATE	DESCRIPTION	BY

AE inc.
 ACADIAN ENGINEERS
 &
 ENVIRONMENTAL CONSULTANTS INC.
 1681 AMAZON ST.
 EUNICE, LOUISIANA
 70532-1492

LOUISIANA DEPARTMENT OF NATURAL RESOURCES
 COASTAL ENGINEERING DIVISION
 617 NORTH 3RD STREET
 BATON ROUGE, LOUISIANA 70802

RESTORATION OF THE CAMERON CREOLE
 WATERSHED LEVEE - PHASE I
 STATE PROJECT NUMBER: CS-04A-L
 FEDERAL PROJECT NUMBER: N/A

ASBUILT
 CROSS SECTIONS
 DATE: FEBRUARY 2010
 SHEET 5 OF 13

G:\07-ac-23\Gis\cad\EaglePoint\Plan & Profile Sheets.dwg, 2/15/2010 8:50:02 AM

DRAWN BY: LORI FUSELIER

DESIGNED BY: ANDRE' AUCOIN

APPROVED BY:

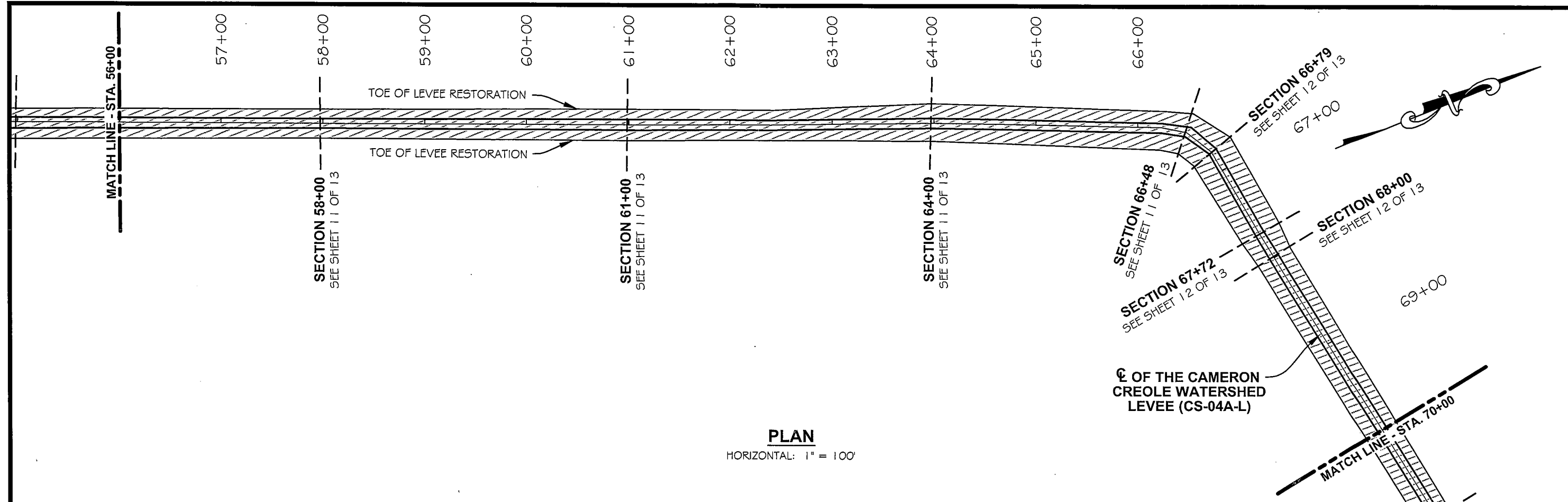

PLAN
HORIZONTAL: 1" = 100'

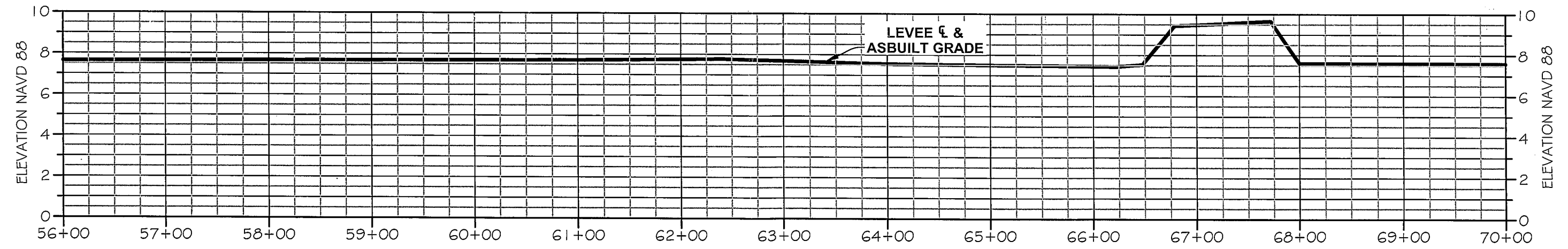

PROFILE
HORIZONTAL: 1" = 100'
VERTICAL: 1" = 5'

* STATE OF LOUISIANA *
 ANDRE' AUCOIN
 REG. No. 22395
 REGISTERED
 PROFESSIONAL ENGINEER
 IN
 CIVIL ENGINEERING

REV	DATE	DESCRIPTION	BY

AE inc.
 ACADIAN ENGINEERS
 ENVIRONMENTAL CONSULTANTS INC.
 1601 AMAZON ST.
 EUNICE, LOUISIANA
 337-437-1492

LOUISIANA DEPARTMENT OF NATURAL RESOURCES
 COASTAL ENGINEERING DIVISION
 617 NORTH 3RD STREET
 BATON ROUGE, LOUISIANA 70802
 DRAWN BY: LORI FUSELIER DESIGNED BY: ANDRE' AUCOIN

RESTORATION OF THE CAMERON CREOLE
 WATERSHED LEVEE - PHASE I
 STATE PROJECT NUMBER: CS-04A-L
 FEDERAL PROJECT NUMBER: N/A
 APPROVED BY:

ASBUILT
 CROSS SECTIONS
 DATE: FEBRUARY 2010
 SHEET 6 OF 13

G:\07-ae-230\acaa\l\eggl\PointPlan & Profile Sheets.dwg, 2/15/2010 8:50:24 AM

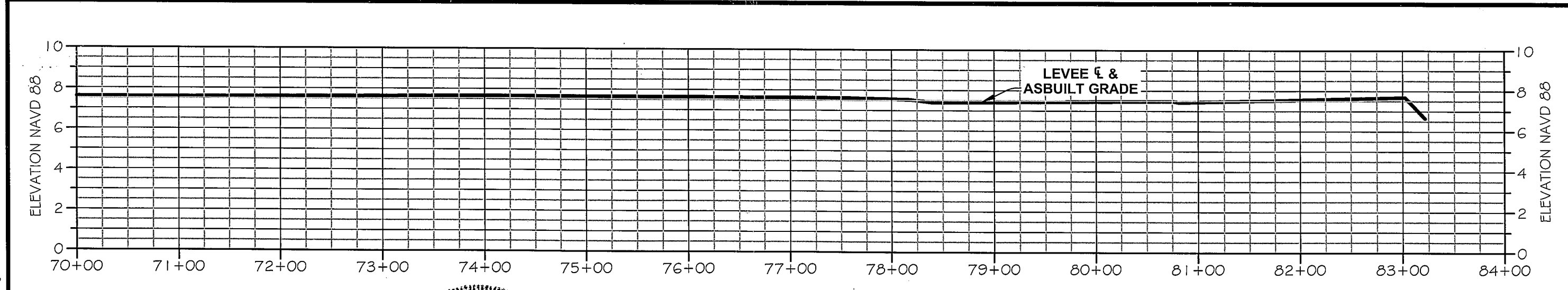
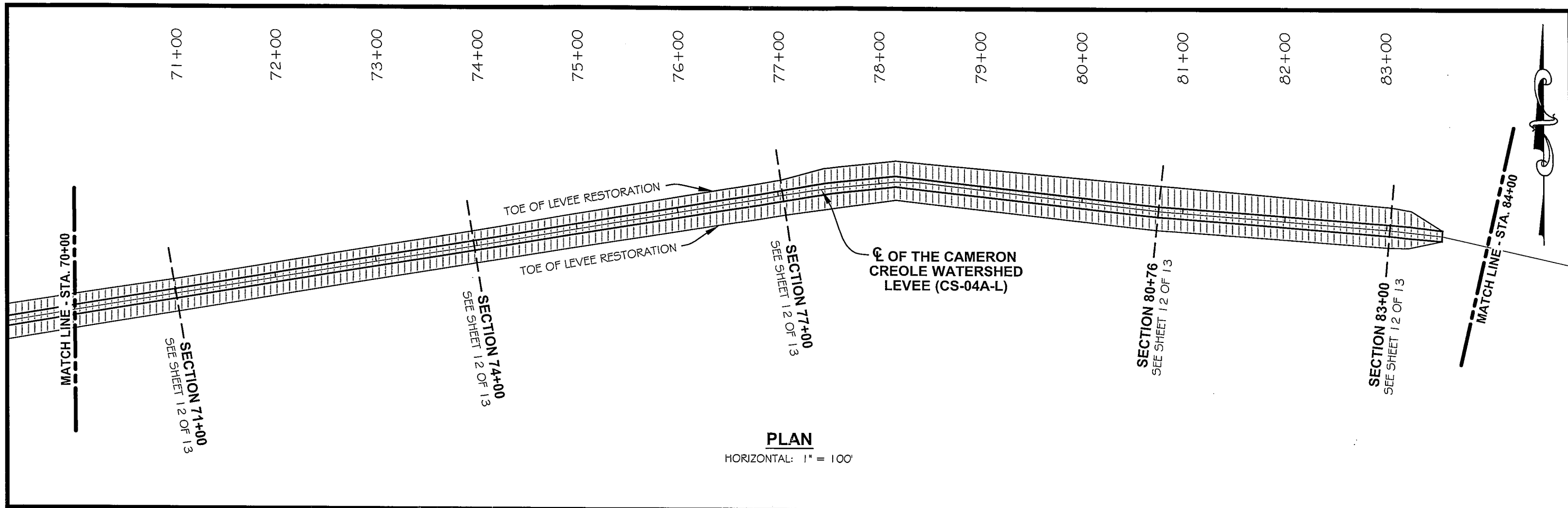

STATE OF LOUISIANA
 ANDRE' AUCOIN
 REG. No. 22395
 REGISTERED
 PROFESSIONAL ENGINEER
 IN
 CIVIL ENGINEERING

REV.	DATE	DESCRIPTION	BY

A E inc.
 ACADIAN ENGINEERS
 &
 ENVIRONMENTAL CONSULTANTS INC.
 1891 AMAZON ST.
 EUNICE, LOUISIANA
 337-457-4492

LOUISIANA DEPARTMENT OF NATURAL RESOURCES
 COASTAL ENGINEERING DIVISION
 617 NORTH 3RD STREET
 BATON ROUGE, LOUISIANA 70802

RESTORATION OF THE CAMERON CREOLE
 WATERSHED LEVEE - PHASE I
 STATE PROJECT NUMBER: CS-04A-L
 FEDERAL PROJECT NUMBER: N/A

ASBUILT
 CROSS SECTIONS
 DATE: FEBRUARY 2010
 SHEET 7 OF 13

G:\07-ac-23\Gacad\EaglePoint\Plan & Profile Sheets.dwg, 2/15/2010 8:50:48 AM

DRAWN BY: LORI FUSELIER DESIGNED BY: ANDRE' AUCOIN

APPROVED BY:

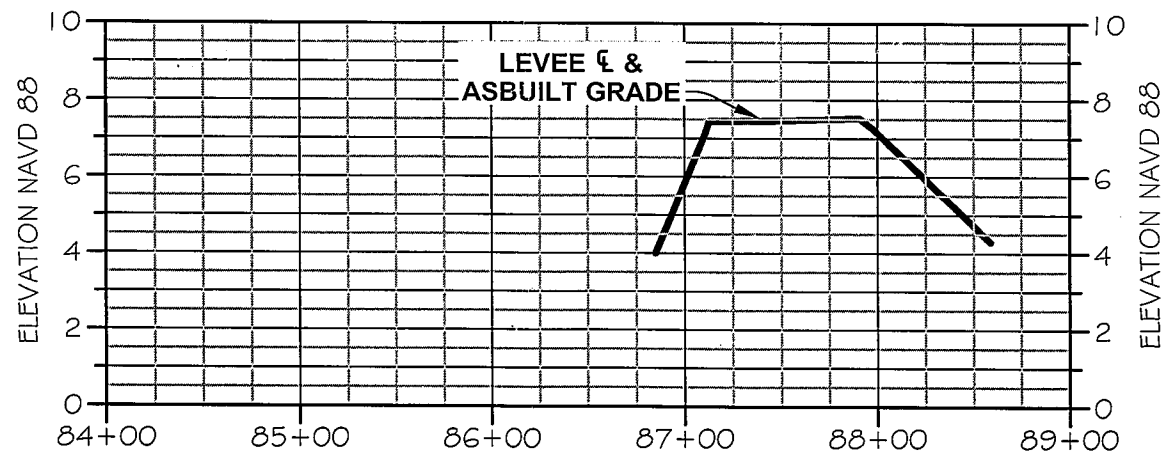
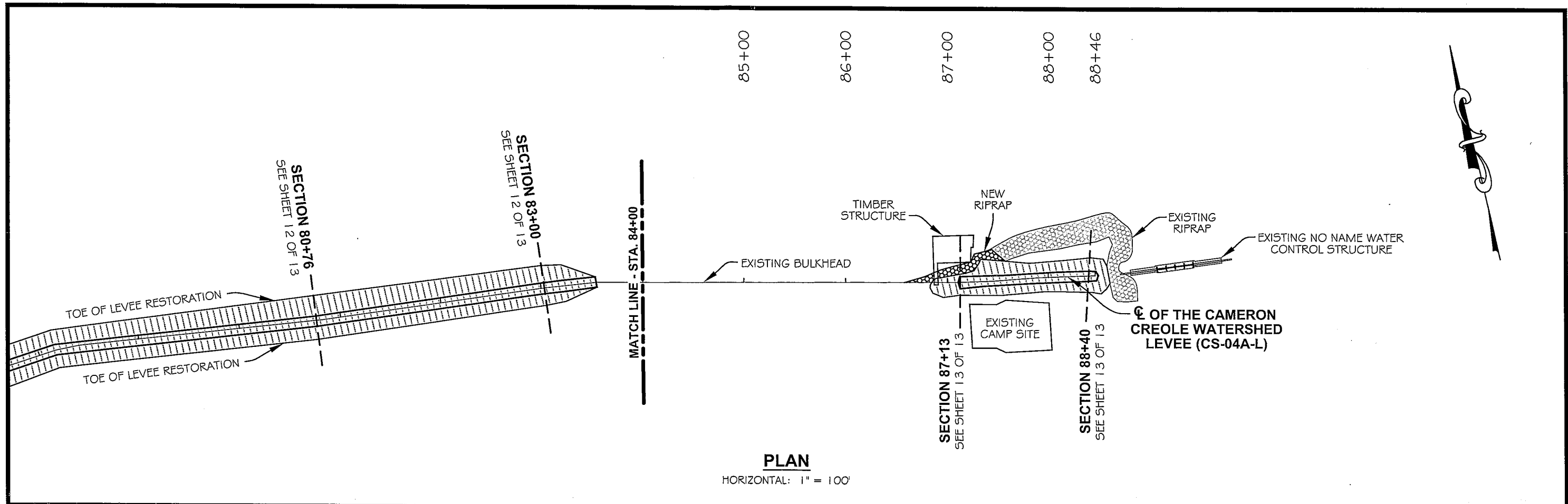

PROFILE
HORIZONTAL: 1" = 100'
VERTICAL: 1" = 5'

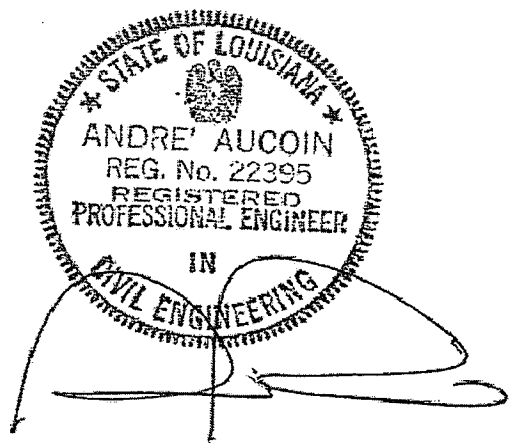

G:\07-ae-23\acad\Cad\Font\Plan & Profile Sheets.dwg, 2/15/2010 8:51:08 AM

		LOUISIANA DEPARTMENT OF NATURAL RESOURCES COASTAL ENGINEERING DIVISION 617 NORTH 3RD STREET BATON ROUGE, LOUISIANA 70802	RESTORATION OF THE CAMERON CREOLE WATERSHED LEVEE - PHASE I STATE PROJECT NUMBER: CS-04A-L FEDERAL PROJECT NUMBER: N/A	ASBUILT CROSS SECTIONS DATE: FEBRUARY 2010 SHEET 8 OF 13
REV. DATE	DESCRIPTION	BY	DRAWN BY: LORI FUSELIER DESIGNED BY: ANDRE' AUCOIN	APPROVED BY:

G:\07_ae-23\Gacad\EagleFont\Cross Section Sheets.dwg, 2/15/20 10:24:36 AM

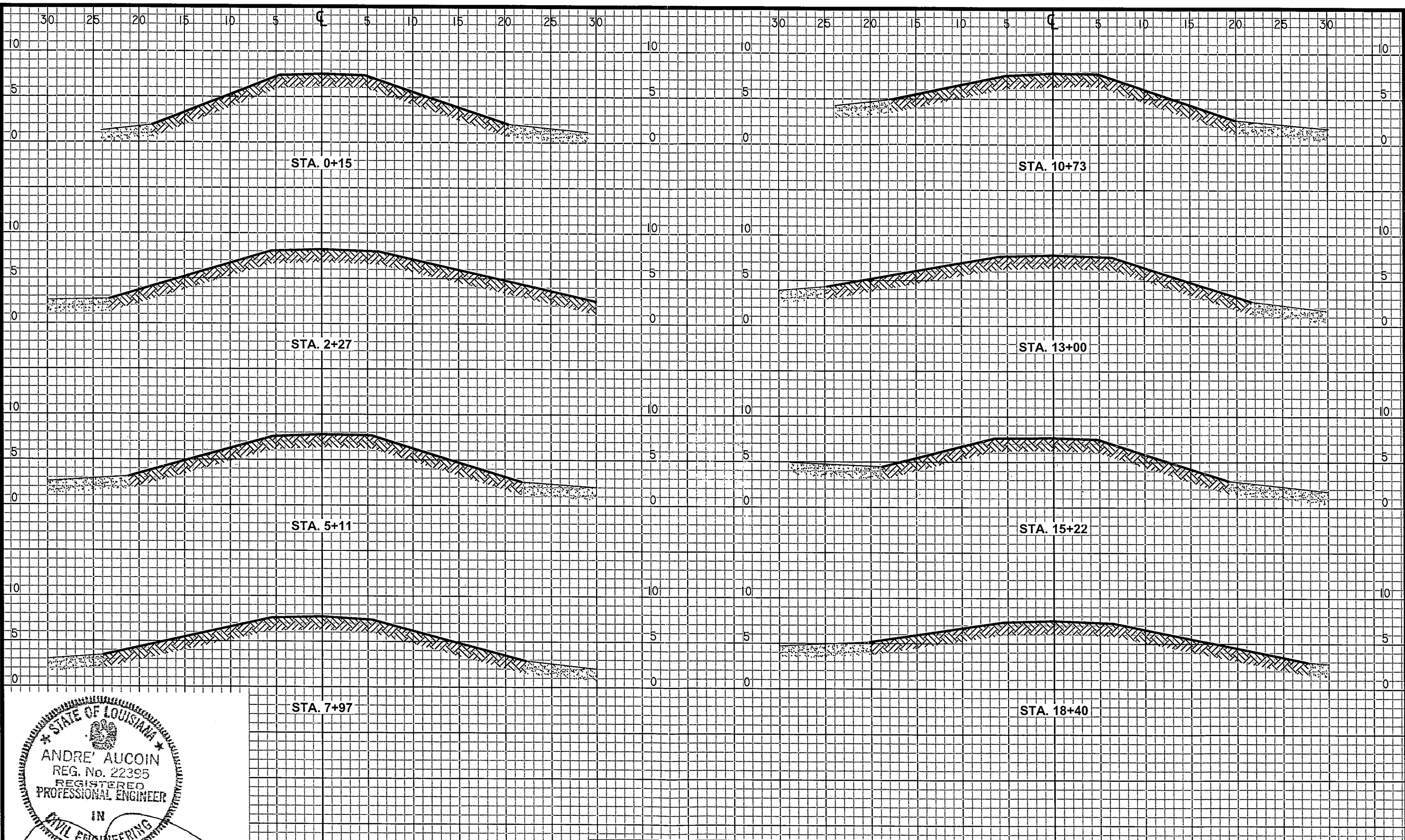

HORIZONTAL: 1" = 10'
 VERTICAL: 1" = 10'

REV.	DATE	DESCRIPTION	BY

A E inc.
 ACADIAN ENGINEERS
 ENVIRONMENTAL CONSULTANTS INC.
 1601 AMAZON ST.
 BUNICE, LOUISIANA
 337-457-1492

LOUISIANA DEPARTMENT OF NATURAL RESOURCES
 COASTAL ENGINEERING DIVISION
 617 NORTH 3RD STREET
 BATON ROUGE, LOUISIANA 70802

RESTORATION OF THE CAMERON CREOLE
 WATERSHED LEVEE - PHASE I
 STATE PROJECT NUMBER: CS-04A-L
 FEDERAL PROJECT NUMBER: N/A
 APPROVED BY:

ASBUILT
 CROSS SECTIONS
 DATE: FEBRUARY 2010
 SHEET 9 OF 13

DRAWN BY: LORI FUSELIER DESIGNED BY: ANDRE' AUCOIN

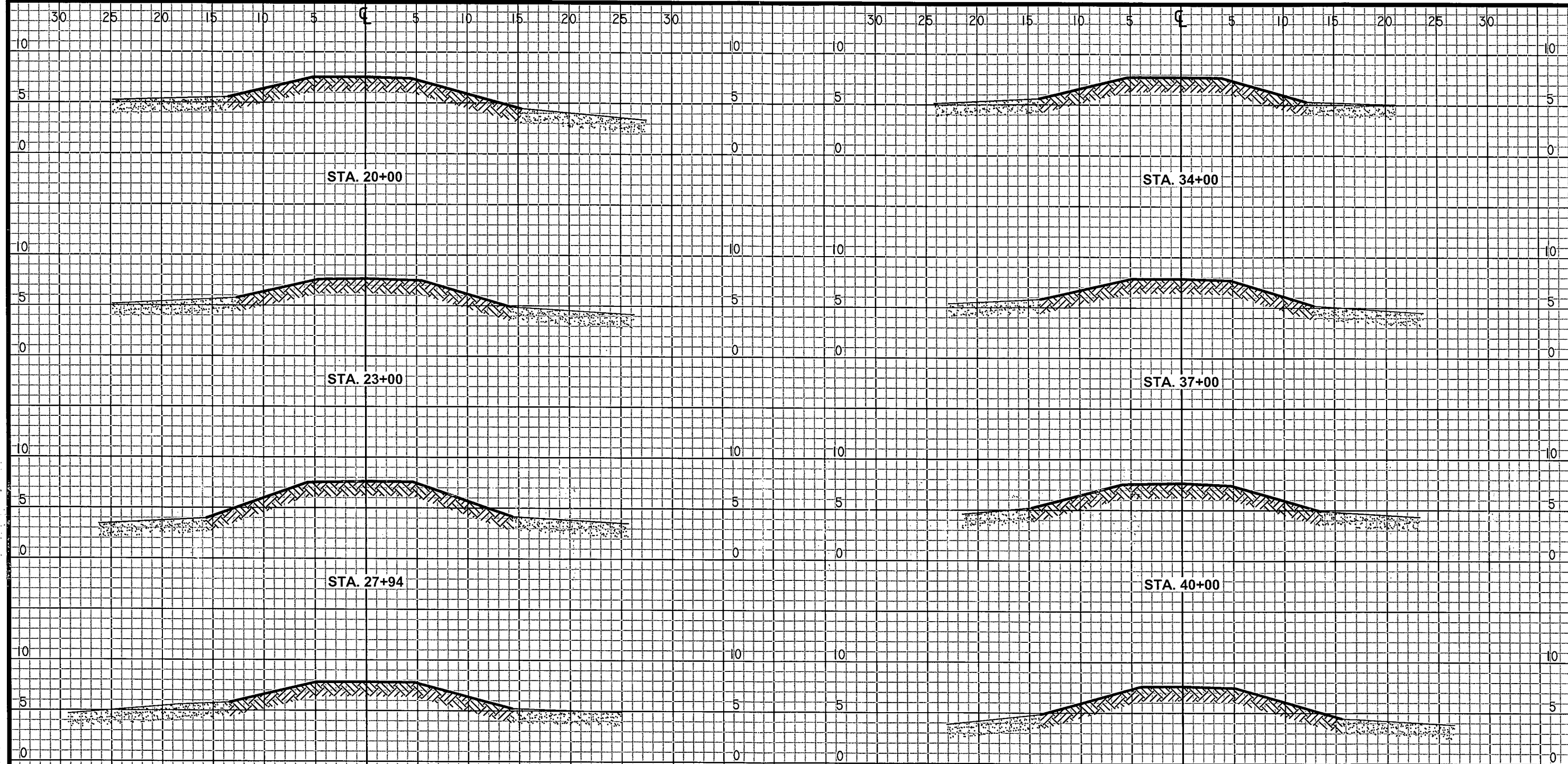

G:\07-ae-23\Gacad\Levee\Font\Cross Section Sheets.dwg, 2/15/2010 9:24:57 AM

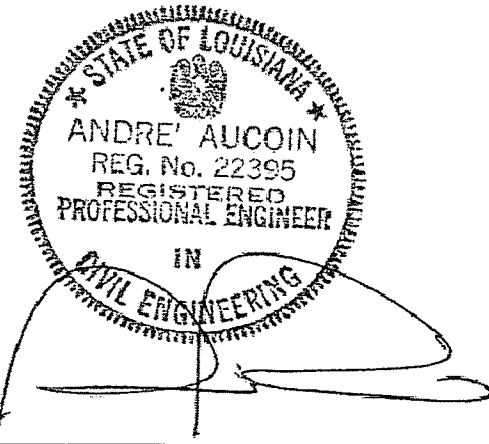

STA. 31+00

HORIZONTAL: 1" = 10'
VERTICAL: 1" = 10'

REV	DATE	DESCRIPTION	BY

A E inc.
ACADIAN ENGINEERS
ENVIRONMENTAL CONSULTANTS INC.
1801 AMAZON ST.
EUNICE, LOUISIANA
337-457-1492

LOUISIANA DEPARTMENT OF NATURAL RESOURCES
COASTAL ENGINEERING DIVISION
617 NORTH 3RD STREET
BATON ROUGE, LOUISIANA 70802

RESTORATION OF THE CAMERON CREOLE
WATERSHED LEVEE - PHASE I
STATE PROJECT NUMBER: CS-04A-L
FEDERAL PROJECT NUMBER: N/A
APPROVED BY:

ASBULT
CROSS SECTIONS
DATE: FEBRUARY 2010
SHEET 10 OF 13

DRAWN BY: LORJ FUSELIER DESIGNED BY: ANDRE' AUCOIN

G:\07-ac-23\Gacad\EagleFont\Cross Section Sheets.dwg, 2/15/2010 9:25:17 AM

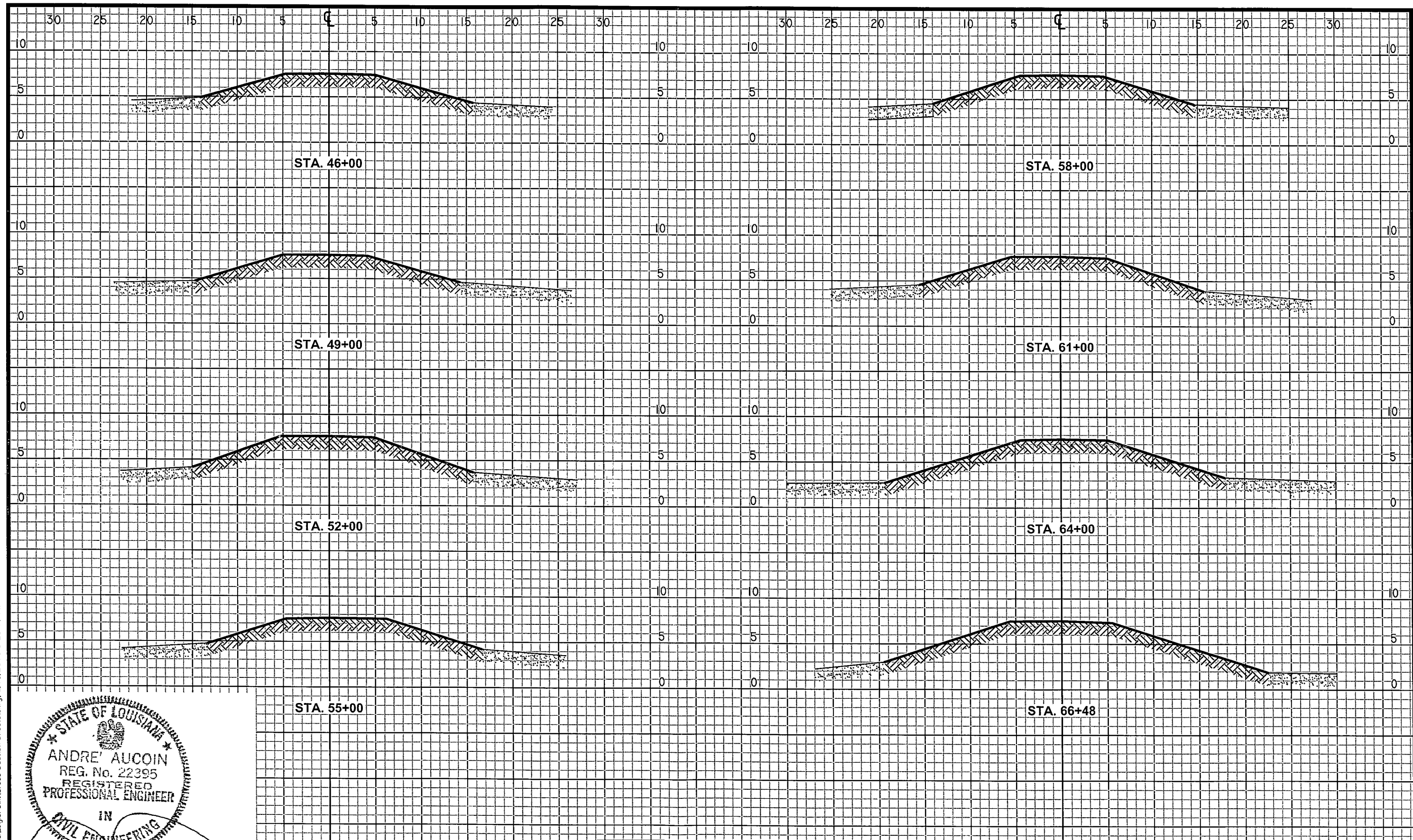

HORIZONTAL: 1" = 10'
 VERTICAL: 1" = 10'

REV	DATE	DESCRIPTION	BY

A
E inc.
 ACADIAN ENGINEERS
 ENVIRONMENTAL CONSULTANTS INC.
 1501 AMAZON ST.
 EUNICE, LOUISIANA
 337-457-1492

LOUISIANA DEPARTMENT OF NATURAL RESOURCES
 COASTAL ENGINEERING DIVISION
 617 NORTH 3RD STREET
 BATON ROUGE, LOUISIANA 70802

RESTORATION OF THE CAMERON CREOLE
 WATERSHED LEVEE - PHASE I
 STATE PROJECT NUMBER: CS-04A-L
 FEDERAL PROJECT NUMBER: N/A
 APPROVED BY:

ASBUILT
 CROSS SECTIONS
 DATE: FEBRUARY 2010
 SHEET 11 OF 13

DRAWN BY: LORI FUSELIER DESIGNED BY: ANDRE' AUCOIN

G:\107-ae-23\Gacaci\EaglePoint\Cross Section Sheets.dwg, 2/15/2010 9:25:42 AM

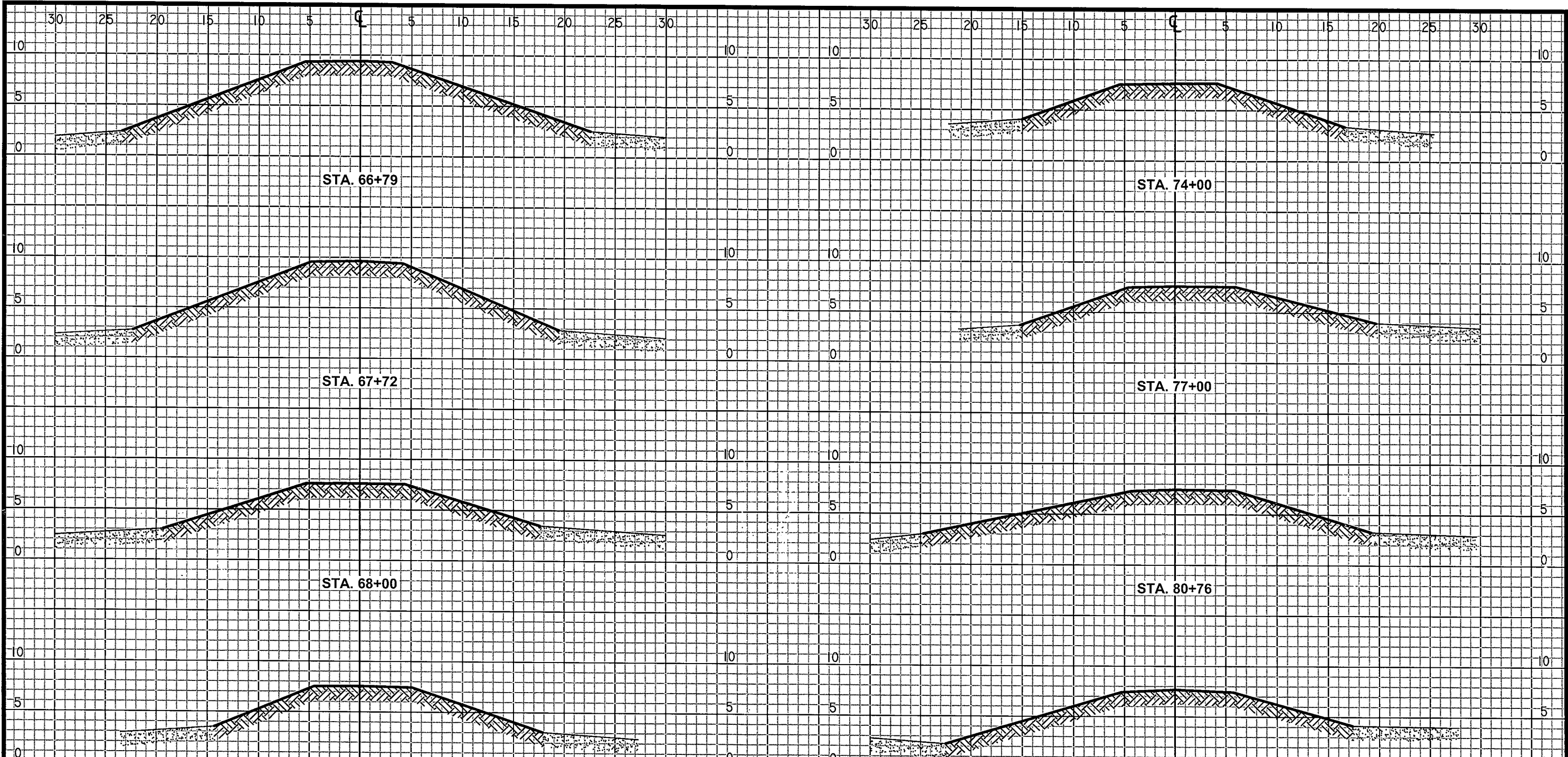

STATE OF LOUISIANA
 ANDRE' AUCOIN
 REG. No. 22395
 REGISTERED
 PROFESSIONAL ENGINEER
 IN
 CIVIL ENGINEERING

HORIZONTAL: 1" = 10'
 VERTICAL: 1" = 10'

REV.	DATE	DESCRIPTION	BY

A E inc.
 ACADIAN ENGINEERS
 ENVIRONMENTAL CONSULTANTS INC.
 1001 AMAZON ST.
 EUNICE, LOUISIANA
 337-457-1492

LOUISIANA DEPARTMENT OF NATURAL RESOURCES
 COASTAL ENGINEERING DIVISION
 617 NORTH 3RD STREET
 BATON ROUGE, LOUISIANA 70802

RESTORATION OF THE CAMERON CREOLE
 WATERSHED LEVEE - PHASE I
 STATE PROJECT NUMBER: CS-04A-L
 FEDERAL PROJECT NUMBER: N/A
 APPROVED BY:

ASBULT
 CROSS SECTIONS
 DATE: FEBRUARY 2010
 SHEET 12 OF 13

DRAWN BY: LORI FUSELIER DESIGNED BY: ANDRE' AUCOIN